

Copyright and ownership of this drawing is vested in EFT, Euro Facade Systems Ltd, whose prior written consent is required for its use, reproduction or for publication to any third party. All other rights reserved. Subject to modifications.

6

Fabrication  
Comar 6EFT

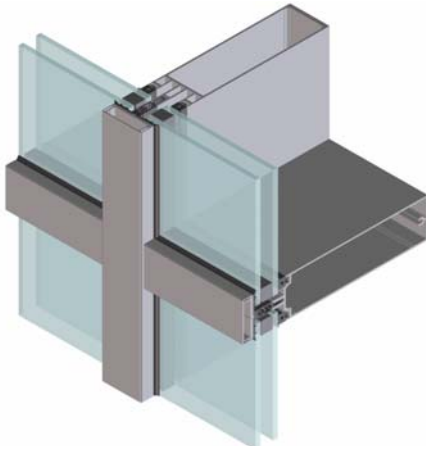

Capped

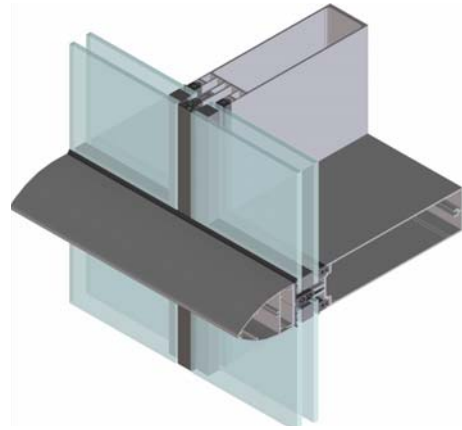

2sided SGH

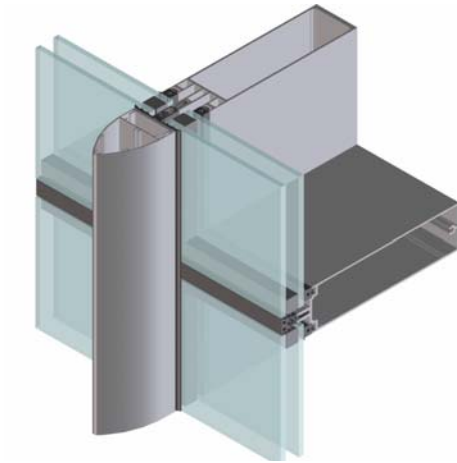

2sided SGV

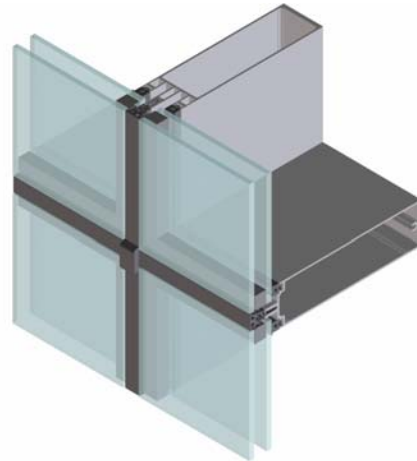

4sided SG

Fabricators Guide

Changes reserved  
Sous reserve de modifications  
Änderungen vorbehalten

Issue: 05  
Date: 10-16

# Fabrication

6

## Comar 6EFT

### Exploded typical detail Fully capped

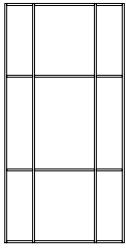

6.00

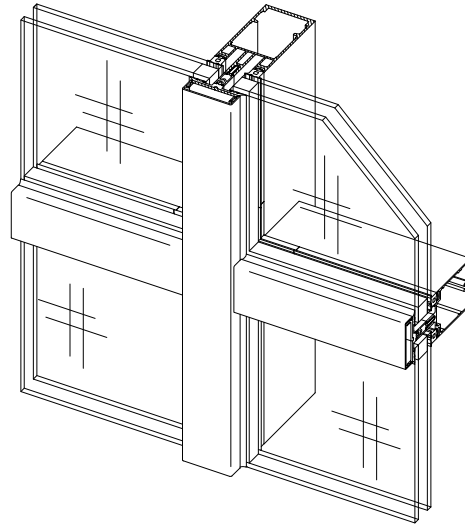
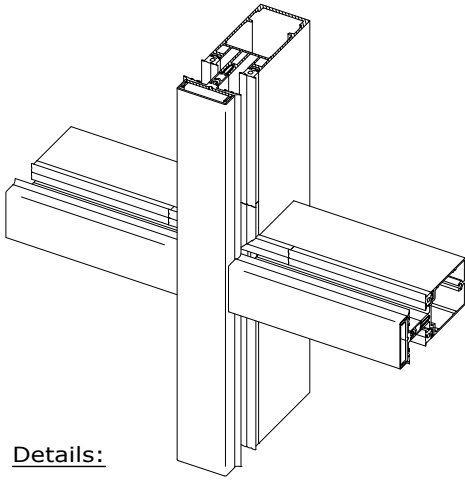

Details:

1. One substructure for all curtain wall types (Fully Capped / 2sided SGH / 2sided SGV / 4sided SG)
2. Controlled drainage system (mullion drained) - drainage diverter
3. Thermal break
4. Mullion-Transom step-cut & sealed by EPDM moulding
5. Ladder (unit) construction or stick build
6. Moulded EPDM corners available
7. Mullion / Transom pressure plate gasket
8. Pressure plate
9. Mullion cover cap
10. Transom cover cap

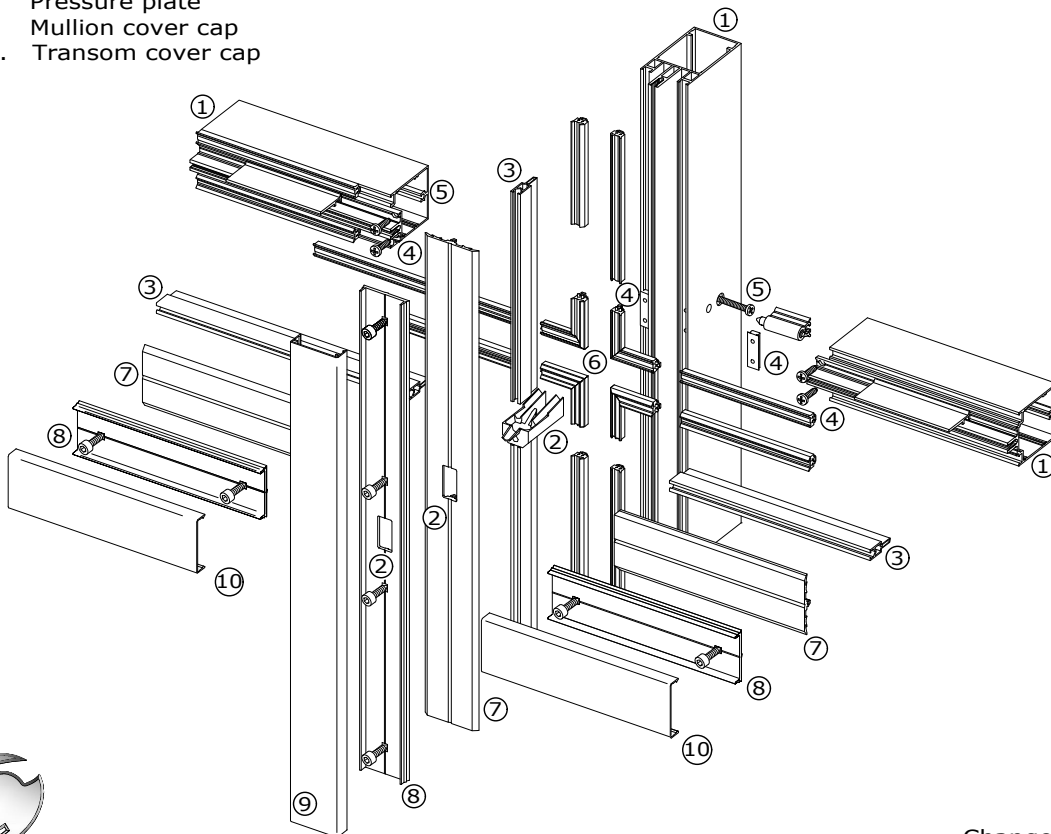

Copyright and ownership of this drawing is vested in EFT, Euro Facade Systems Ltd, whose prior written consent is required for its use, reproduction or for publication to any third party. All other rights reserved. Subject to modifications.

Fabricators Guide



**comar**  
ARCHITECTURAL ALUMINIUM SYSTEMS

Changes reserved  
Sous reserve de modifications  
Änderungen vorbehalten

Issue: 05  
Date : 10-16

## Exploded typical details Horizontal cover cap (2sided SGH)

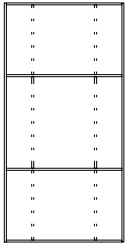

6.01

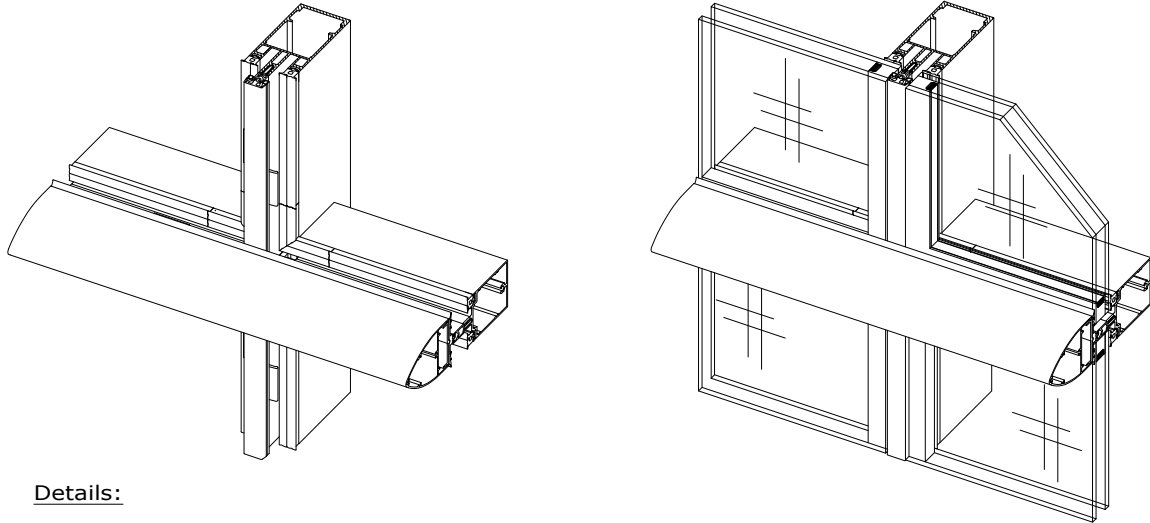

### Details:

1. One substructure for all curtain wall types (Fully Capped / 2sided SGH / 2sided SGV / 4sided SG)
2. Controlled drainage system (mullion drained) - drainage diverter
3. Thermal break
4. Mullion-Transom step-cut & sealed by EPDM moulding.
5. Ladder (unit) construction or stick build
6. Moulded EPDM corners available
7. Transom pressure plate gasket
8. Transom pressure plate
9. Mullion joint gasket
10. Transom cover cap
11. Mullion clamping system

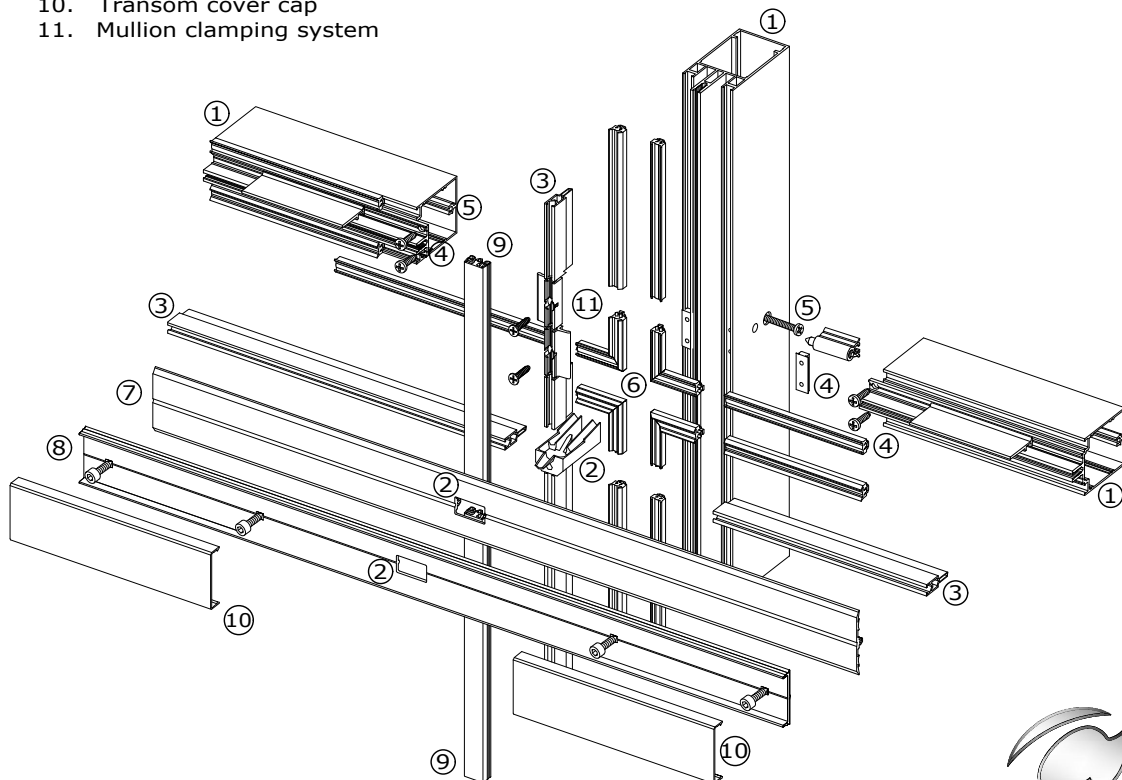

Changes reserved  
Sous reserve de modifications  
Änderungen vorbehalten

Issue: 05  
Date: 10-16

# Fabrication

# 6

## Comar 6EFT

## Exploded typical detail Vertical cover cap (2Sided SGV)

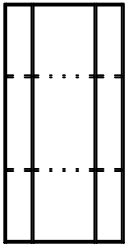

6.02

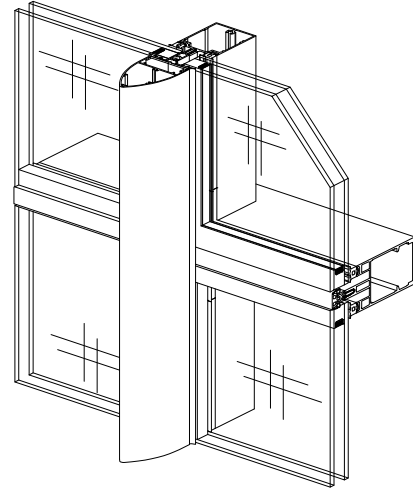
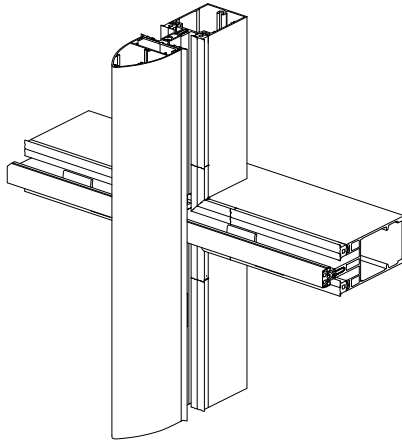

### Details:

1. One substructure for all curtain wall types, Fully Capped, 2sided SGH, 2sided SGV & 4sided SG.
2. Controlled drainage system (mullion drained) drainage diverter
3. Thermally broken.
4. Mullion-Transom step-cut & sealed by EPDM moulding.
5. Ladder (unit) construction or stick build.
6. Moulded EPDM corners available.
7. Continuous pressure plate gasket.
8. Glazing clamping system into DG unit.
9. Continuous pressure plate gasket.
10. Glass setting Block

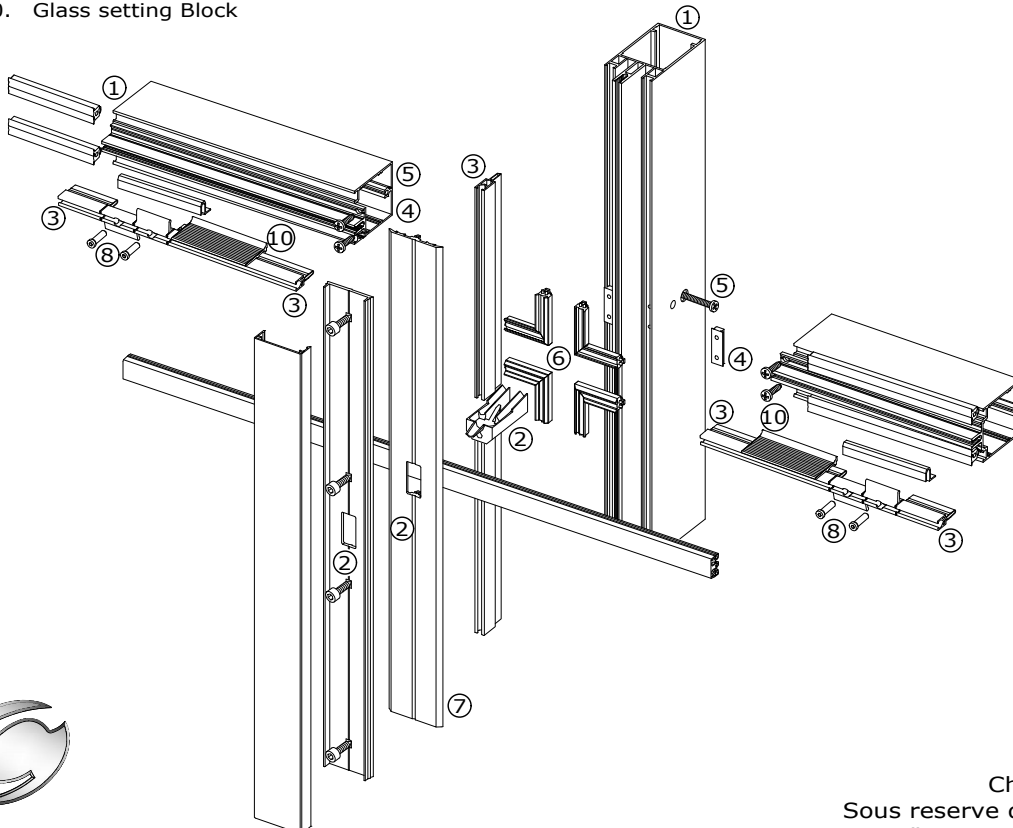

Copyright and ownership of this drawing is vested in EFT, Euro Facade Systems Ltd, whose prior written consent is required for its use, reproduction or for publication to any third party. All other rights reserved. Subject to modifications.

## Exploded typical details Four sided structural EFT (4sided SG)

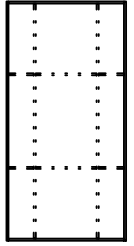

6.03

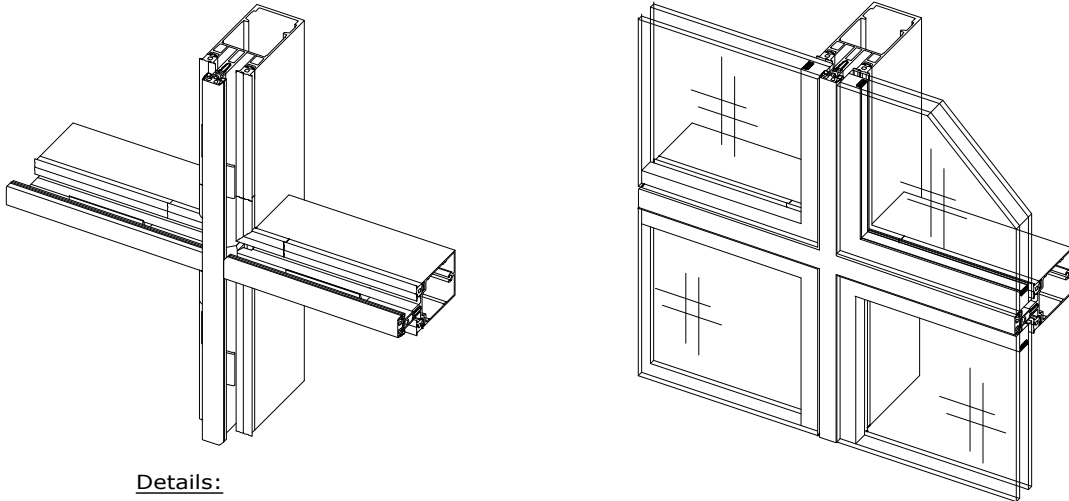

### Details:

1. One substructure for all curtain wall types, Fully Capped, 2sided SGH, 2sided SGV & 4sided SG.
2. Controlled drainage system (mullion drained) drainage diverter/cover
3. Thermally broken.
4. Mullion-Transom step-cut & sealed by EPDM gasket.
5. Ladder (unit) construction or stick build.
6. Moulded EPDM corners available.
7. Joint cruciform gasket.
8. Glazing clamping system into DG unit.
9. Glass setting block

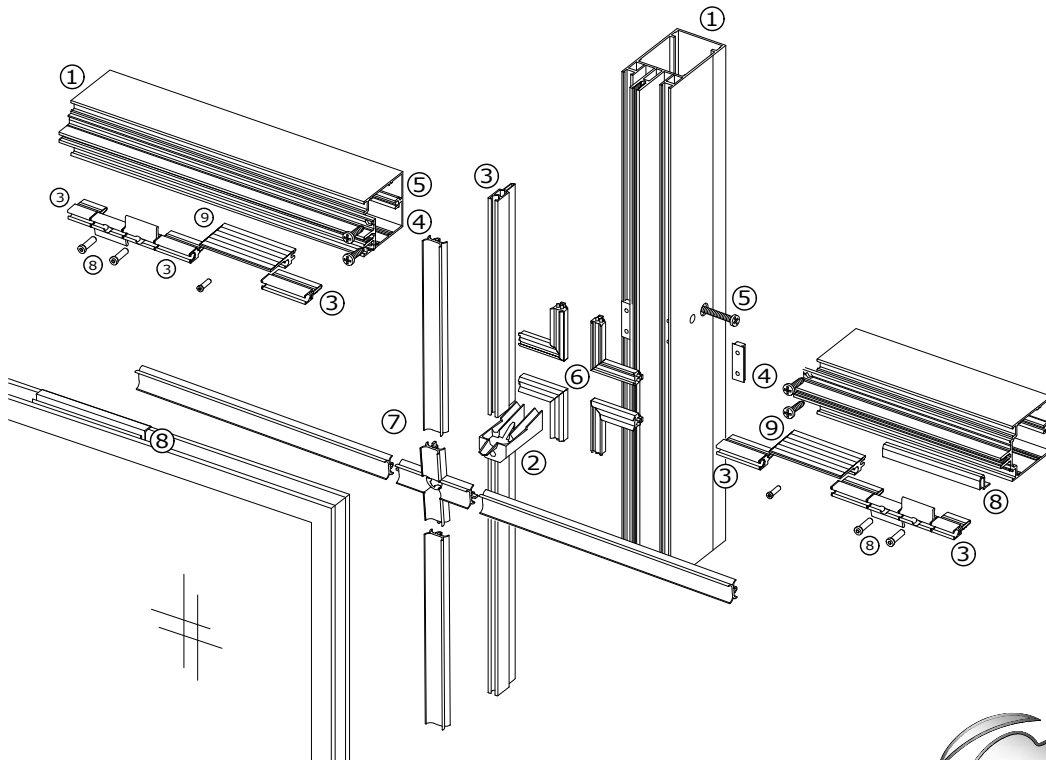

Changes reserved  
Sous reserve de modifications  
Änderungen vorbehalten

Issue: 05  
Date: 10-16

# Fabrication

# 6

## Comar 6EFT

## Mullion - Transom Connection

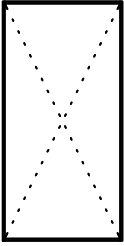

6.04

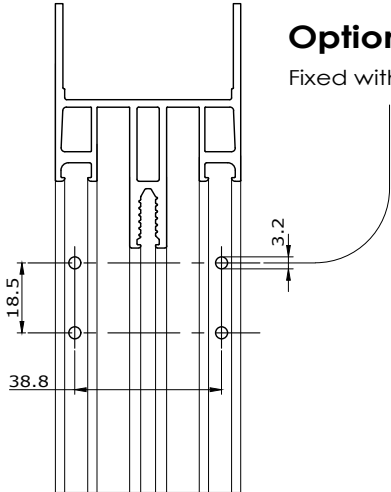

### Option 1 (for 45mm Transoms only)

Fixed with 2 screws EFT 3021 (3.9x16)

Glass weight: max. 100 kg

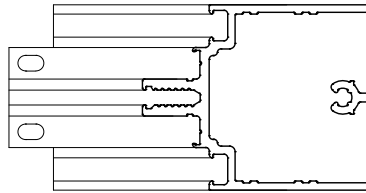

Fabricators Guide

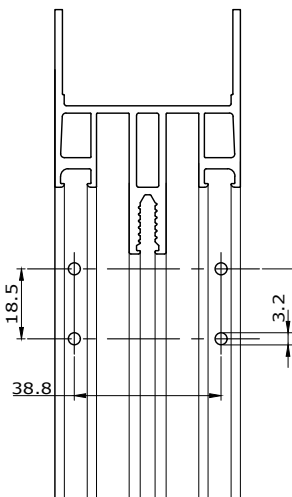

### Option 2 (for 60mm or deeper Transoms)

Fixed with 2 screws EFT 3021 (3.9x16) +  
Transom spigot EFT 2310 or  
Ladder screw 3022 (4.8x60)

Glass weight: max. 150 kg

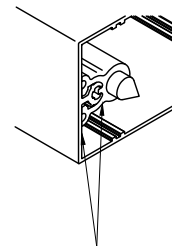
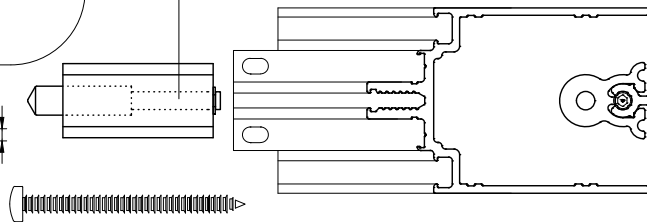

Transom cleat  
2310 body to be  
positioned flush  
to prepared  
edge of transom  
and super glued

Copyright and ownership of this drawing is vested in EFT,  
Euro Facade Systems Ltd, whose prior written consent is required  
for its use, reproduction or for publication to any third party.  
All other rights reserved. Subject to modifications.



**comar**

ARCHITECTURAL ALUMINIUM SYSTEMS

Changes reserved  
Sous reserve de modifications  
Änderungen vorbehalten

Issue: 05  
Date : 10-16

Copyright and ownership of this drawing is vested in EFT, Euro Facade Systems Ltd, whose prior written consent is required for its use, reproduction or for publication to any third party. All other rights reserved. Subject to modifications.

# 6

## Fabrication

### Comar 6EFT

#### Mullion - Transom Connection

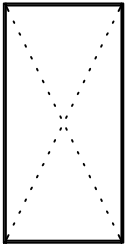

#### Option: 3

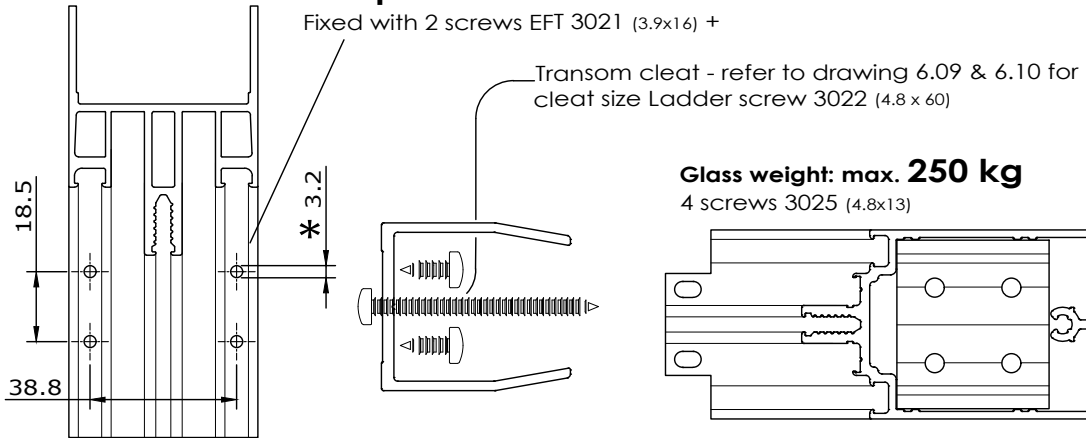

6.05

\* For ladder unit only, 3022 (4.8 x 60)

#### Option: 4

**For direct fix to steel or timber details refer to drawing 6.09**

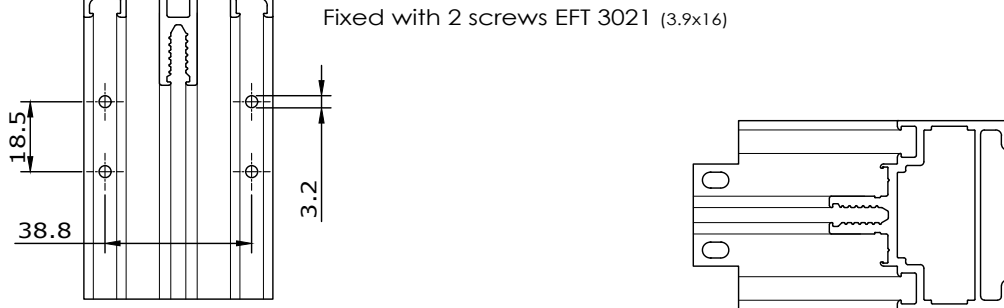

#### Option: 5

**Glass weight: max 450 kg**

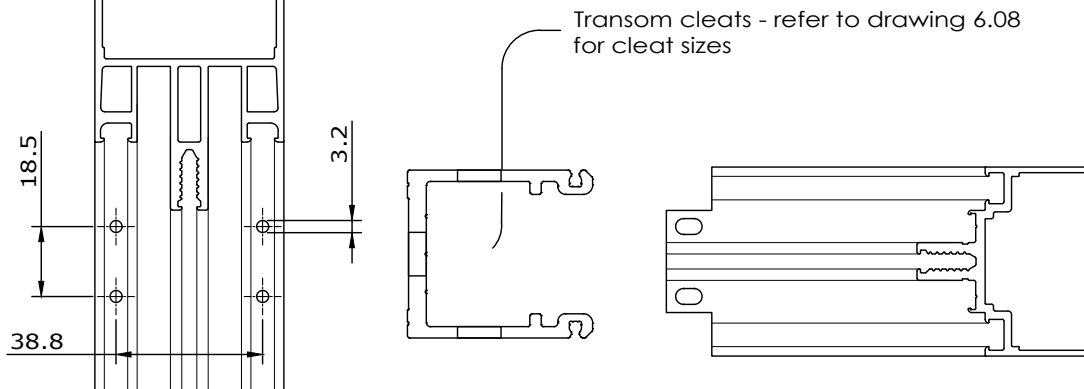

Fabricators Guide

Changes reserved  
Sous reserve de modifications  
Änderungen vorbehalten

Issue: 05  
Date: 10-16

# Fabrication

# 6

## Comar 6EFT

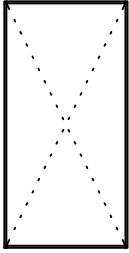

## Heavy glass support Jamb detail

6.06

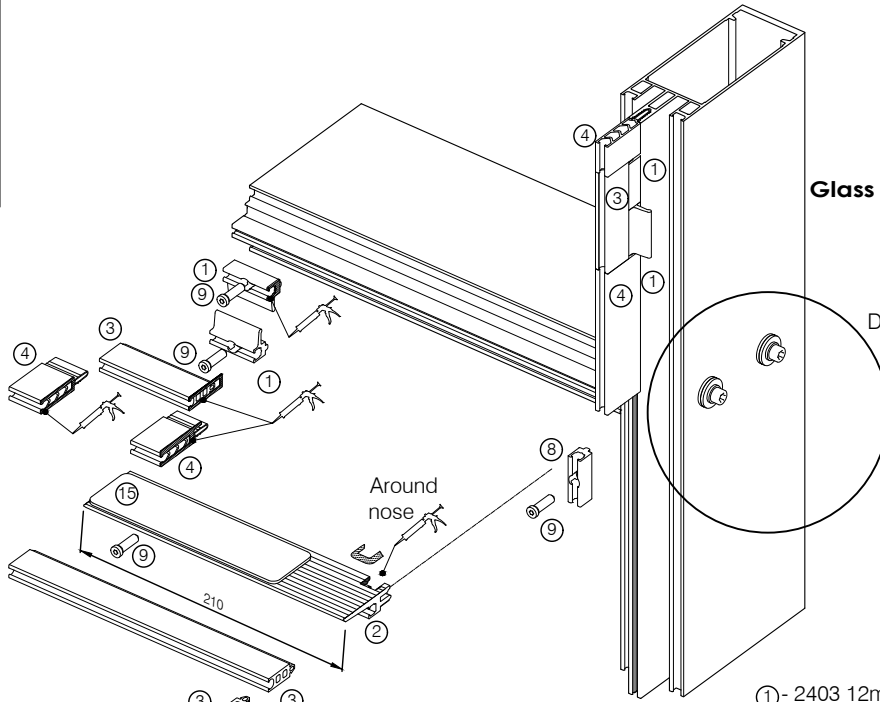

**Option: 5**  
**Glass weight: Max 450 kg**

Detail A

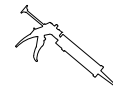

APPLY SEALANT  
TO ALL JOINTS

- ①- 2403 12mm double glazing clamp
- ②- 140x series 12mm glass setting block
- ③- 2155 22mm extension gasket
- ④- 2203 34mm thermal break
- ⑤- 1305 transom cleat
- ⑥- 1891 11x3 59.5mm aluminium tube
- ⑦- 1890 11x3 50mm aluminium tube
- ⑧- 2409 setting block support
- ⑨- 3029 5.5x23mm special screw
- ⑩- 3004 5.5x19mm socket screw
- ⑪- 3095 M6 DIN9021SS washer
- ⑫- 3017 5.5x16 countersink screw
- ⑬- 3094 SS countersink washer
- ⑭- 3021 3.9x16 special screw
- ⑮- 150mm wide glass shims
- ⑯- M12 SS washers by Others

Detail A

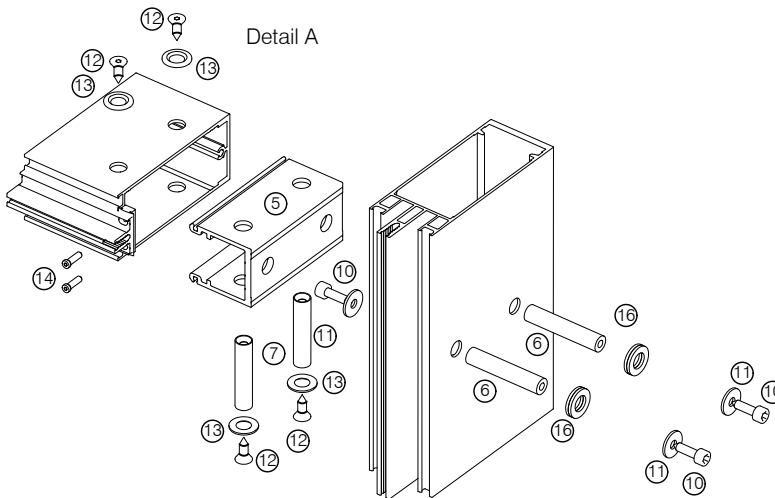

Fabricators Guide

Copyright and ownership of this drawing is vested in EFT, Euro Facade Systems Ltd, whose prior written consent is required for its use, reproduction or for publication to any third party. All other rights reserved. Subject to modifications.



**comar**  
ARCHITECTURAL ALUMINIUM SYSTEMS

Changes reserved  
Sous reserve de modifications  
Änderungen vorbehalten

Issue: 05  
Date : 04-17



## Heavy glass support Mullion Detail

Copyright and ownership of this drawing is vested in EFT, Euro Facade Systems Ltd, whose prior written consent is required for its use, reproduction or for publication to any third party. All other rights reserved. Subject to modifications.

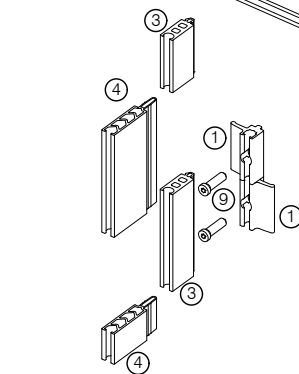
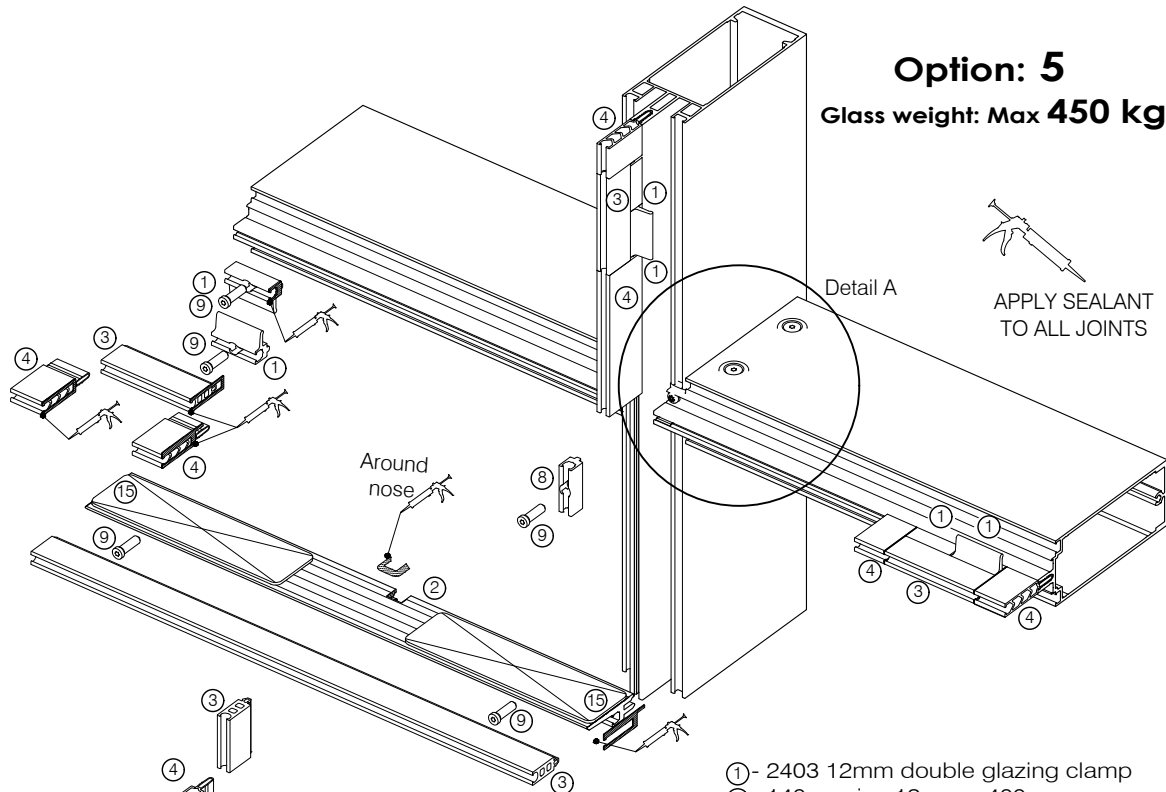

- ①- 2403 12mm double glazing clamp
- ②- 140x series 12mm x 400mm glass setting block
- ③- 2155 22mm extension gasket
- ④- 2203 34mm thermal break
- ⑤- 1305 transom cleat
- ⑥- 1891 11x3 59.5mm aluminium tube
- ⑦- 1890 11x3 50mm aluminium tube
- ⑧- 2409 setting block support
- ⑨- 3029 5.5x23mm special screw
- ⑩- 3004 5.5x19mm socked screw
- ⑪- 3095 M6 SS DIN9021washer
- ⑫- 3017 5.5x16 countersink screw
- ⑬- 3094 SS countersink washer
- ⑭- 3021 3.9x16 special screw
- ⑮- 150mm wide glass shims

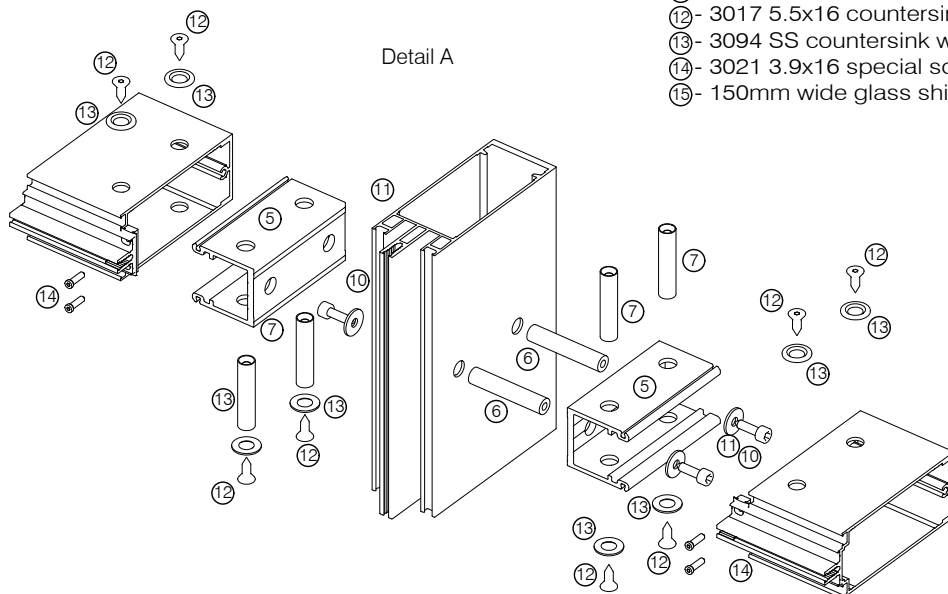

Changes reserved  
Sous reserve de modifications  
Änderungen vorbehalten

Issue: 05  
Date: 10-16



# Installation

# 6

## Comar 6EFT

## Mullion - Transom Connection

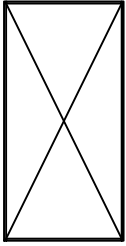

6.08

**Option: 5**

Glass weight max **450 kg**

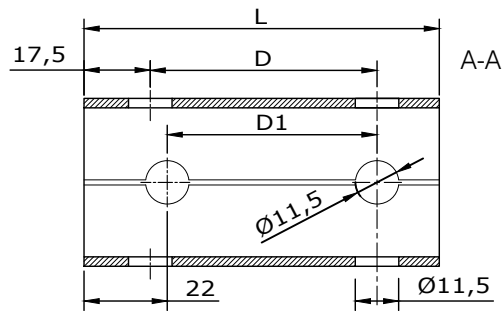
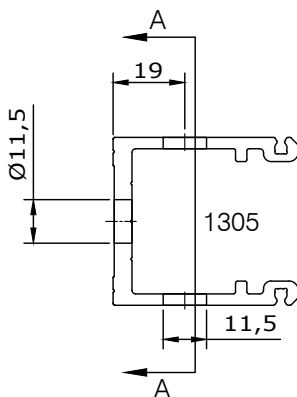
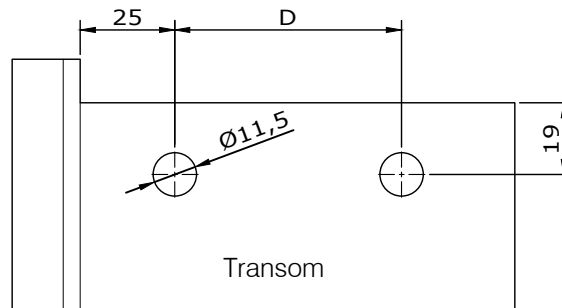
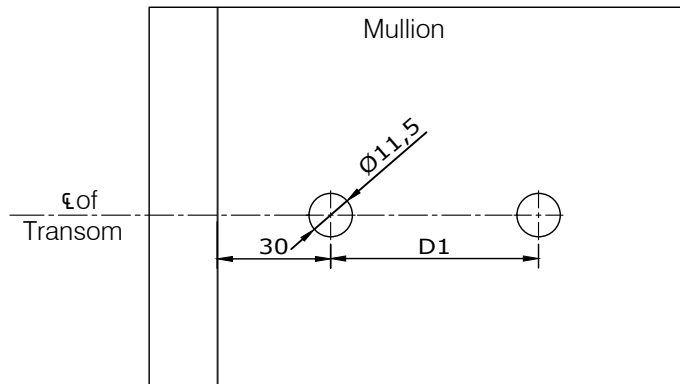

Fabricators Guide

Note:  
Cut cleats are for project only and are not held in stock. Cut cleats will be subject to a longer lead time.

Cleat Reference	Transom	L (mm)	D (mm)	D1(mm)
2566	1152 - 135mm	114	75	70
2567	1145 & 1154 -150mm	129	100	95
2568	1147 - 175mm	154	125	120
2569	1156 - 180mm	159	130	125
2570	1157 - 195mm	174	145	140
2571	1148 - 200mm	179	145	140
2572	1158 - 210mm	189	160	156

Copyright and ownership of this drawing is vested in EFT, Euro Facade Systems Ltd, whose prior written consent is required for its use, reproduction or for publication to any third party. All other rights reserved. Subject to modifications.



**comar**  
ARCHITECTURAL ALUMINIUM SYSTEMS

Changes reserved  
Sous reserve de modifications  
Änderungen vorbehalten

Issue: 05  
Date : 03-17

Copyright and ownership of this drawing is vested in EFT, Euro Facade Systems Ltd, whose prior written consent is required for its use, reproduction or for publication to any third party. All other rights reserved.

# 6

## Fabrication

### Comar 6EFT

#### Transom cleat size

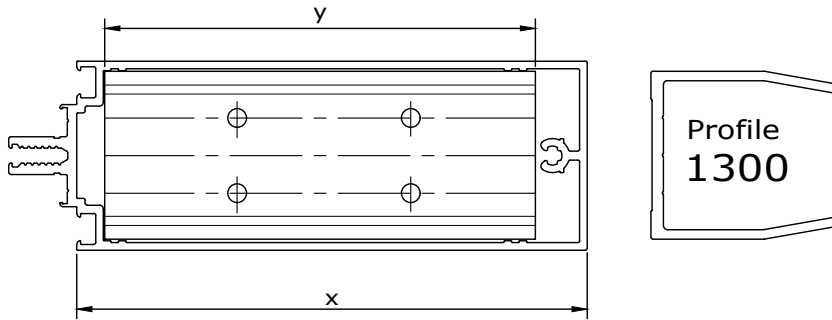

Cleat length (y) = Transom size (x) - 21mm

6.09

Transom number	Transom Size (x)	Cleat part no.	Cleat length (y)	Hole Ctr (a)
1149	45mm	N/A	N/A	N/A
1150	60mm	N/A	N/A	N/A
1151	85mm	2551	64mm	N/A
1143	85mm	2551	64mm	N/A
1164	105mm	2564	84mm	20mm
1144	115mm	Cut by Fab	94mm	See 6.10
1152	135mm	2552	114mm	35mm
1145	150mm	2554	129mm	20mm
1154	150mm	2554	129mm	20mm
1147	175mm	Cut by Fab	154mm	See 6.10
1156	180mm	2556	159mm	25&50mm
1157	195mm	2557	174mm	25mm
1148	200mm	Cut by Fab	179mm	See 6.10
1158	210mm	2558	189mm	25mm

Fabricators Guide

4 screws 3025 (4.8 x 13)  
Max. glass weight = 250kg

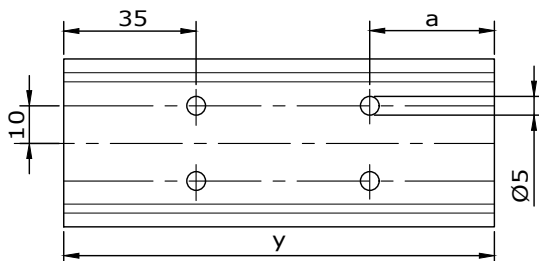

Changes reserved  
Sous reserve de modifications  
Änderungen vorbehalten

Issue: 05  
Date : 03-17

# Fabrication

6

## Comar 6EFT

## Transom cleat sizes

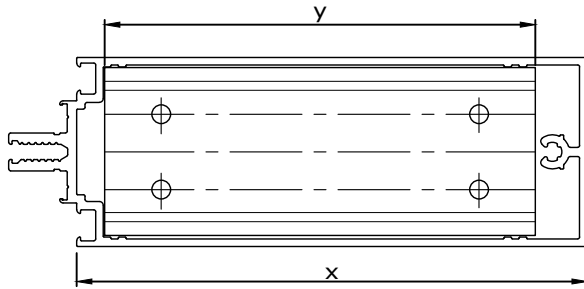
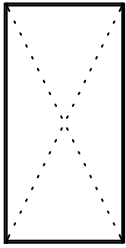

### 6.10

Transom number	Transom Size (x)	Cleat length (y)
1144	115mm	94mm
1147	175mm	154mm
1148	200mm	179mm

4 screws 3025(4.8 x 13)  
Max. glass weight = 250kg

Copyright and ownership of this drawing is vested in EFT, Euro Facade Systems Ltd, whose prior written consent is required for its use, reproduction or for publication to any third party. All other rights reserved. Subject to modifications.

### Fabricators Guide

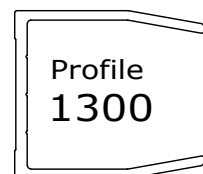
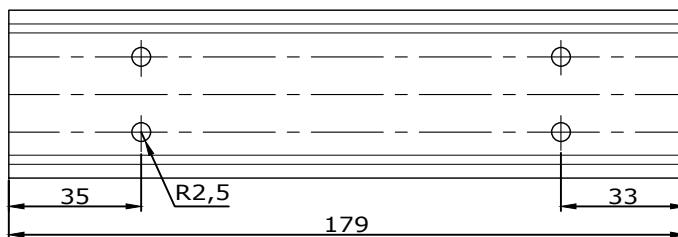
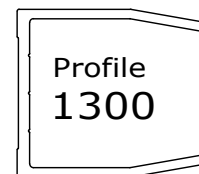
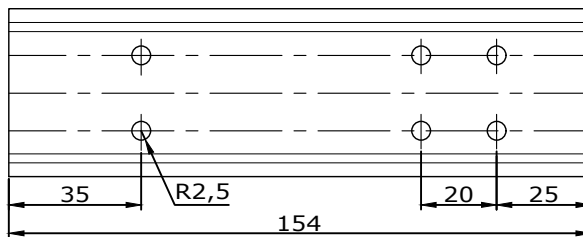
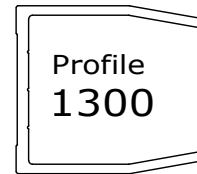
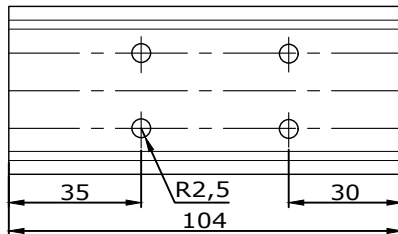
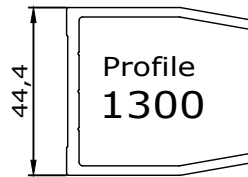
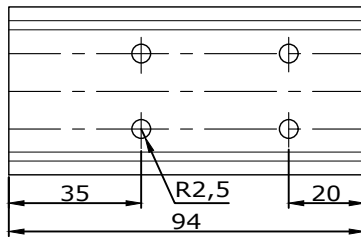

Copyright and ownership of this drawing is vested in EFT, Euro Facade Systems Ltd, whose prior written consent is required for its use, reproduction or for publication to any third party. All other rights reserved.

**6**

**Fabrication**  
**Comar 6EFT**

**Facetted clamp**

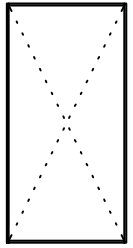
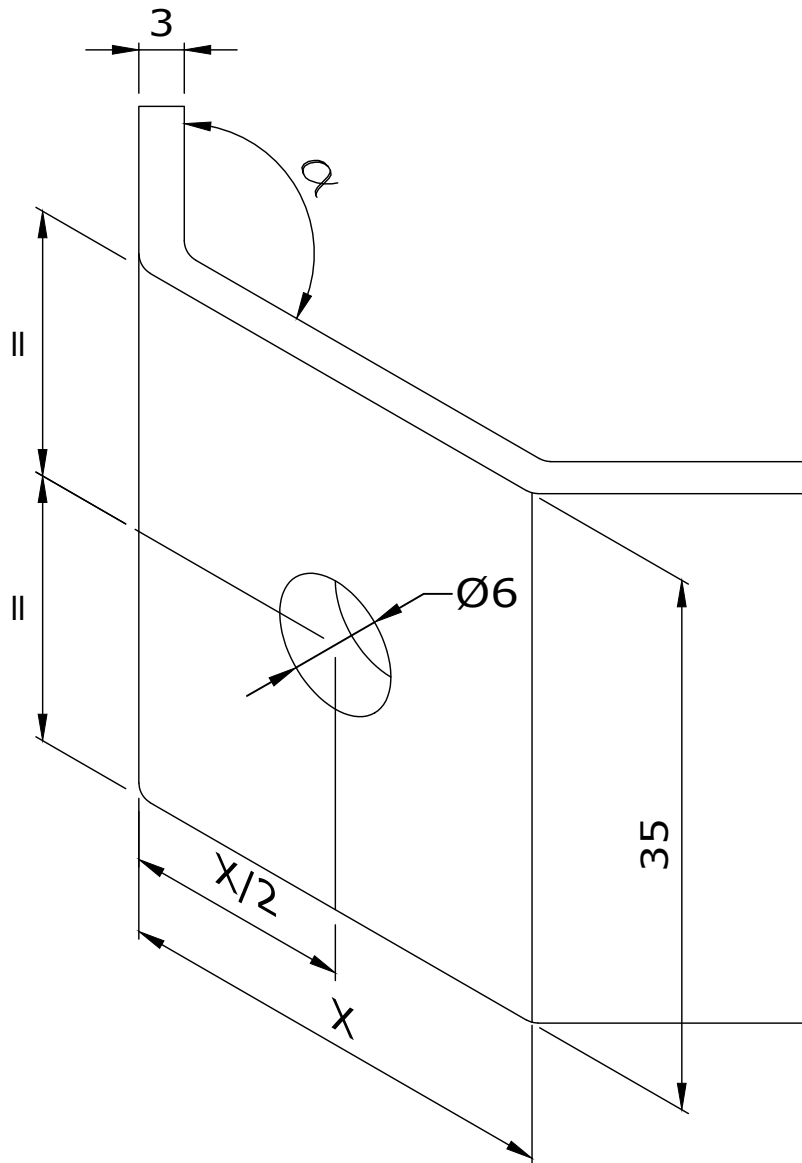

6.11

Fabricators Guide

Facetted clamps to be made to required angle  $\alpha$ .

Material : Stainless steel

Clamps to be screwed to mullion with suitable length screw. Length of screw is dependant on design of clamp and angle of facetted joint.

For additional clamp information contact Comar's technical department.

Changes reserved  
Sous reserve de modifications  
Änderungen vorbehalten

Issue: 05  
Date : 10-16

# Profile Sections

6

## Comar 6EFT

Direct fix to steel  
fixing lug preparation

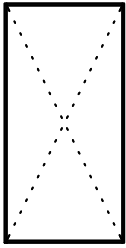

6.12

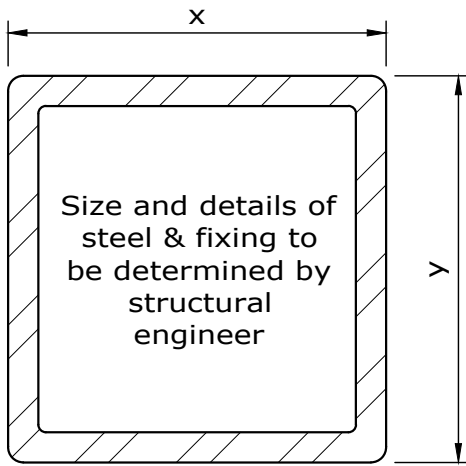

Aluminium to steel isolator  
(supplied by others)

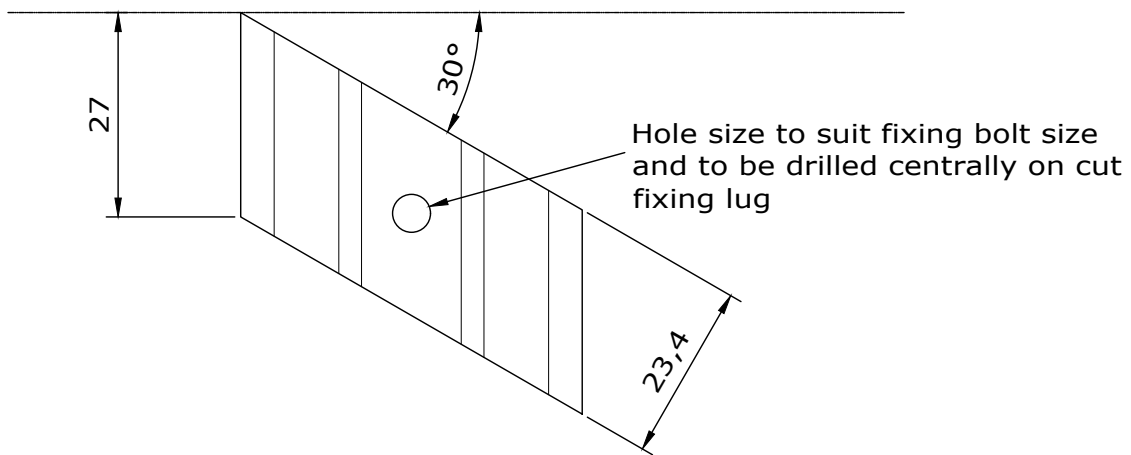
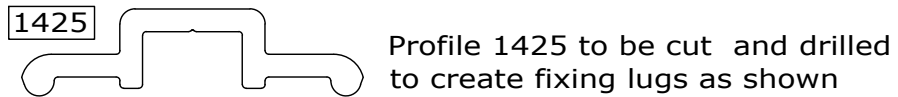
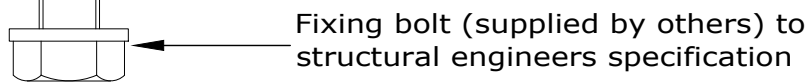
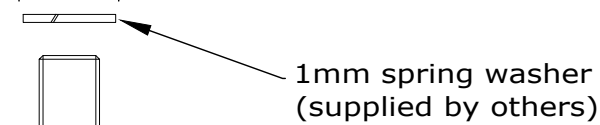
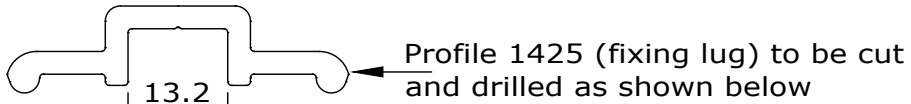

Fabricators Guide

Copyright and ownership of this drawing is vested in EFT, Euro Facade Systems Ltd, whose prior written consent is required for its use, reproduction or for publication to any third party. All other rights reserved. Subject to modifications.

Copyright and ownership of this drawing is vested in EFT, Euro Facade Systems Ltd, whose prior written consent is required for its use, reproduction or for publication to any third party. All other rights reserved.

6

Fabrication

Comar 6EFT

Mullion sleeve plate  
85 mm (1070)  
105 mm (1072)

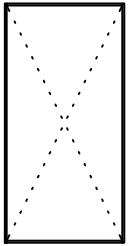

6.13

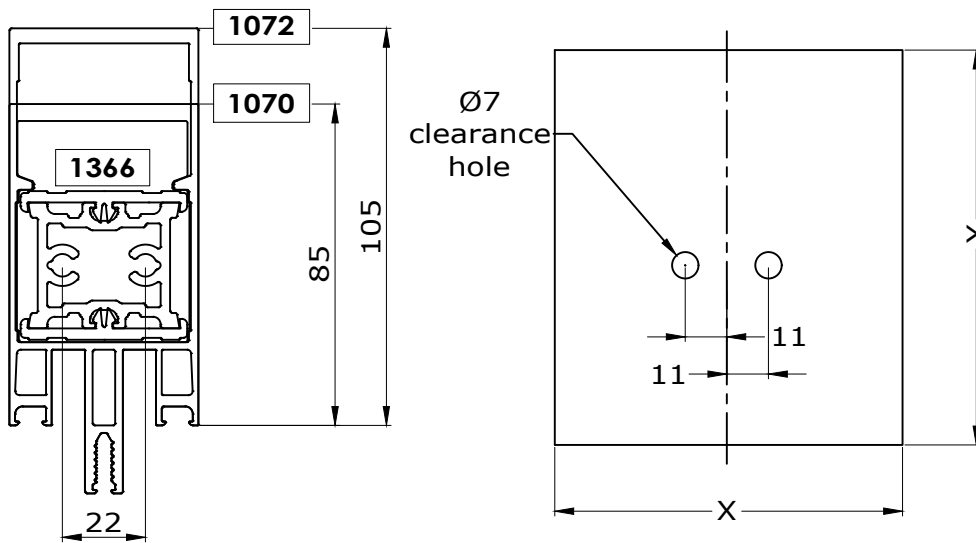
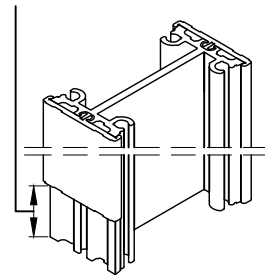

Plate supplied by others

Use Ø6.3mm number 14 x 25mm self tapping screw, countersunk (supplied by others) or plate can be welded.

Length & width of plate and anchor bolts to be determined by site conditions and to structural engineers specification.

Front plastic cover cap cut back as needed to fit EPDM



Fabricators Guide

Changes reserved  
Sous reserve de modifications  
Änderungen vorbehalten

Issue: 05  
Date: 10-16

# Fabrication

6

## Comar 6EFT

Mullion Sleeve Plate  
 115mm(1069),125mm(1073)  
 135mm(1074),150mm(1075)  
 150mm(1076),180mm(1078)

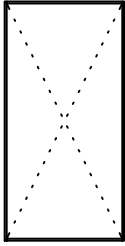

6.14

Fabricators Guide

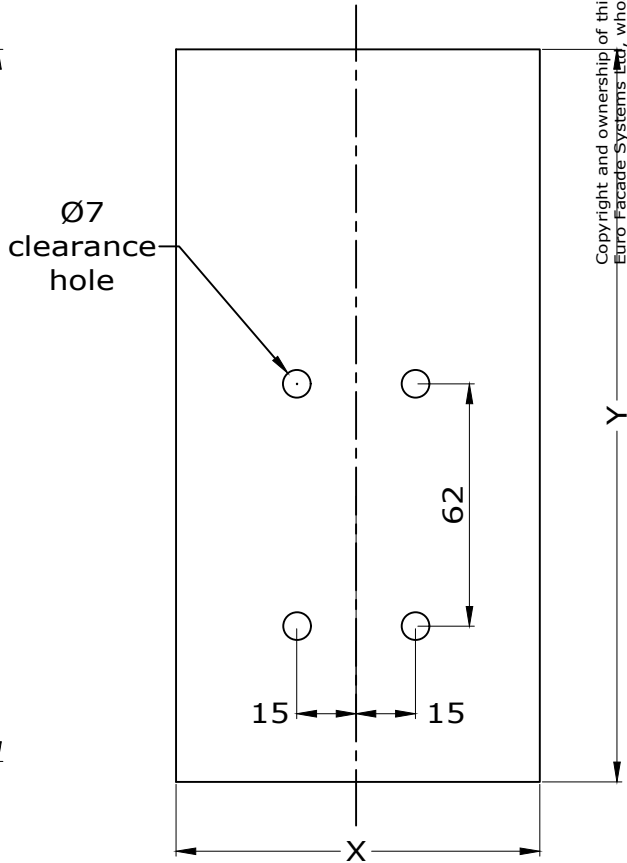
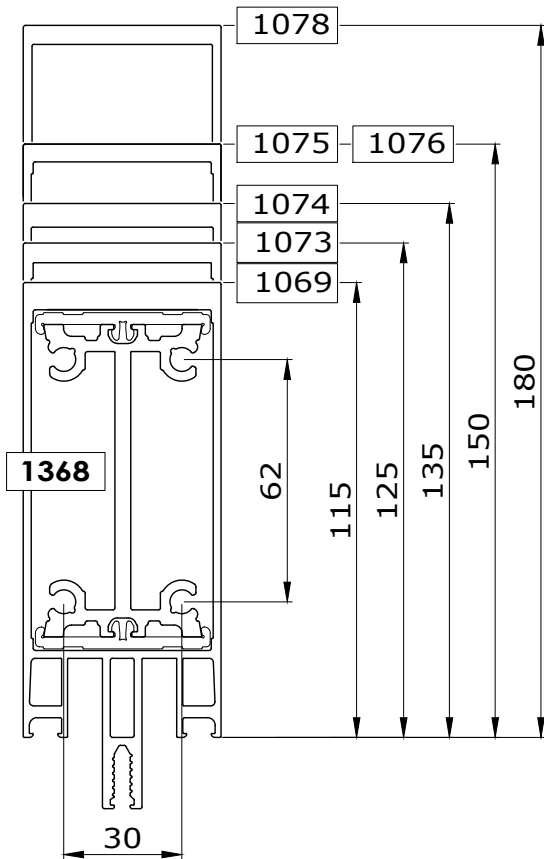

Copyright and ownership of this drawing is vested in EFT, Euro Facade Systems Ltd, whose prior written consent is required for its use, reproduction or for publication to any third party. All other rights reserved. Subject to modifications.

Plate supplied by others

Use Ø6.3mm number 14 x 25mm self tapping screw, countersunk (supplied by others) or plate can be welded.

Length & width of plate and anchor bolts to be determined by site conditions and to structural engineers specification.

Front plastic cover cap cut back as needed to fit EPDM

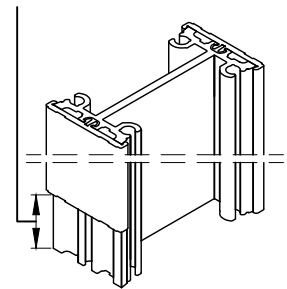



Mullion sleeve plate  
175mm (1085), 175mm (1077)  
195 mm (1080)

Copyright and ownership of this drawing is vested in EFT,  
Euro Facade Systems Ltd, whose prior written consent is required  
for its use, reproduction or for publication to any third party.  
All other rights reserved. Subject to modifications.

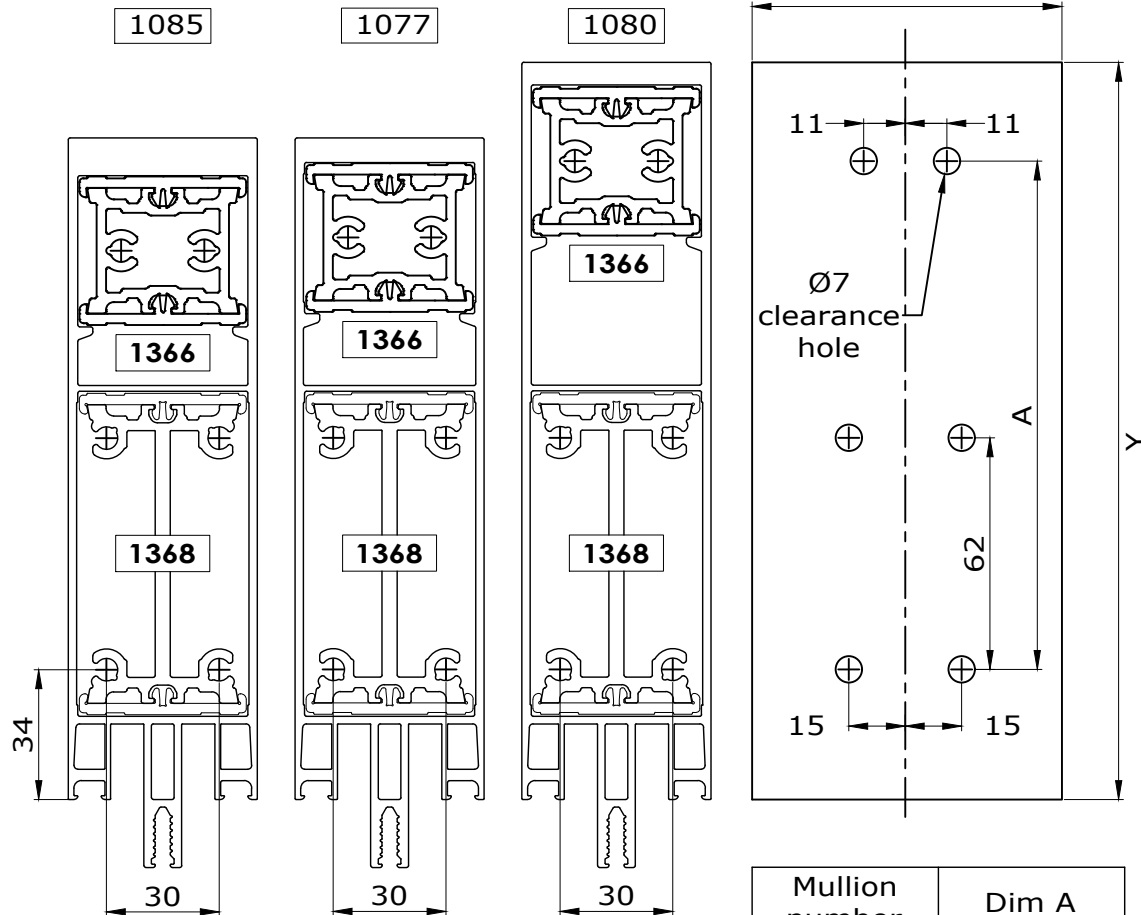

Mullion number	Dim A
1085	111
1077	114
1080	134

Plate supplied by others

Use Ø6.3mm number 14 x 25mm self tapping screw, countersunk (supplied by others) or plate can be welded.

Length & width of plate and anchor bolts to be determined by site conditions and to structural engineers specification.

Front plastic cover cap cut back as needed to fit EPDM

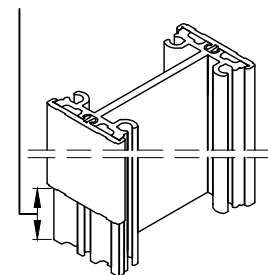

Changes reserved  
Sous reserve de modifications  
Änderungen vorbehalten

Issue: 05  
Date: 10-16

# Fabrication

6

## Comar 6EFT

### Mullion sleeve plate 210 mm (1082)

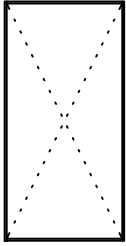

6.16

Fabricators Guide

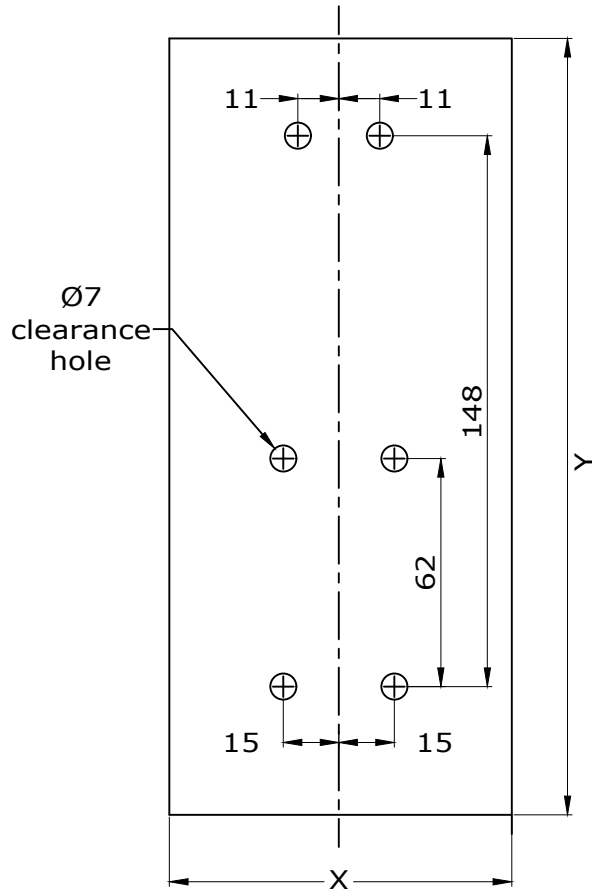
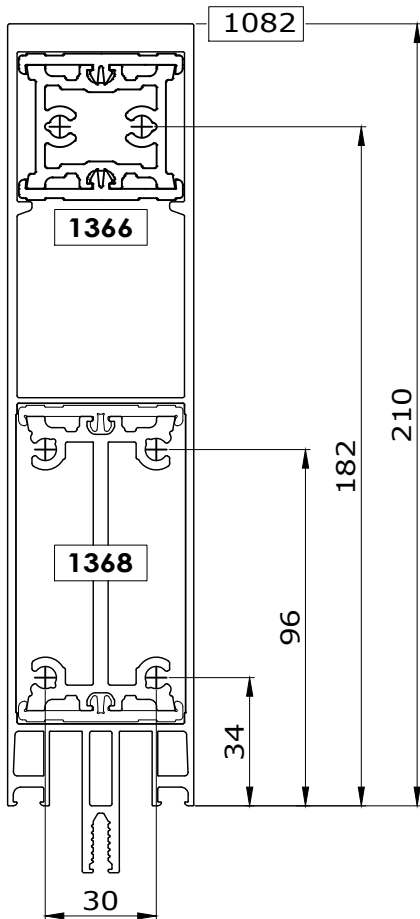

Copyright and ownership of this drawing is vested in EFT, Euro Facade Systems Ltd, whose prior written consent is required for its use, reproduction or for publication to any third party. All other rights reserved. Subject to modifications.

5mm thick aluminium plate supplied by others

Use Ø6.3mm number 14 x 25mm self tapping screw, countersunk (supplied by others) or plate can be welded.

Length & width of plate and anchor bolts to be determined by site conditions and to structural engineers specification.

Front plastic cover cap cut back as needed to fit EPDM

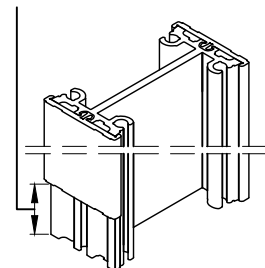

## EPDM membrane Transom Sill, Head & Mullion preparation

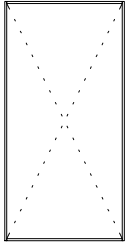

6.17

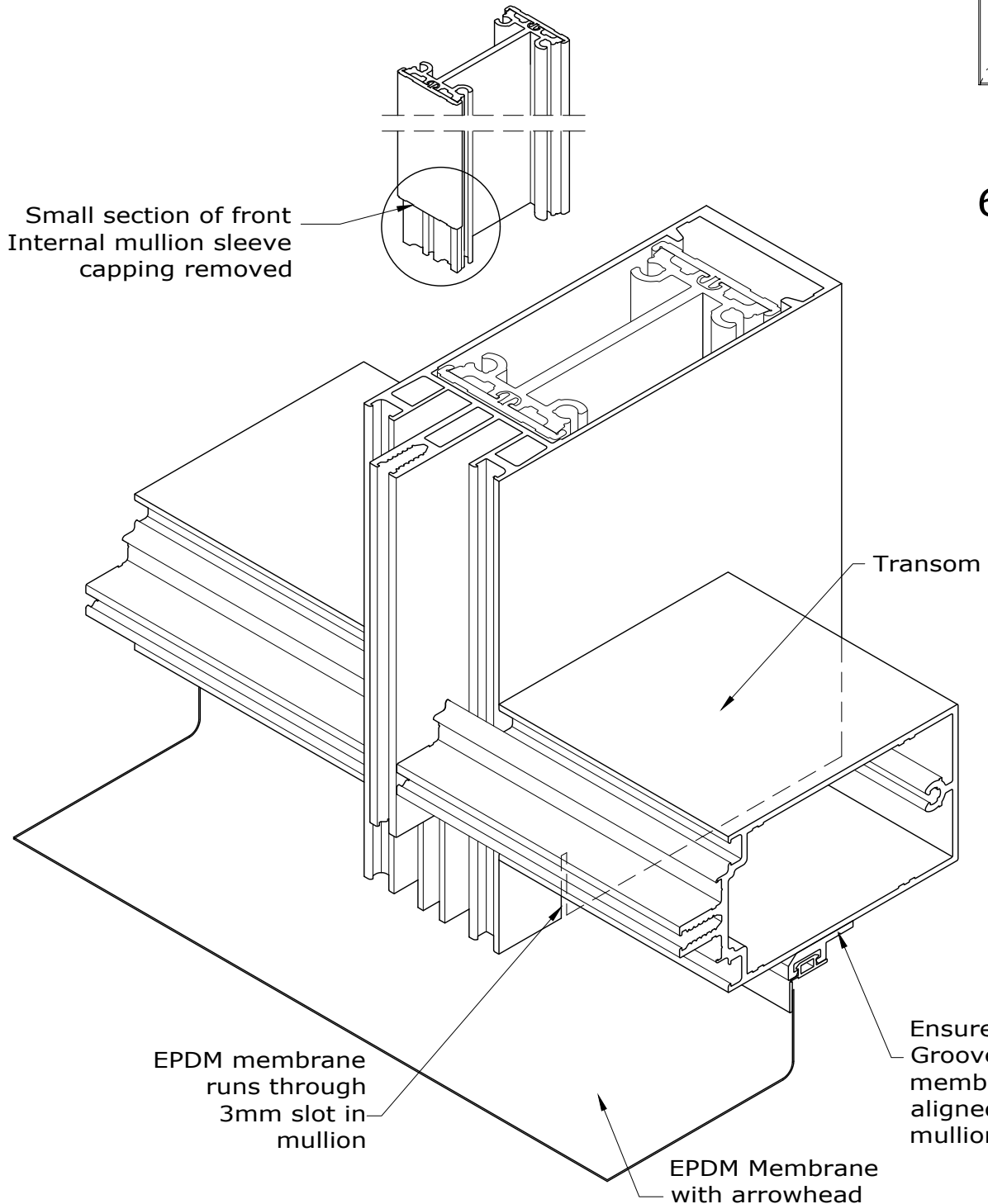

# Fabrication

# 6

## Comar 6EFT

## EPDM membrane Curtain wall perimeter Preparation

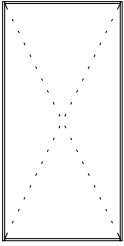

6.18

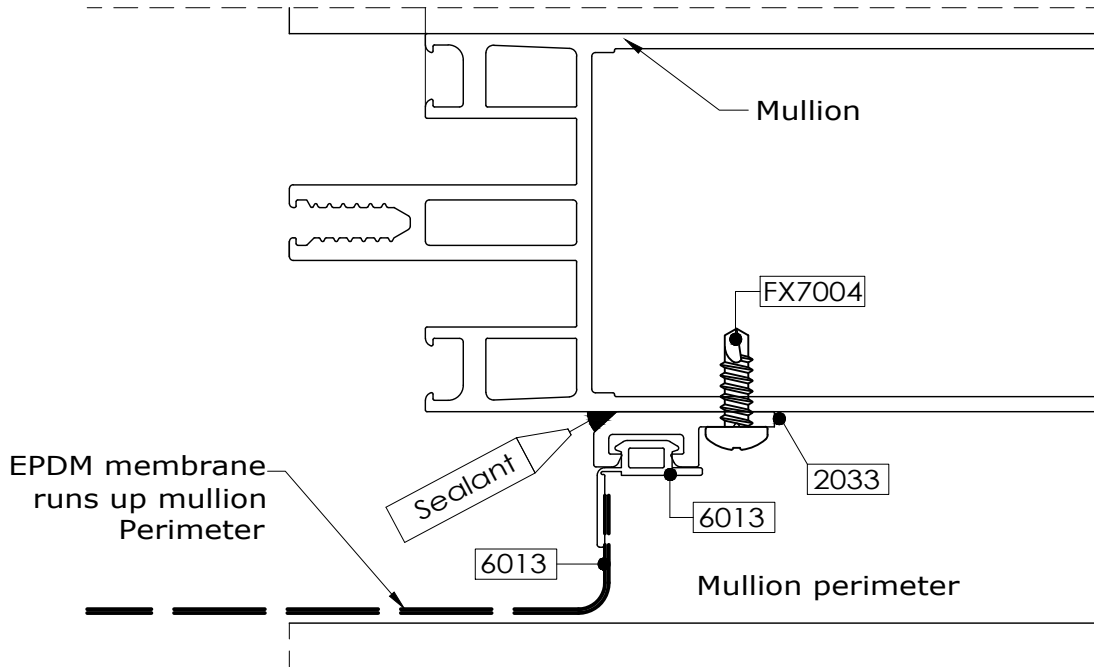

Fabricators Guide

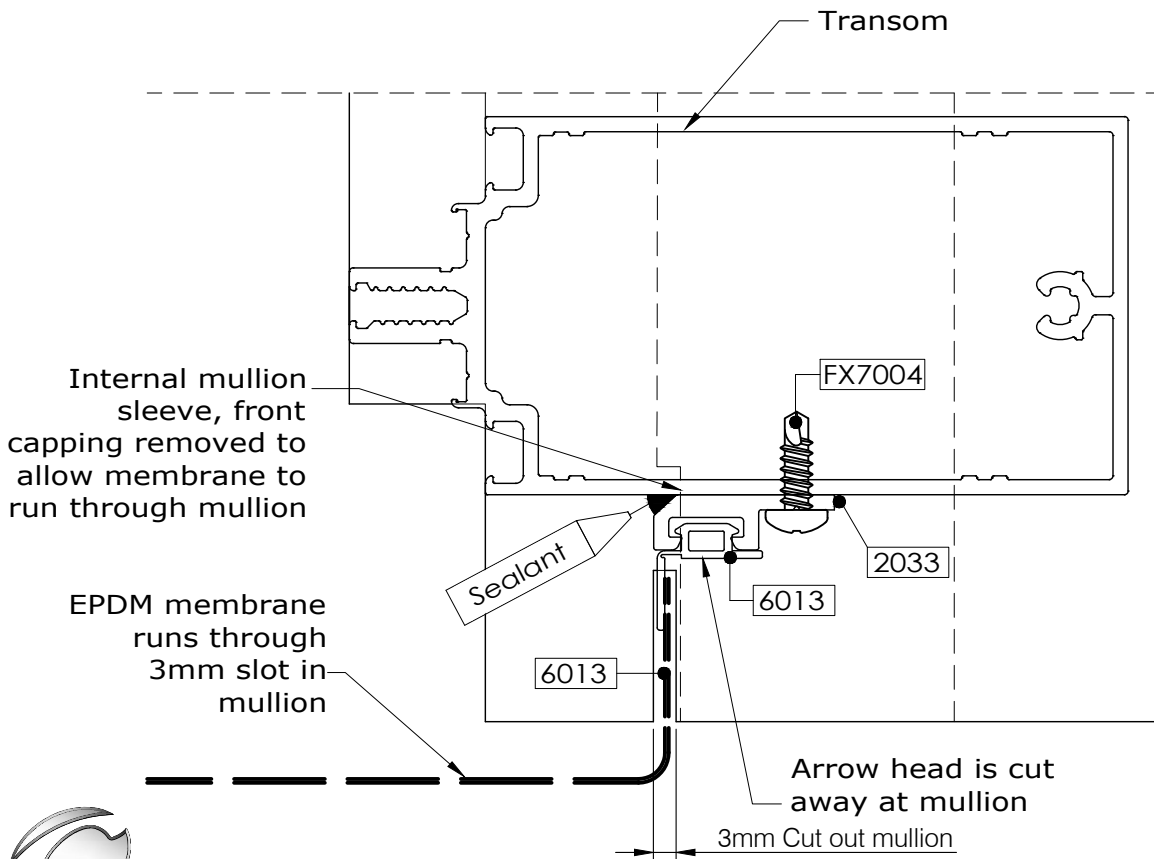

Copyright and ownership of this drawing is vested in EFT, Euro Facade Systems Ltd, whose prior written consent is required for its use, reproduction or for publication to any third party. All other rights reserved. Subject to modifications.



Copyright and ownership of this drawing is vested in EFT, Euro Facade Systems Ltd, whose prior written consent is required for its use, reproduction or for publication to any third party. All other rights reserved.

# EPDM membrane Mullion preparation Slot cutting details

6

Fabrication  
Comar 6EFT

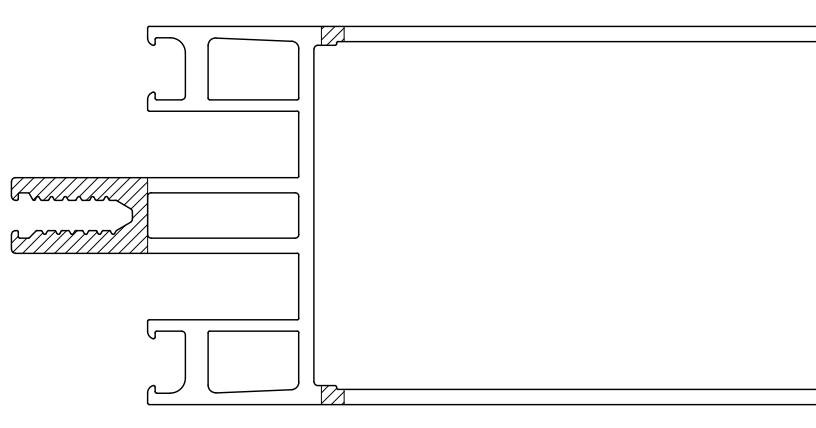
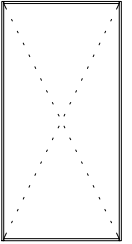

6.19

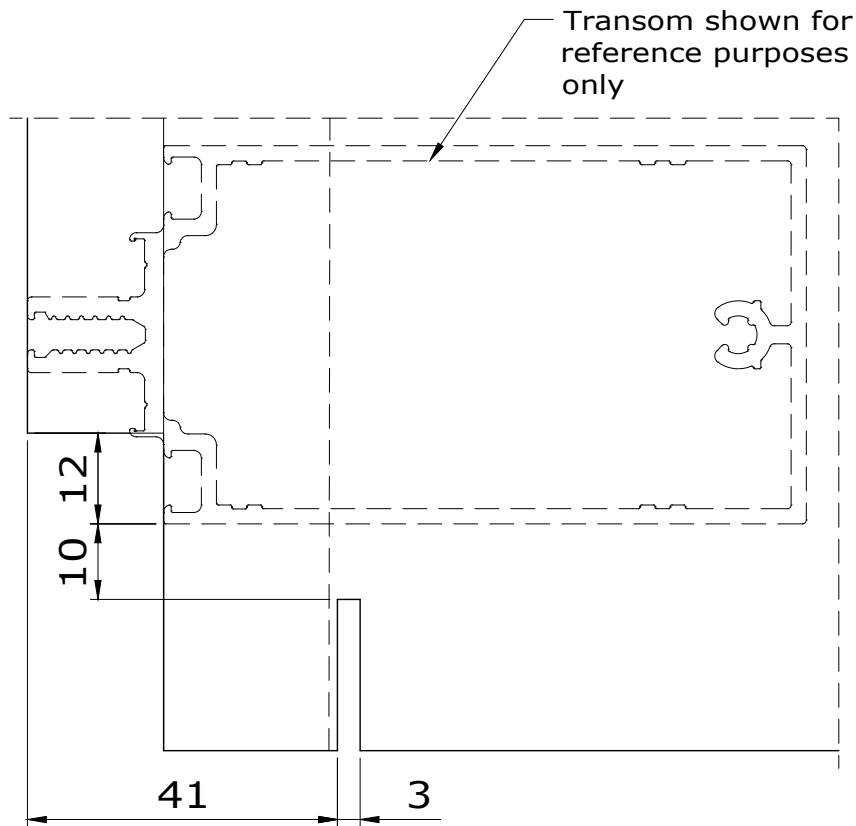

Fabricators Guide

Changes reserved  
Sous reserve de modifications  
Änderungen vorbehalten

Issue: 05  
Date: 10-16

# Fabrication

# 6

## Comar 6EFT

## Fixing bracket hole prep

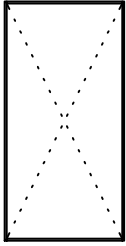

6.20

Fabricators Guide

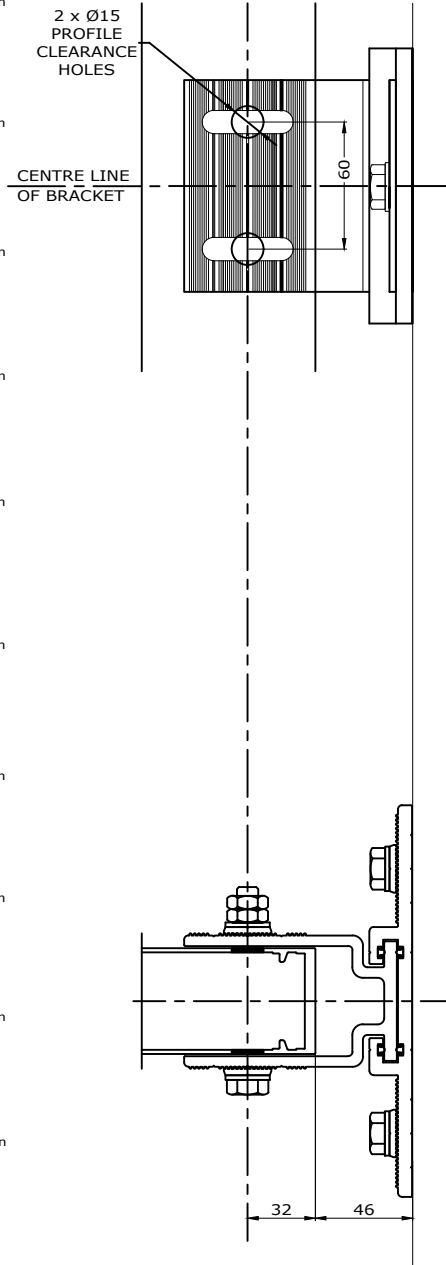
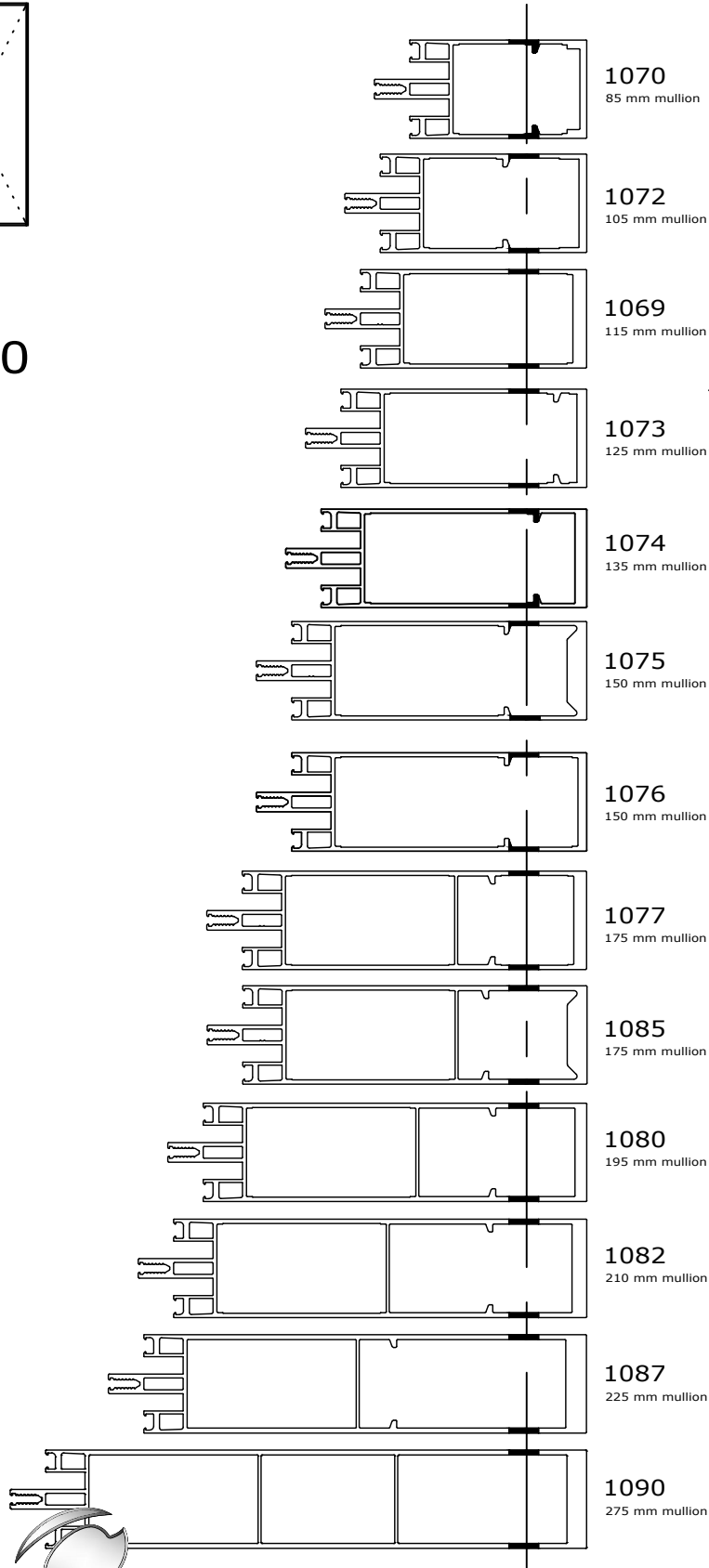

Copyright and ownership of this drawing is vested in EFT, Euro Facade Systems Ltd, whose prior written consent is required for its use, reproduction or for publication to any third party. All other rights reserved. Subject to modifications.

Copyright and ownership of this drawing is vested in EFT, Euro Facade Systems Ltd, whose prior written consent is required for its use, reproduction or for publication to any third party. All other rights reserved.

6

Fabrication  
Comar 6EFT

Tooling

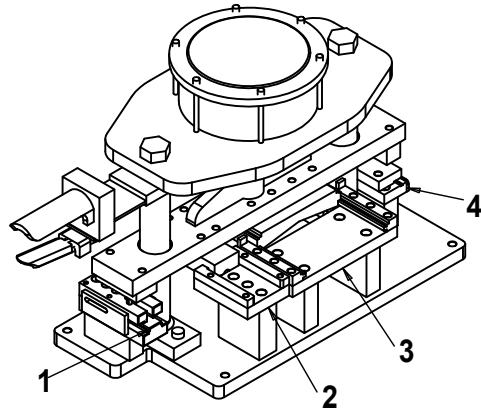

Preparations:  
As per drawing 6.23  
transom end notch

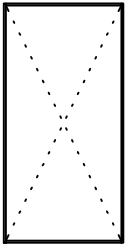

6.21

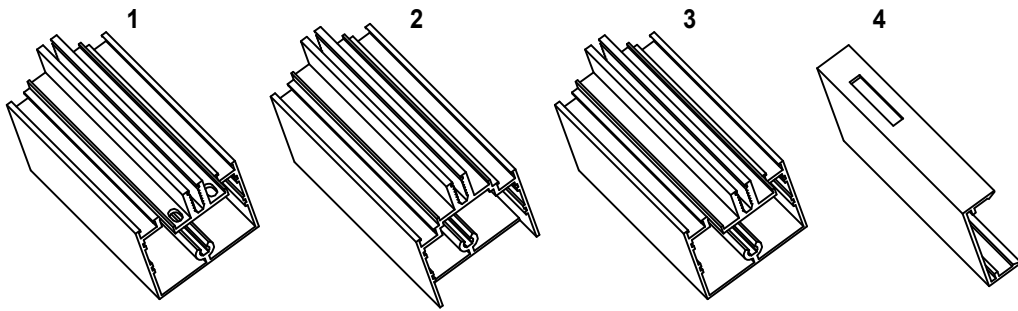

Tool: Pneumatic punch tool Com6-EFT-T13

Mullion - Transom connection

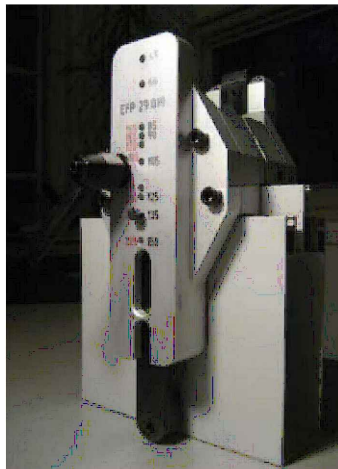
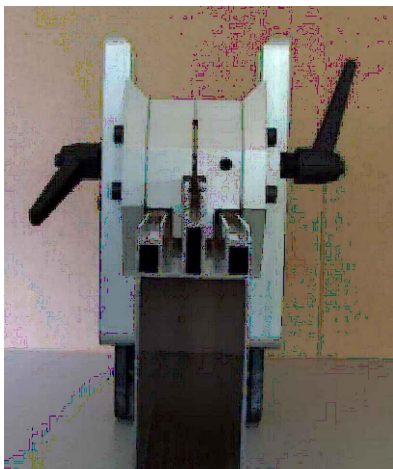

Tool: Com6-EFT-Jig 1

Changes reserved  
Sous reserve de modifications  
Änderungen vorbehalten

Issue: 05  
Date : 10-16

# Fabrication

# 6

## Comar 6EFT

## Mullion preparation

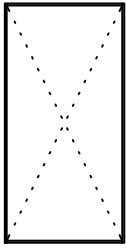

Transoms installed in between ladders

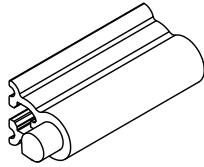

EFT 2310

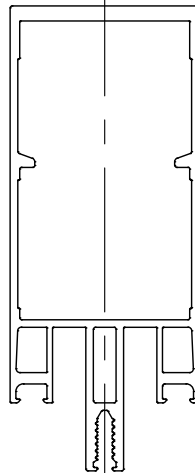

Ladder / unit

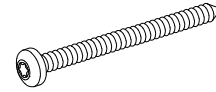

3022 (4.8 x 65)

6.22

Fabricators Guide

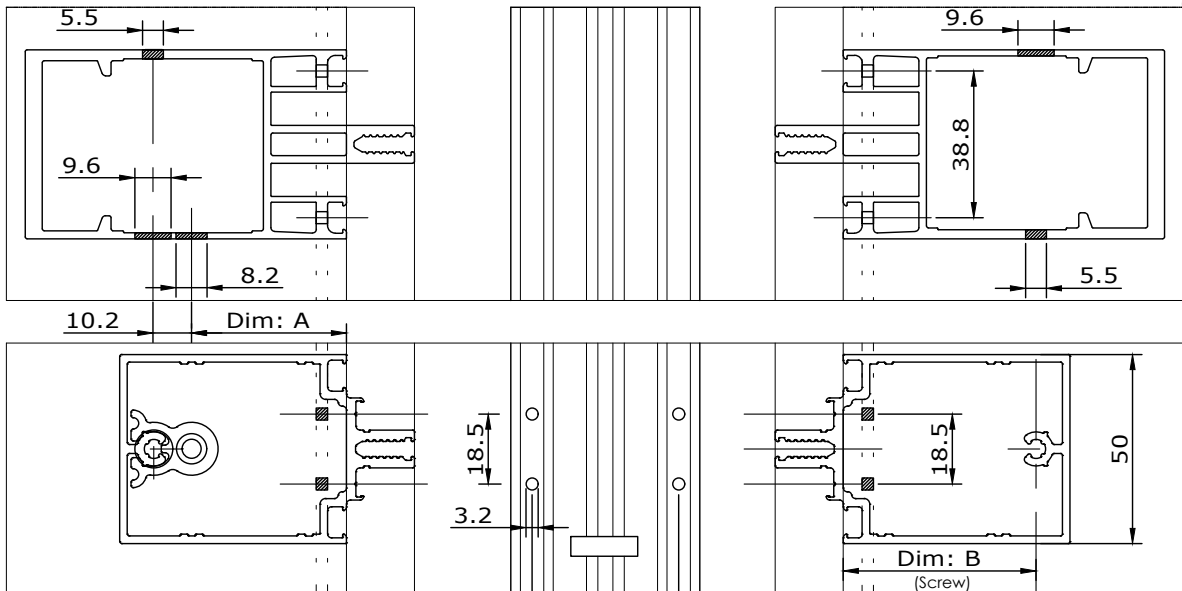

Transom no:		Dim: A
EFT 1149	45 mm	25.2
EFT 1150	60 mm	40.2
EFT 1151	85 mm	65.2
EFT 1143	85 mm	65.0
EFT 1164	105 mm	85.0
EFT 1144	115 mm	95.0
EFT 1152	135 mm	115.0
EFT 1154	150 mm	130.0
EFT 1145	150 mm	130.0
EFT 1147	175 mm	155.0
EFT 1156	180 mm	160.0
EFT 1157	195 mm	175.0
EFT 1158	210 mm	180.0
EFT 1148	200 mm	190.0

Transom no:		Dim: B
EFT 1149	45 mm	35.4
EFT 1150	60 mm	50.4
EFT 1151	85 mm	75.4
EFT 1143	85 mm	75.2
EFT 1164	105 mm	95.2
EFT 1144	115 mm	105.2
EFT 1152	135 mm	125.2
EFT 1154	150 mm	140.2
EFT 1145	150 mm	140.2
EFT 1147	175 mm	165.2
EFT 1156	180 mm	170.2
EFT 1157	195 mm	185.2
EFT 1148	200 mm	190.2
EFT 1158	210 mm	200.2

Copyright and ownership of this drawing is vested in EFT, Euro Facade Systems Ltd, whose prior written consent is required for its use, reproduction or for publication to any third party. All other rights reserved. Subject to modifications.



**comar**

ARCHITECTURAL ALUMINIUM SYSTEMS

Changes reserved  
Sous reserve de modifications  
Änderungen vorbehalten

Issue: 05  
Date: 03-17



Transom preparation

Copyright and ownership of this drawing is vested in EFT, Euro Facade Systems Ltd, whose prior written consent is required for its use, reproduction or for publication to any third party. All other rights reserved.

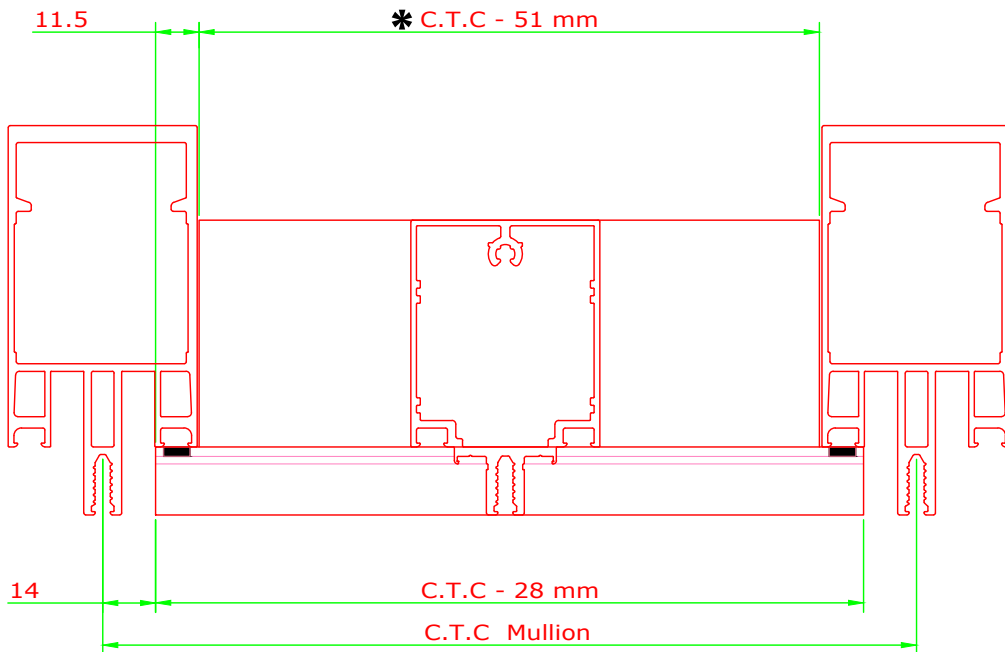
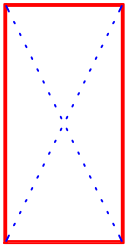

6.23

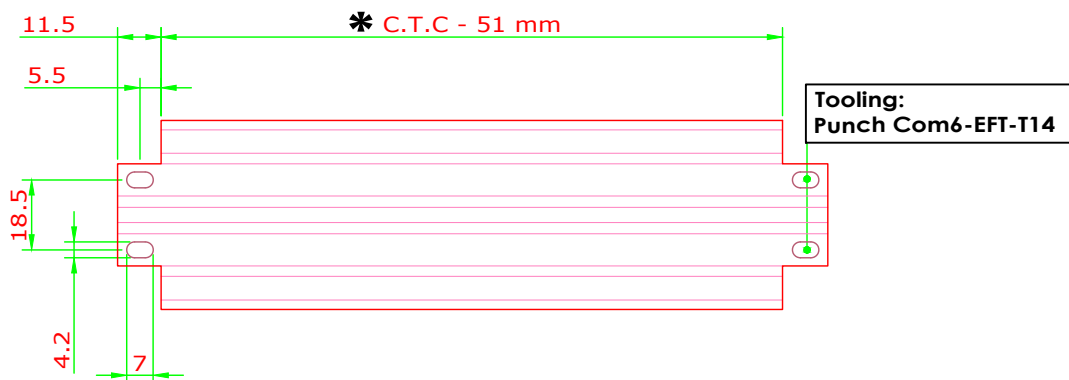

Fabricators Guide

\* For pre-fabricated units use C.T.C-50mm (ladders)

\* For faceted transom preparation please contact Comar's technical department.

Changes reserved  
Sous reserve de modifications  
Änderungen vorbehalten

Issue: 05  
Date: 03-17

# Fabrication

# 6

## Comar 6EFT

## Horizontal pressure plate & horizontal cover cap

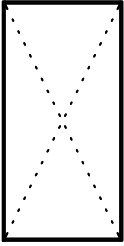

6.24

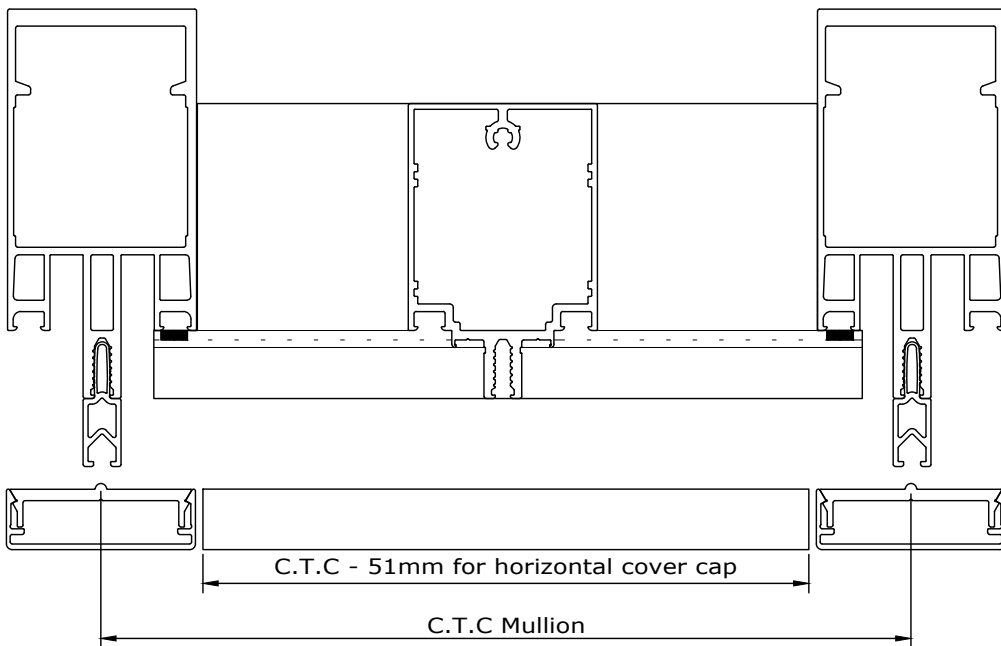
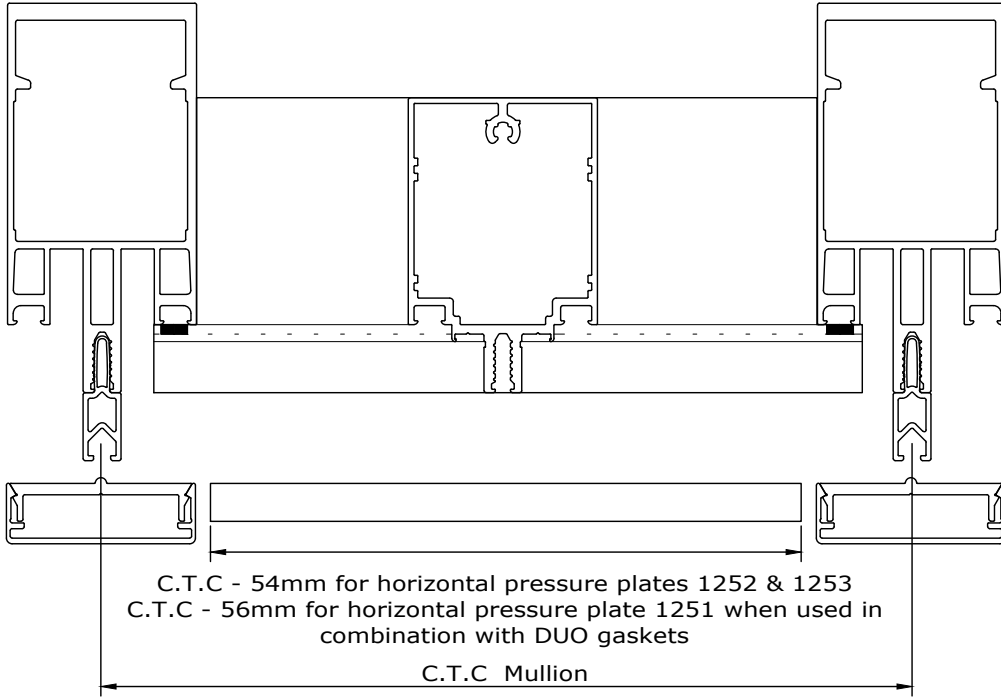

Copyright and ownership of this drawing is vested in EFT, Euro Facade Systems Ltd, whose prior written consent is required for its use, reproduction or for publication to any third party. All other rights reserved. Subject to modifications.

Fabricators Guide



**comar**  
ARCHITECTURAL ALUMINIUM SYSTEMS

Changes reserved  
Sous reserve de modifications  
Änderungen vorbehalten

Issue: 05  
Date : 03 -17

Facetted transom preparation  
External Corner

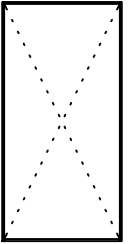

6.25

Fabricators Guide

Copyright and ownership of this drawing is vested in EFT, Euro Facade Systems Ltd, whose prior written consent is required for its use, reproduction or for publication to any third party. All other rights reserved.

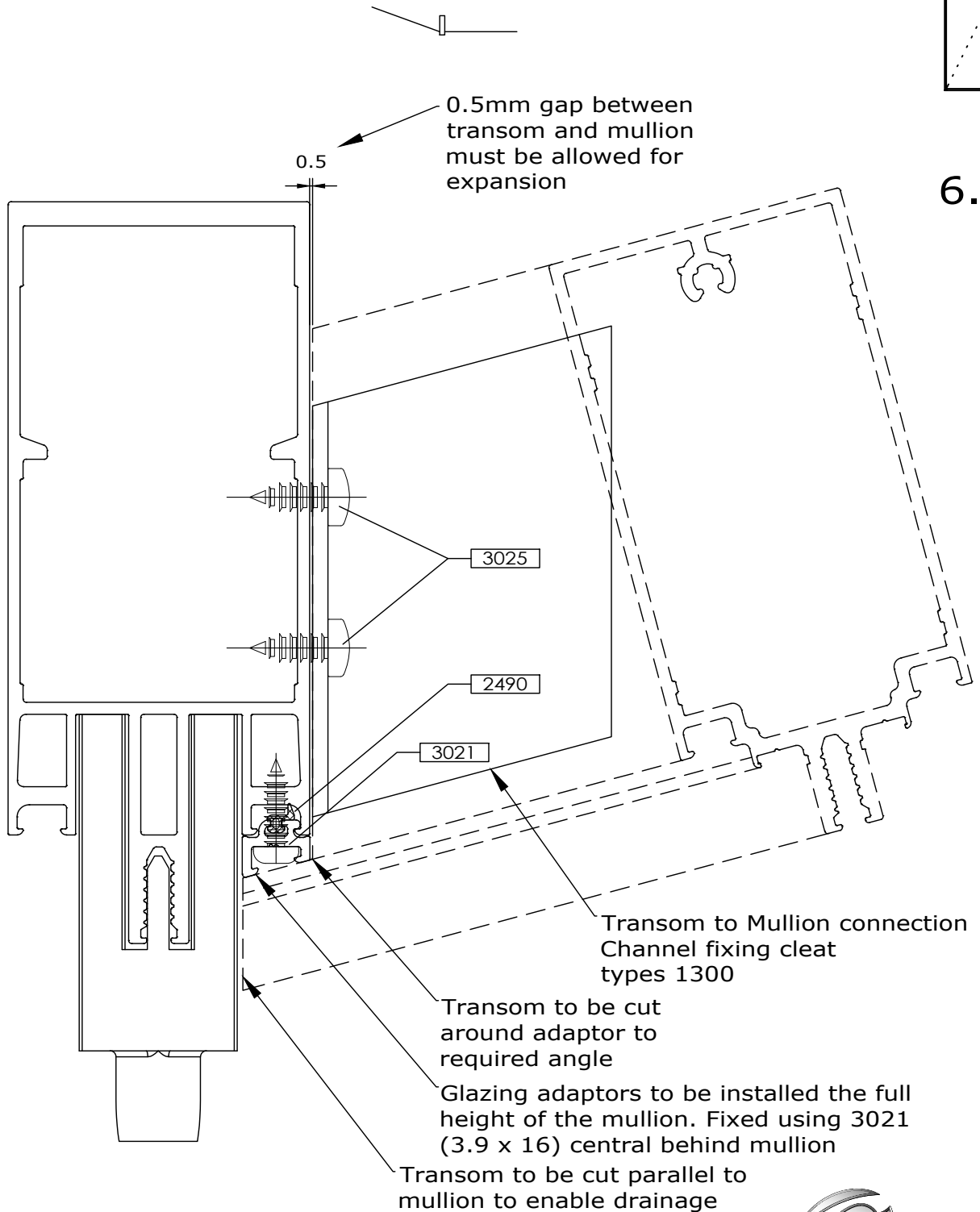

Changes reserved  
Sous reserve de modifications  
Änderungen vorbehalten

Issue: 05  
Date: 10-16

# Fabrication

# 6

## Comar 6EFT

### Facetted transom preparation Internal Corner

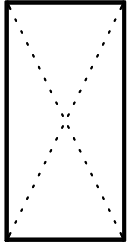

6.26

Fabricators Guide

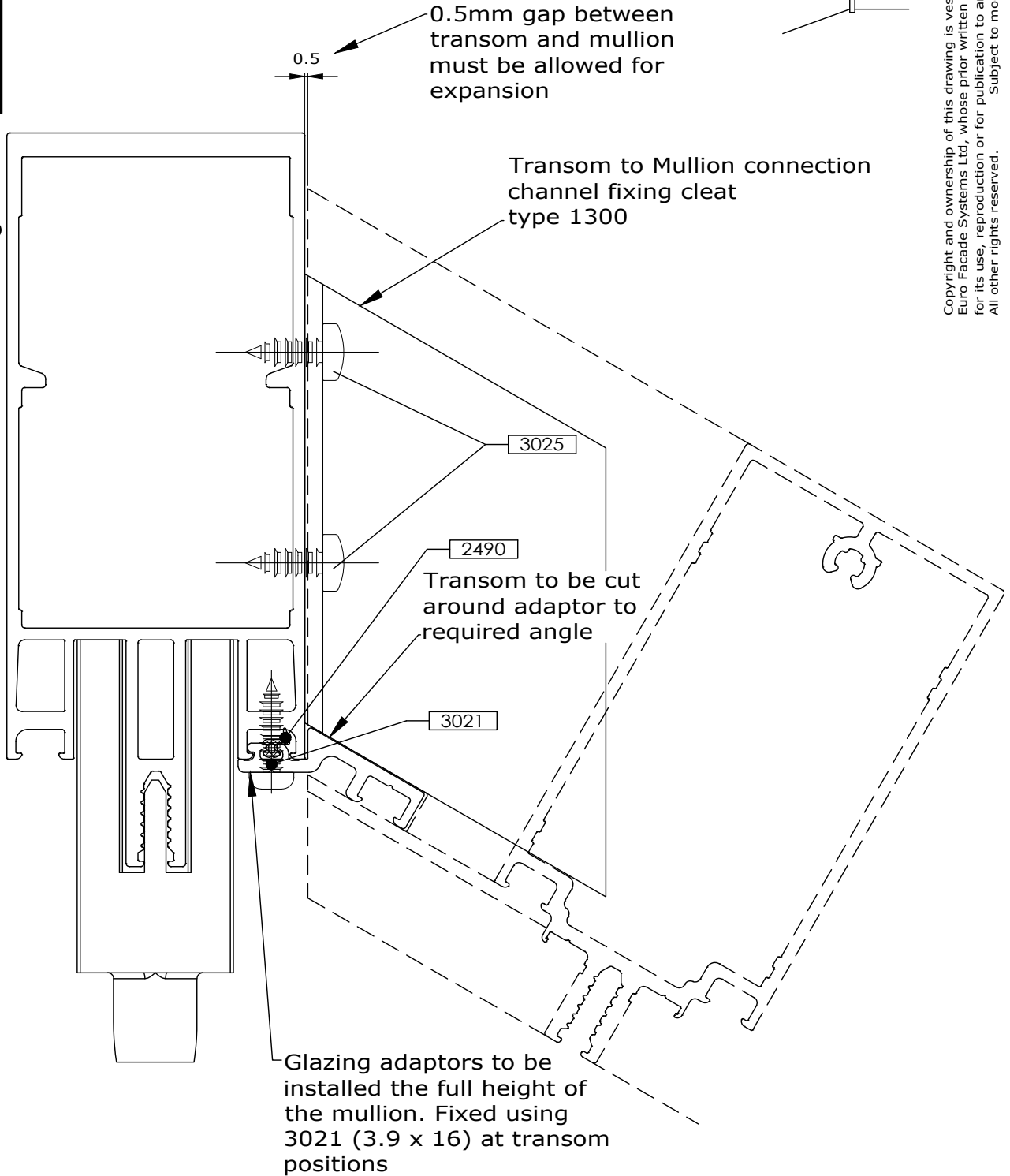

Copyright and ownership of this drawing is vested in EFT, Euro Facade Systems Ltd, whose prior written consent is required for its use, reproduction or for publication to any third party. All other rights reserved. Subject to modifications.

Fixing facatted transoms  
External Corner

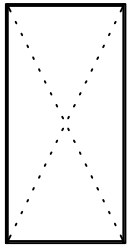

6.27

Copyright and ownership of this drawing is vested in EFT,  
Euro Facade Systems Ltd, whose prior written consent is required  
for its use, reproduction or for publication to any third party.  
All other rights reserved.

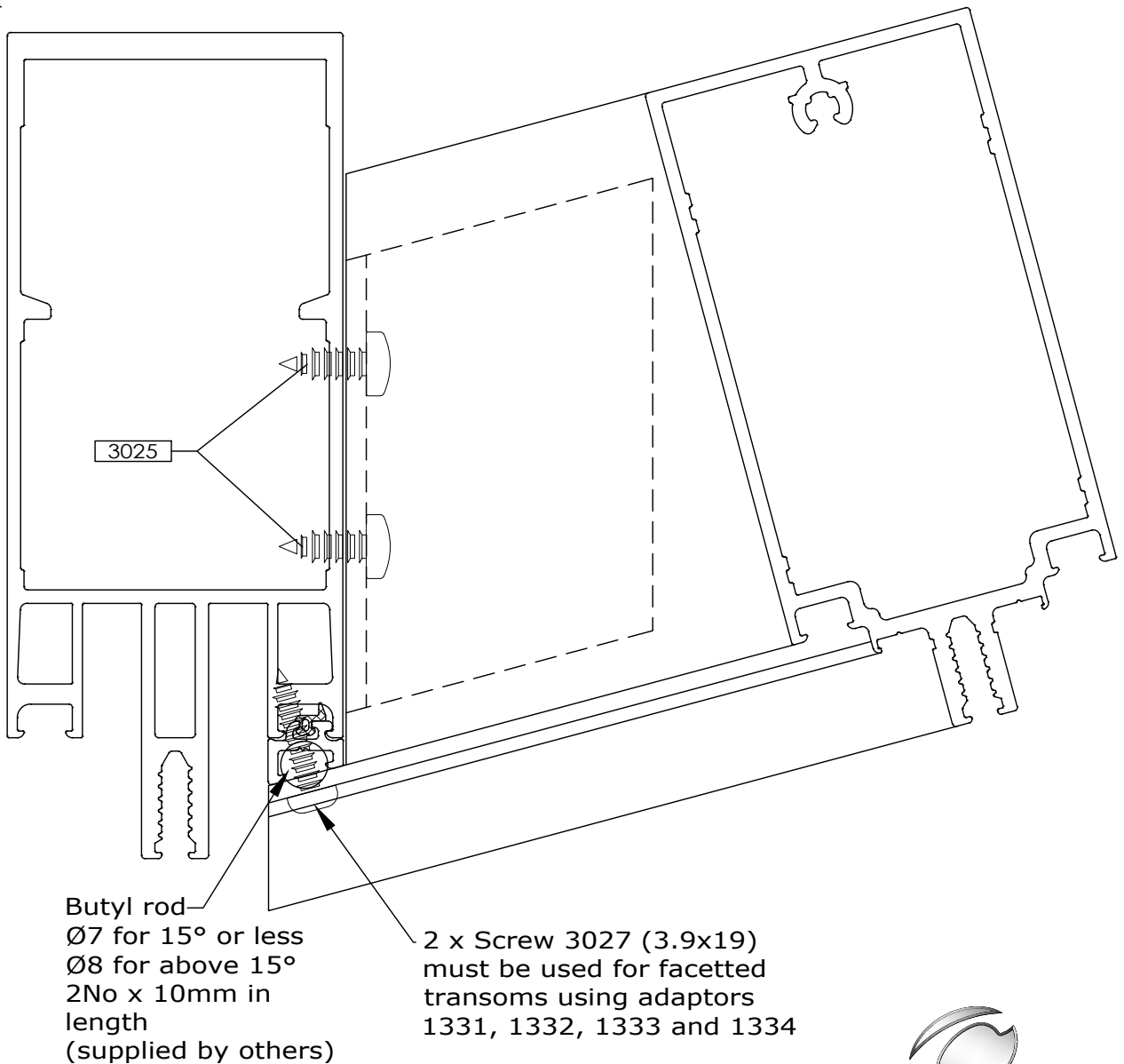
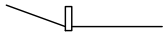

Fabricators Guide

Changes reserved  
Sous reserve de modifications  
Änderungen vorbehalten

Issue: 05  
Date: 10 -16

# Fabrication

# 6

## Comar 6EFT

## Fixing faceted transoms Internal Corner

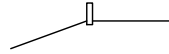
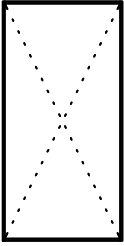

6.28

Fabricators Guide

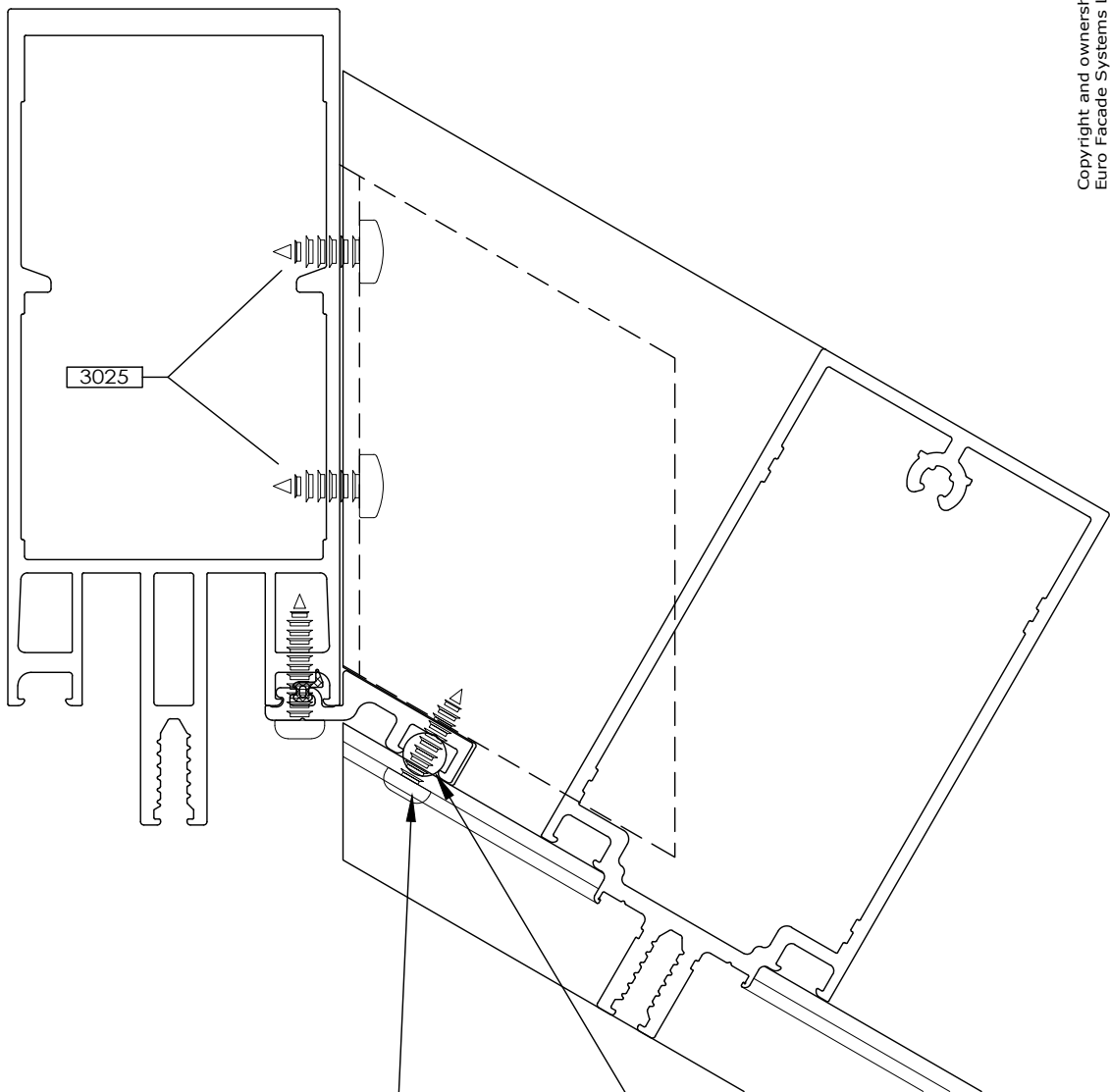

Transoms to be fixed to adaptor with screws 3021 (3.9x16)

For exact angle adaptors ie 7.5°, 15° etc, use transom pad 2028. For all other angles use butyl rod, Ø8mm, 27mm long, supplied by others.

Copyright and ownership of this drawing is vested in EFT, Euro Facade Systems Ltd, whose prior written consent is required for its use, reproduction or for publication to any third party. All other rights reserved. Subject to modifications.

Copyright and ownership of this drawing is vested in EFT, Euro Facade Systems Ltd, whose prior written consent is required for its use, reproduction or for publication to any third party. All other rights reserved.

## Facatted transom cleat preparation

6

Fabrication  
Comar 6EFT

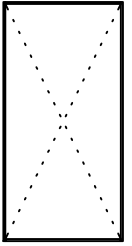

Any facatted transom must be held in place by cleats made from profile 1300 (or 1305 if specified)

Same cleat preparation can be used for outward (reflex) angles.

6.29

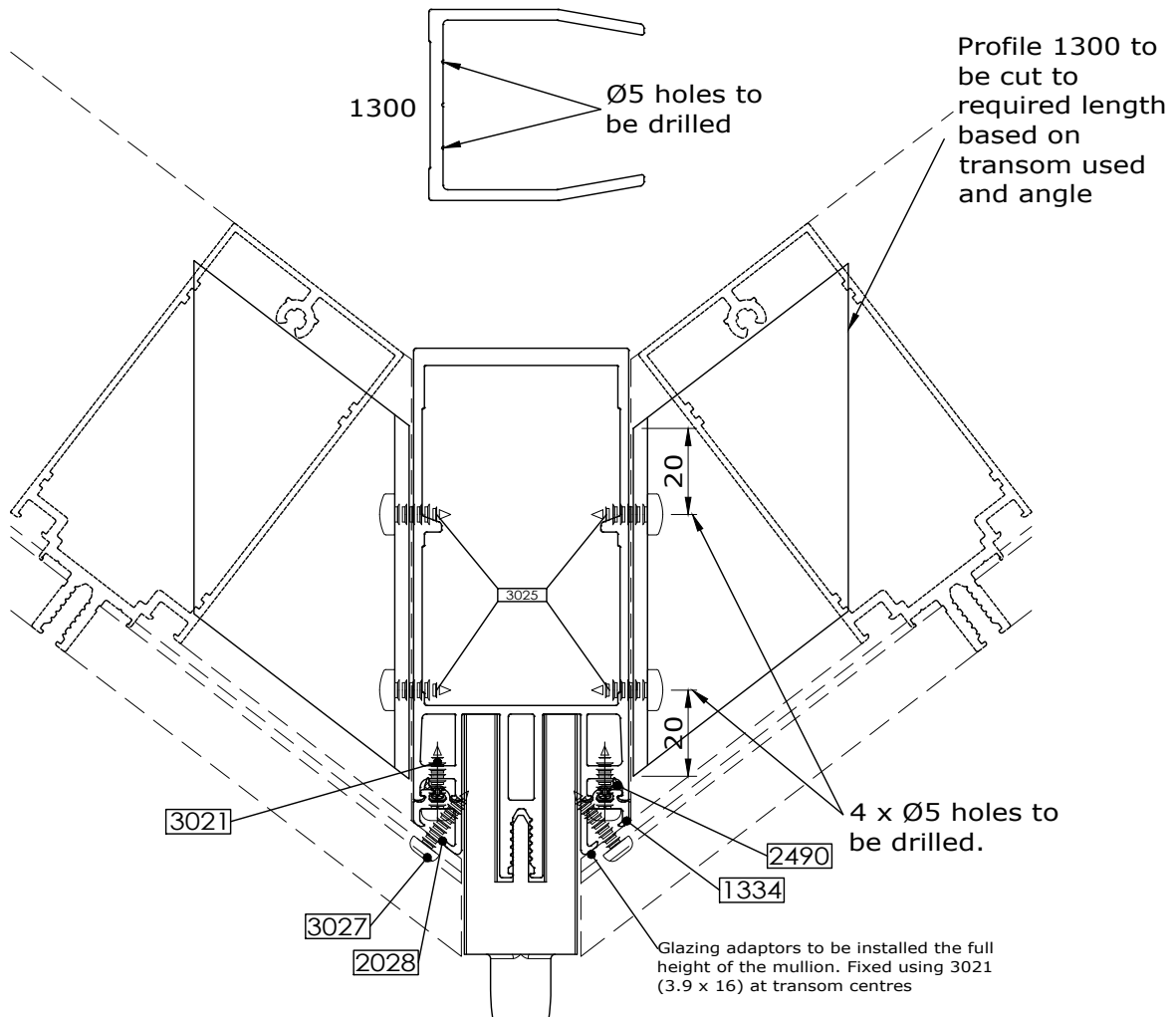

Fabricators Guide

Changes reserved  
Sous reserve de modifications  
Änderungen vorbehalten

Issue: 05  
Date: 10-16

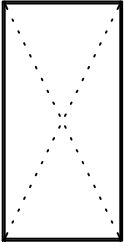

6.30

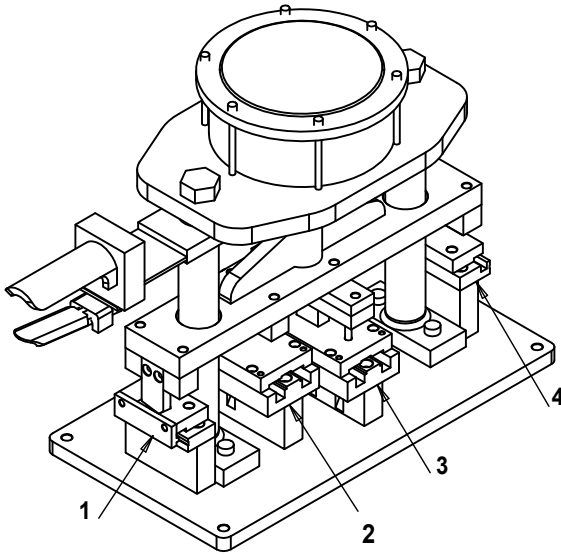

**Preparations:**

**As per drawings: 6.31 & 6.36**

- \* Pressure plate fixing holes
- \* Pressure plate drainage slots
- \* Cover cap drainage slots
- \* Transom slots  
(mullion - transom connection)

Copyright and ownership of this drawing is vested in EFT,  
 Euro Facade Systems Ltd, whose prior written consent is required  
 for its use, reproduction or for publication to any third party.  
 All other rights reserved. Subject to modifications.

**Tool: Pneumatic punch tool Com6-EFT-T14**

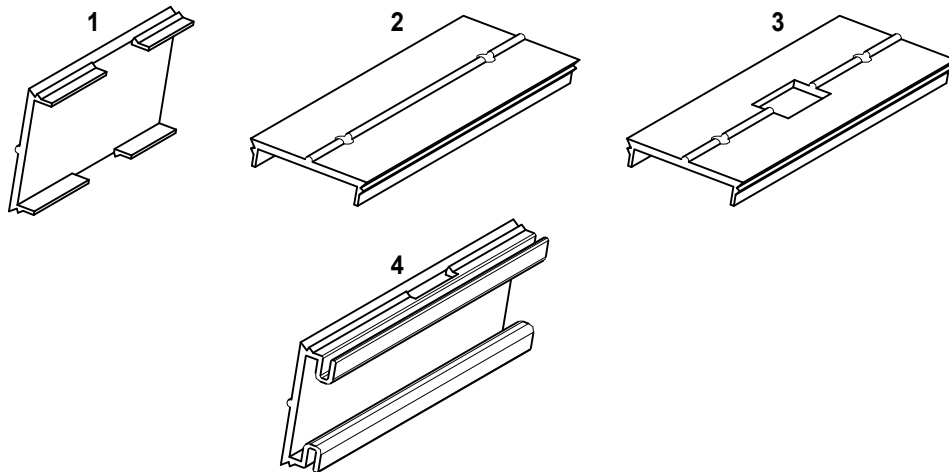



Copyright and ownership of this drawing is vested in EFT, Euro Facade Systems Ltd, whose prior written consent is required for its use, reproduction or for publication to any third party. All other rights reserved.

## Single gasket installation

6

## Fabrication Comar 6EFT

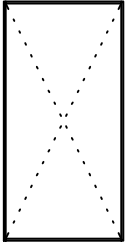

6.31

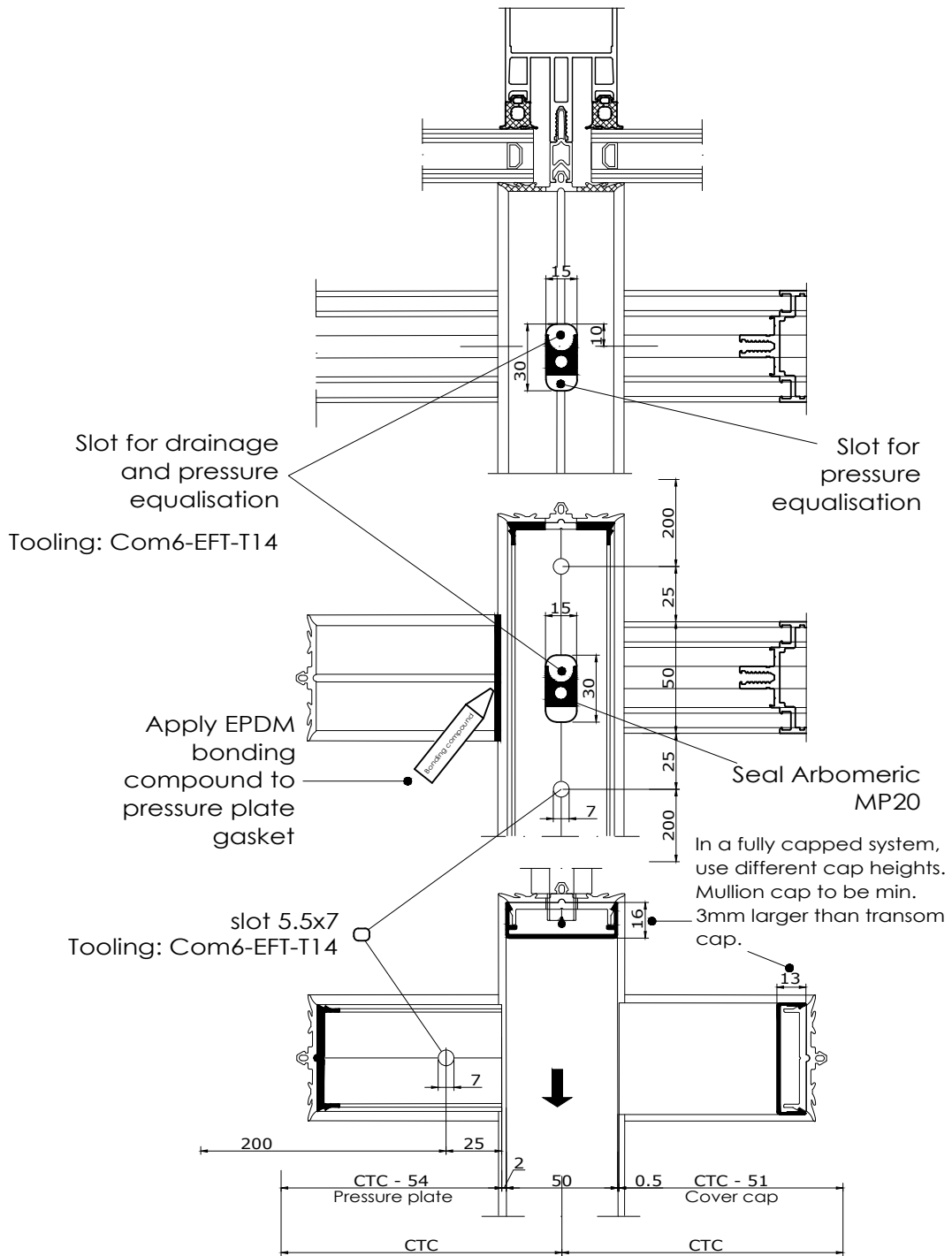

↓  
= thermal expansion

Changes reserved  
Sous reserve de modifications  
Änderungen vorbehalten

Issue: 05  
Date: 10-16

Comar 6EFT

Tooling:  
Punch Com6-EFT-T14

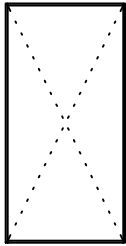

1A. Drainage slots & fixing holes Transom Pressure Plates  
2sided SGH (Two Sided Structural Glazed Horizontal)

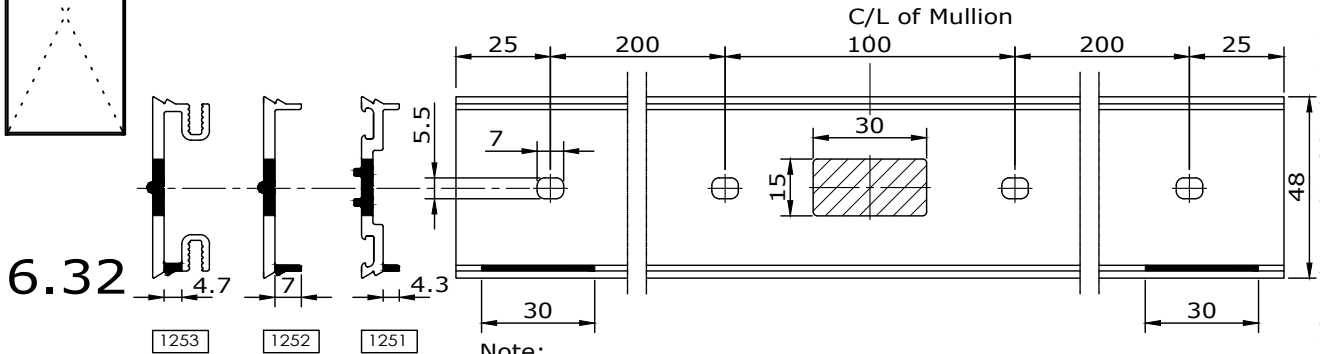

Note:  
Fixing holes to be 25mm from edge and 200mm maximum centres.  
Drainage slots to bottom of pressure plate to be 600mm cts. max.  
30x15 drainage slot required at C/L of mullion positions.

Copyright and ownership of this drawing is vested in EFT, Euro Facade Systems Ltd, whose prior written consent is required for its use, reproduction or for publication to any third party. All other rights reserved. Subject to modifications.

1B. Fixing holes Transom Pressure Plates  
Curtain Walling (Fully Capped Curtain Walling)

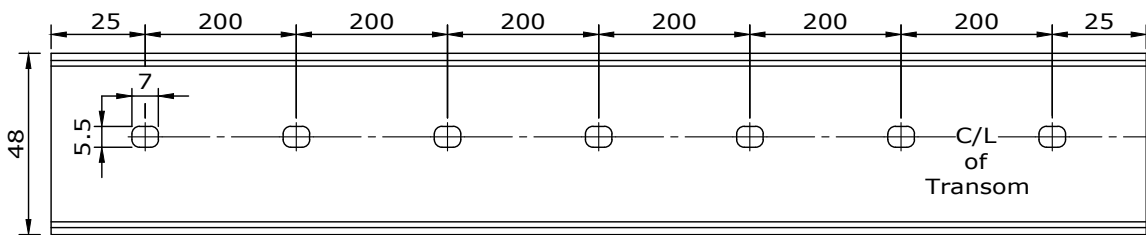

2. Drainage slots Transom Cover Caps  
2sided SGH (Two Sided Structural Glazed Horizontal)

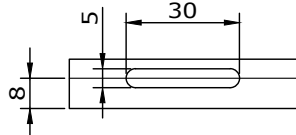
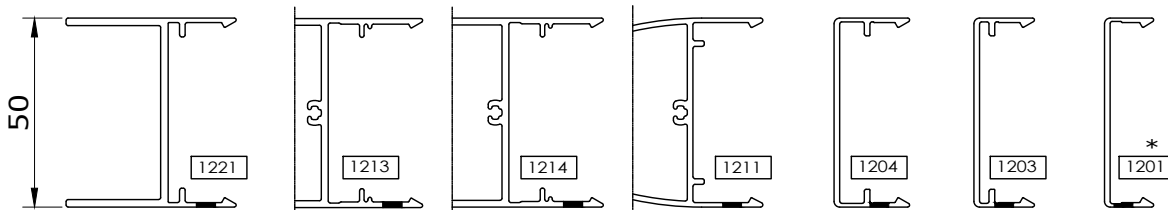

\* Note: To punch drainage slots in profile 1201, a plate must be unscrewed from the Punch tooling which will allow the profile to be positioned correctly

3. Fixing slots transom

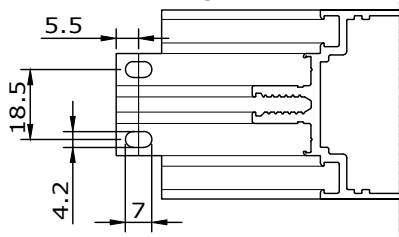

Fabricators Guide



**Tooling:**  
**Punch Com 6-EFT-T14**

**Drainage slots & fixing holes**  
**Mullion Pressure Plates**  
**2sided SGV**  
**Fully Capped Curtain Walling**

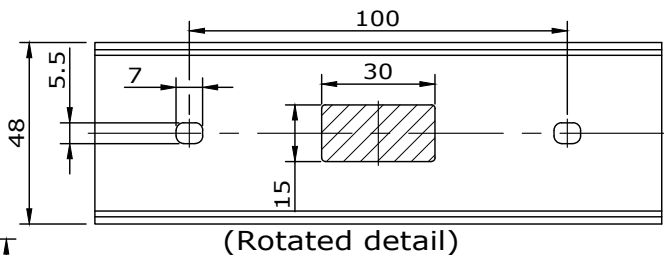
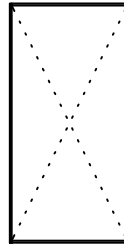

Copyright and ownership of this drawing is vested in EFT, Euro Facade Systems Ltd, whose prior written consent is required for its use, reproduction or for publication to any third party. All other rights reserved.

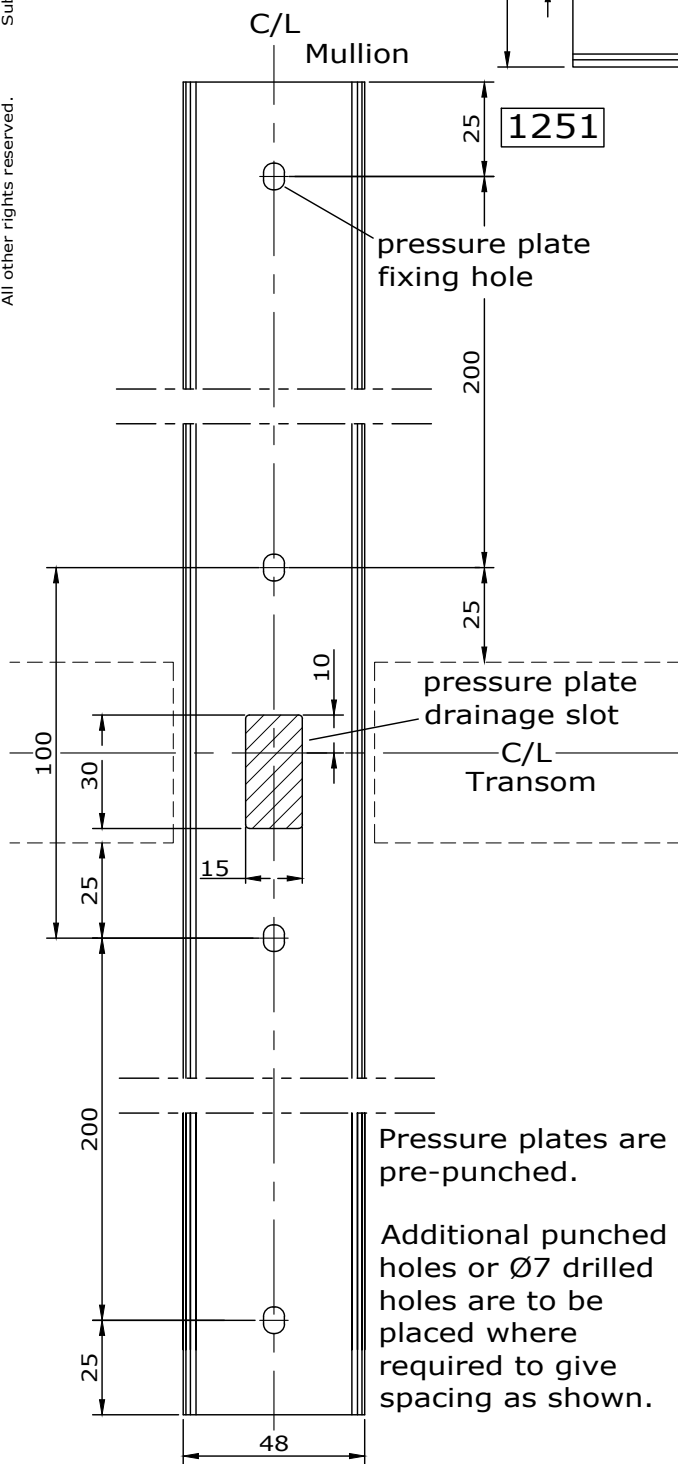

1251



6.33

1252



1253



1260

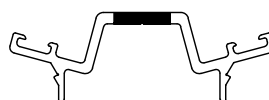

1261

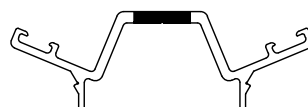

1262

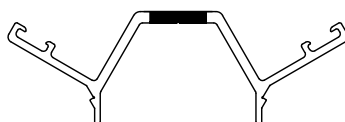

1263

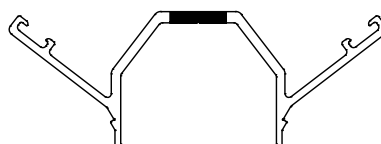

1266

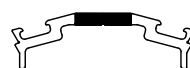

1267



1268

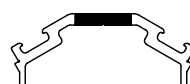

1269

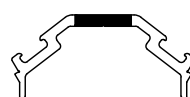

1270

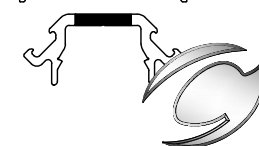

Pressure plates are pre-punched.

Additional punched holes or Ø7 drilled holes are to be placed where required to give spacing as shown.

Changes reserved  
Sous reserve de modifications  
Änderungen vorbehalten

Issue: 05  
Date : 10-16

# Fabrication

# 6

## Comar 6EFT

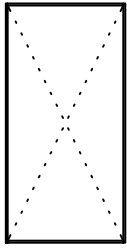

6.34

## Drainage & Ventilation by Individual Window

Fabricators Guide

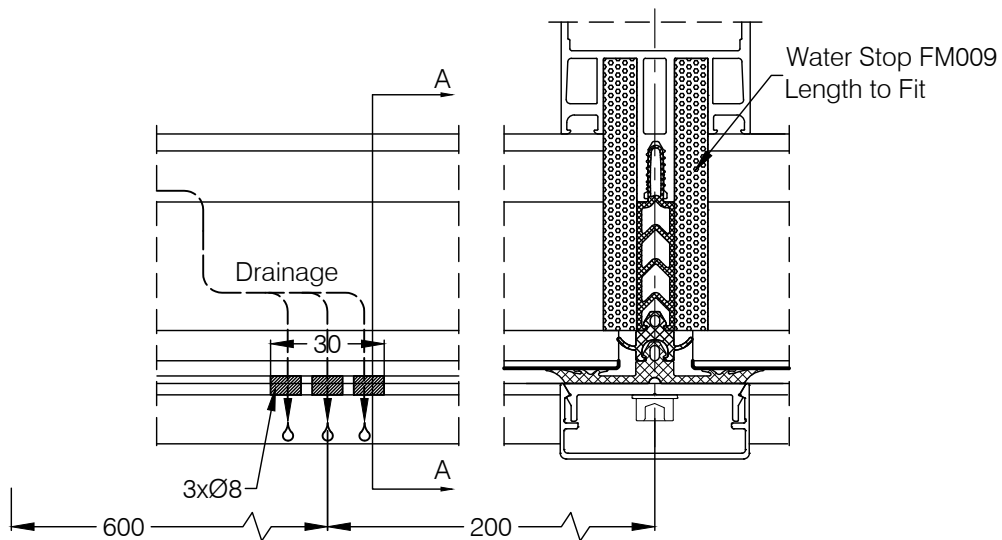
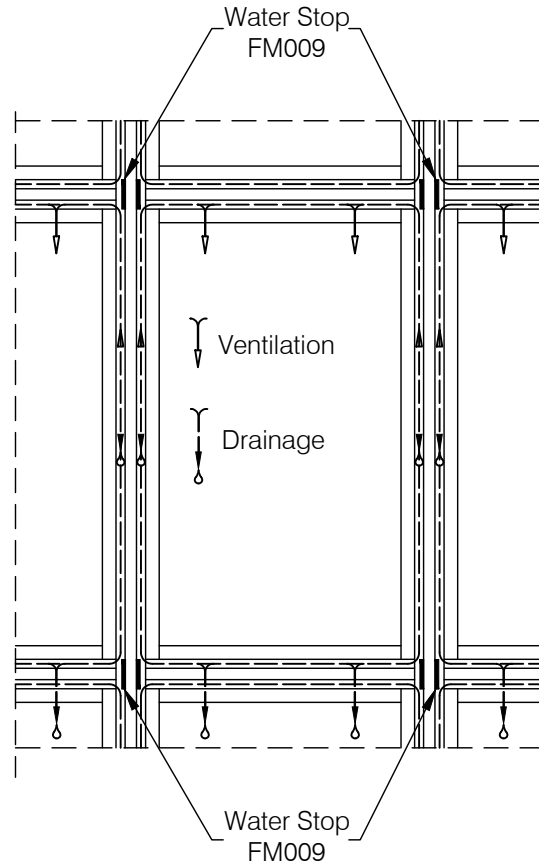
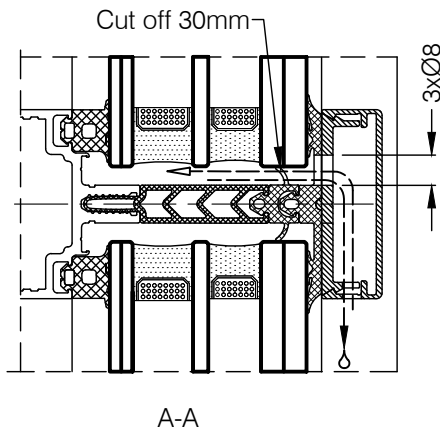
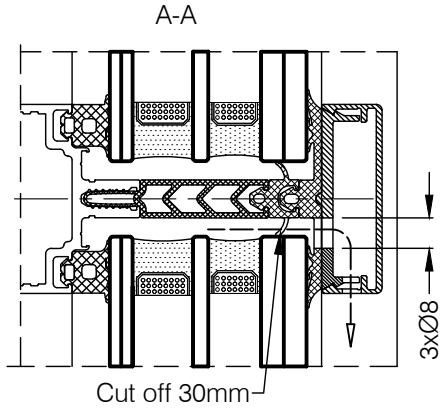

Copyright and ownership of this drawing is vested in EFT, Euro Facade Systems Ltd, whose prior written consent is required for its use, reproduction or for publication to any third party. All other rights reserved. Subject to modifications.



**comar**  
ARCHITECTURAL ALUMINIUM SYSTEMS

Changes reserved  
Sous reserve de modifications  
Änderungen vorbehalten

Issue: 05  
Date: 10-16

Copyright and ownership of this drawing is vested in EFT, Euro Facade Systems Ltd, whose prior written consent is required for its use, reproduction or for publication to any third party. All other rights reserved. Subject to modifications.

6

Fabrication

Draining horizontal

Comar 6EFT

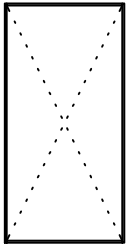
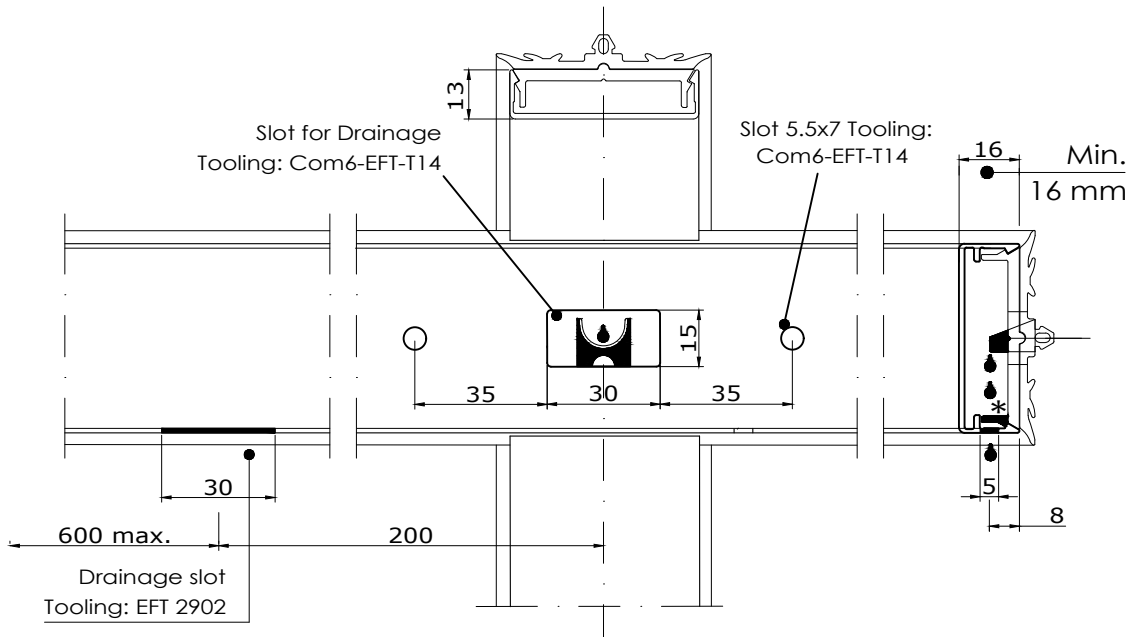

6.35

FIXING LARGE COVER CAPS

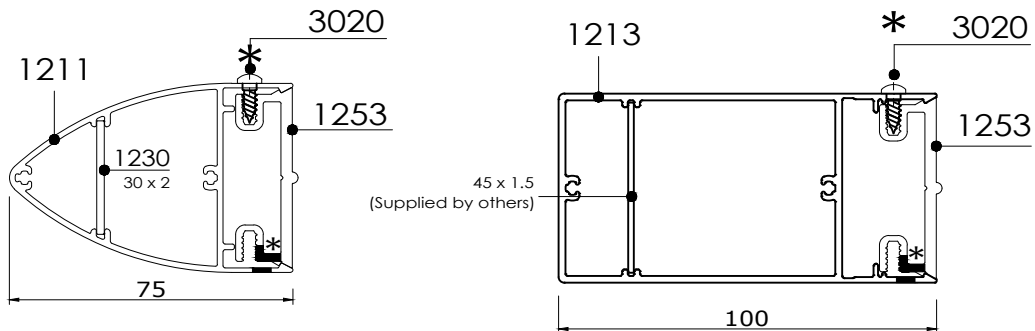

\* Secure large sized cover caps with pan head screw 3020 (3.5x9) e.g. underneath the vertical cover cap. C.T.C 1500mm max.

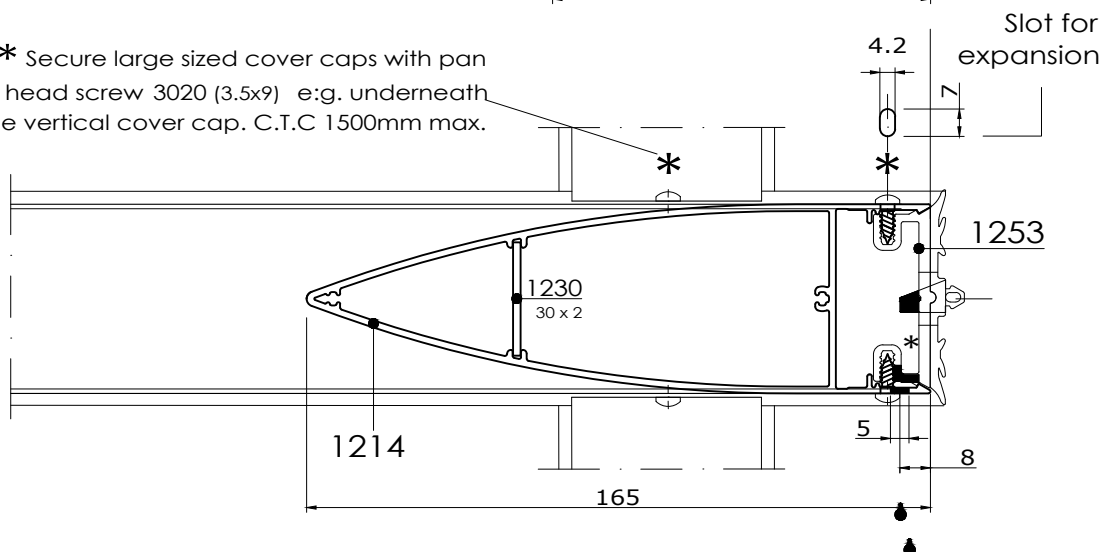

Changes reserved  
 Sous reserve de modifications  
 Änderungen vorbehalten

Issue: 05  
 Date: 10-16

Comar 6EFT

Tooling:  
Punch Com6-EFT-T14

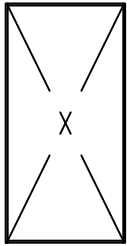

1A. Drainage slots & fixing holes Transom Pressure Plates  
2sided SGH (Two Sided Structural Glazed Horizontal)

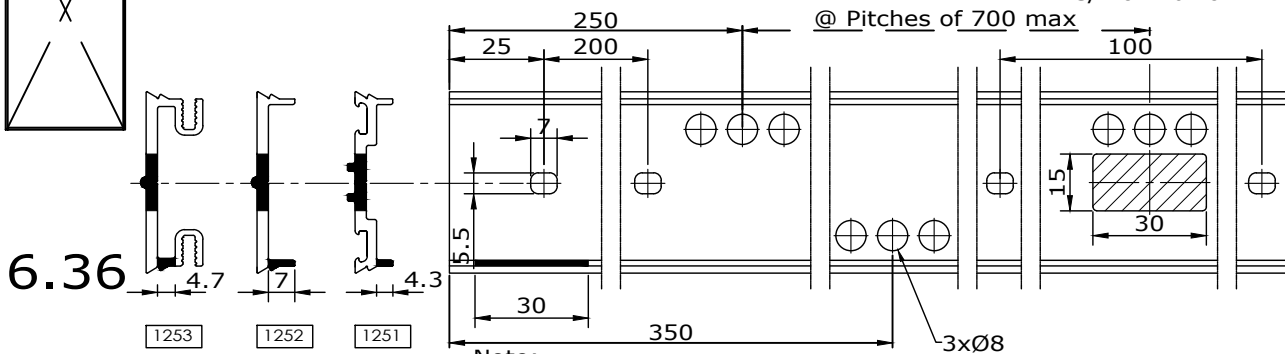

Note:  
Fixing holes to be 25mm from edge and 200mm maximum centres.  
Drainage slots to bottom of pressure plate to be 600mm cts. max.  
30x15 drainage slot required at C/L of mullion positions.

1B. Fixing holes Transom Pressure Plates  
Curtain Walling (Fully Capped Curtain Walling)

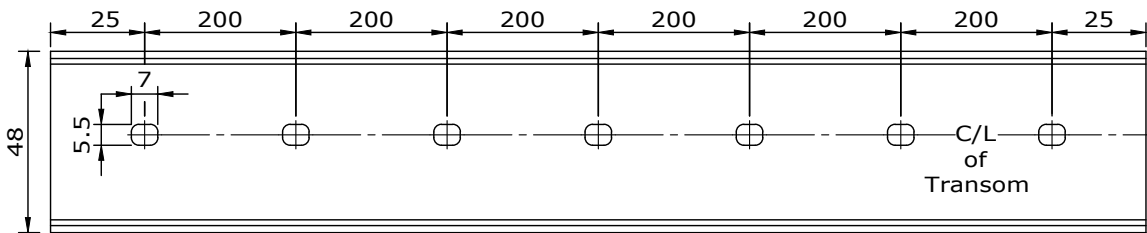

2. Drainage slots Transom Cover Caps  
2sided SGH (Two Sided Structural Glazed Horizontal)

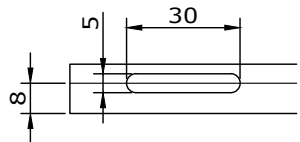
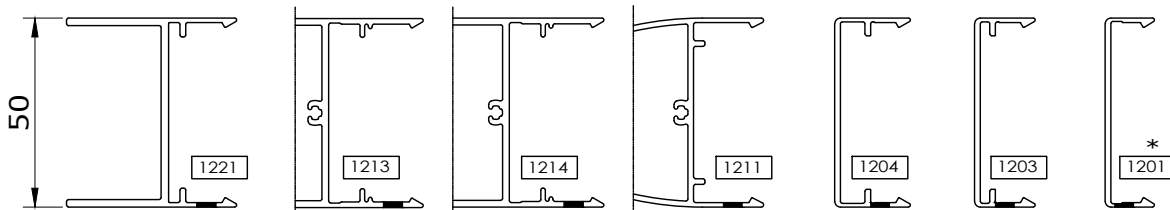

\* Note: To punch drainage slots in profile 1201, a plate must be unscrewed from the Punch tooling which will allow the profile to be positioned correctly

3. Fixing slots transom

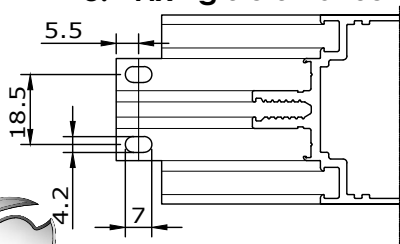

Fabricators Guide

Copyright and ownership of this drawing is vested in EFT, Euro Facade Systems Ltd, whose prior written consent is required for its use, reproduction or for publication to any third party. All other rights reserved. Subject to modifications.

Panel & Single glazed frames

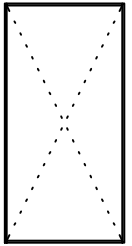

Profiles 1335 & 1346 to be cut to same dimensions as glass or panel

Between capped mullions/transoms: C.T.C - 22

Between structural glazing mullions/transoms: C.T.C - 20

Copyright and ownership of this drawing is vested in EFT, Euro Facade Systems Ltd, whose prior written consent is required for its use, reproduction or for publication to any third party. All other rights reserved.

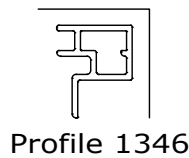

Profile 1346

1346 between structural glazed joints when panels are required

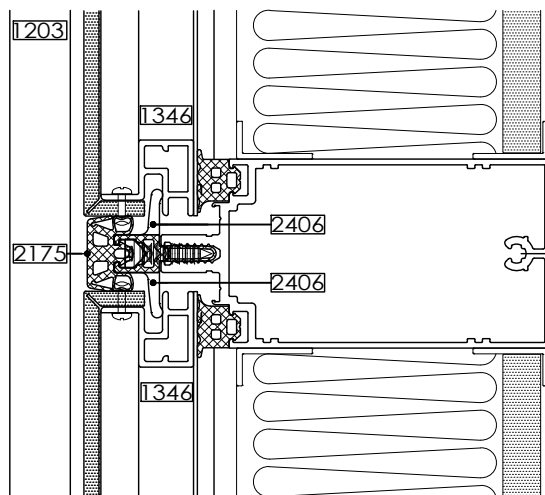

EFT - 2539 Corner Cleat  
EFT - 1346

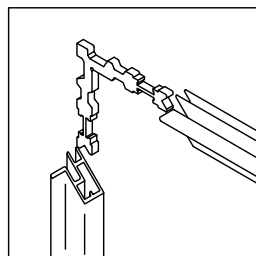

Frame lengths of 1346 to be mitred at 45° and crimped together using cleat 2539

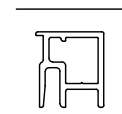

Profile 1335

1335 between capped joints when glazing joints are required

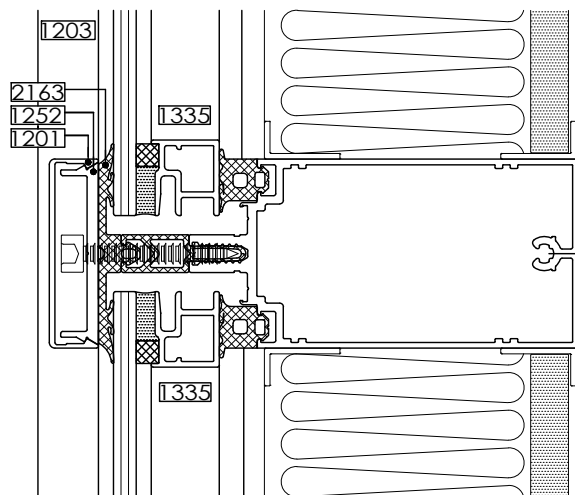

EFT - 2538 Corner Cleat  
EFT - 1335

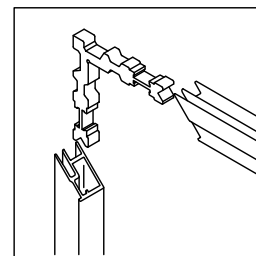

Frame lengths of 1335 to be mitred at 45° and crimped together using cleat 2538

C.T.C - 20

C.T.C - 22

6.37

Changes reserved  
Sous reserve de modifications  
Änderungen vorbehalten

Issue: 05  
Date: 10-16

# Fabrication

# 6

## Comar 6EFT

## Glass inserts

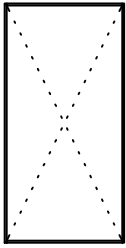

6.38

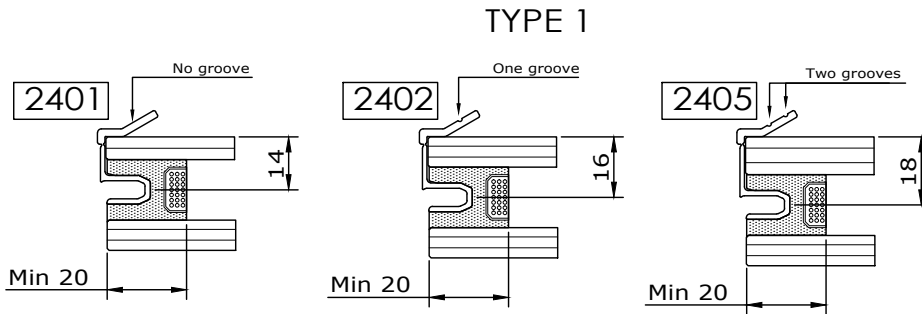

The Min.20mm to be set by your glass supplier according to standards and calculation.

1 Placing insert into spacer bar

2 Removing snap off leg & gasket

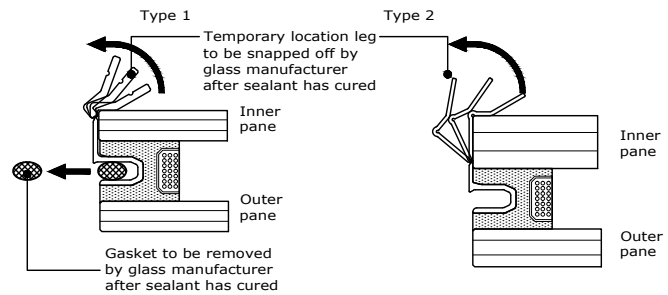
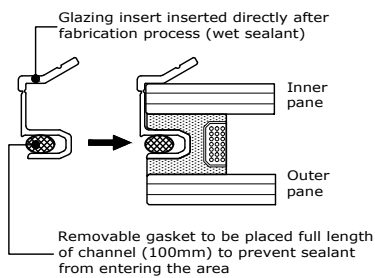

### TYPE 2

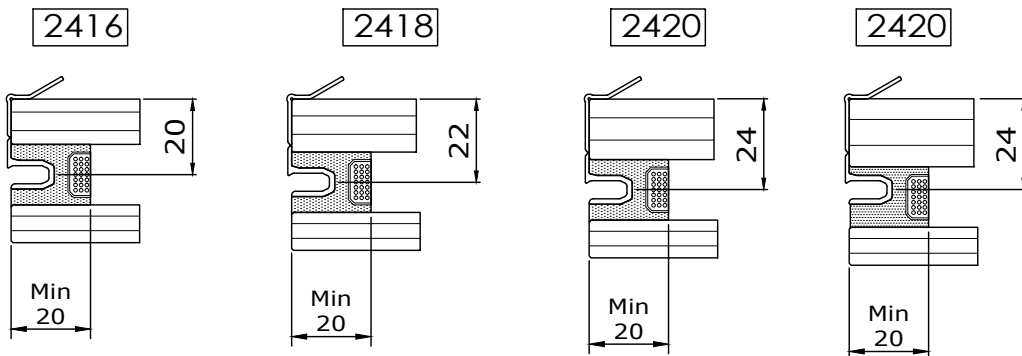

The Min.20mm to be set by your glass supplier according to standards and calculation.



6

Fabrication

Comar 6EFT

### Location of glazing inserts

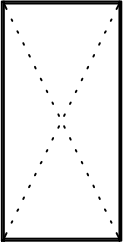

6.39

Fabricators Guide

Copyright and ownership of this drawing is vested in EFT, Euro Facade Systems Ltd, whose prior written consent is required for its use, reproduction or for publication to any third party. All other rights reserved. Subject to modifications.

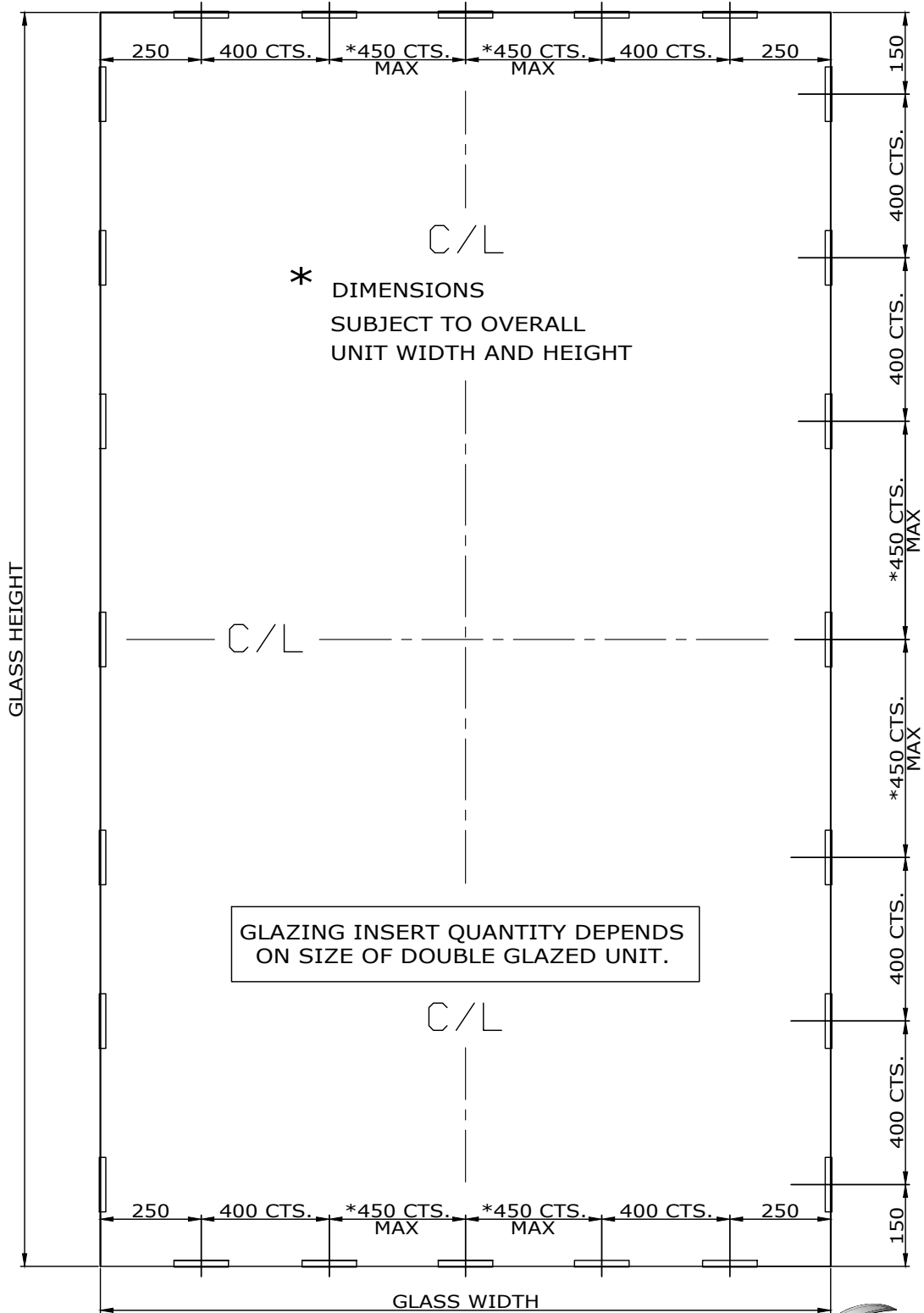

Changes reserved  
Sous reserve de modifications  
Änderungen vorbehalten

Issue: 05  
Date: 10-16

# Fabrication

6

## Comar 6EFT

## Drainage diverter & 1345 profile preparation

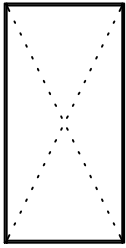

6.40

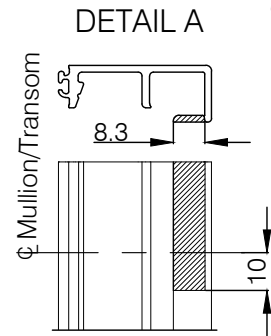
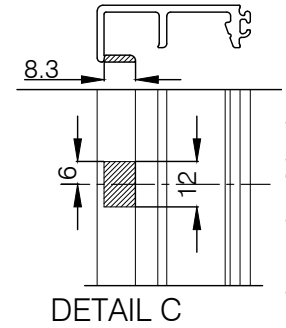
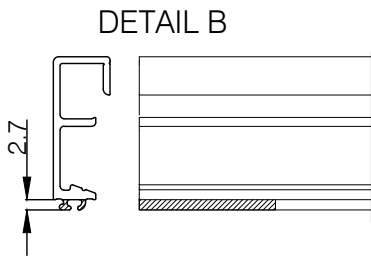
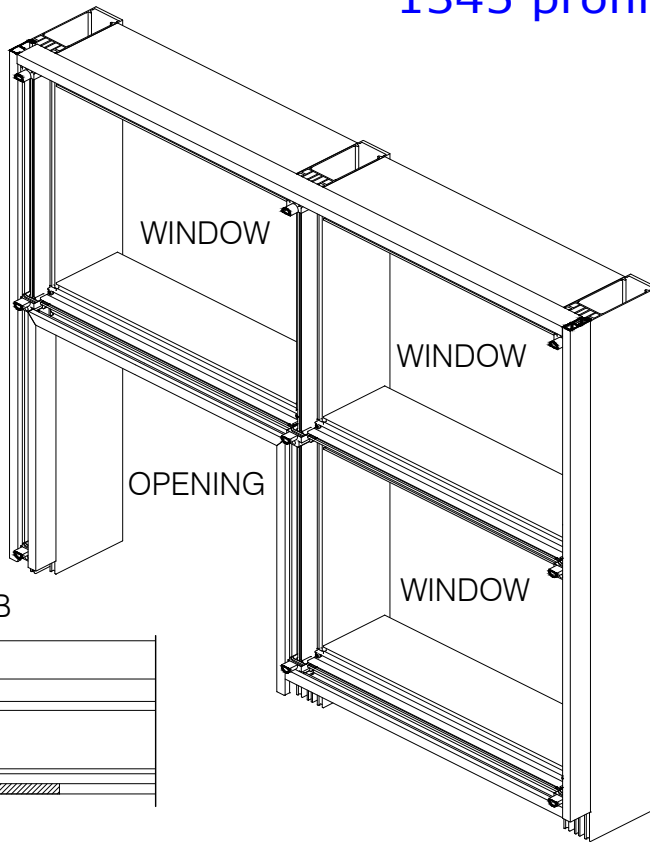

Copyright and ownership of this drawing is vested in EFT, Euro Facade Systems Ltd, whose prior written consent is required for its use, reproduction or for publication to any third party. All other rights reserved. Subject to modifications.

Fabricators Guide

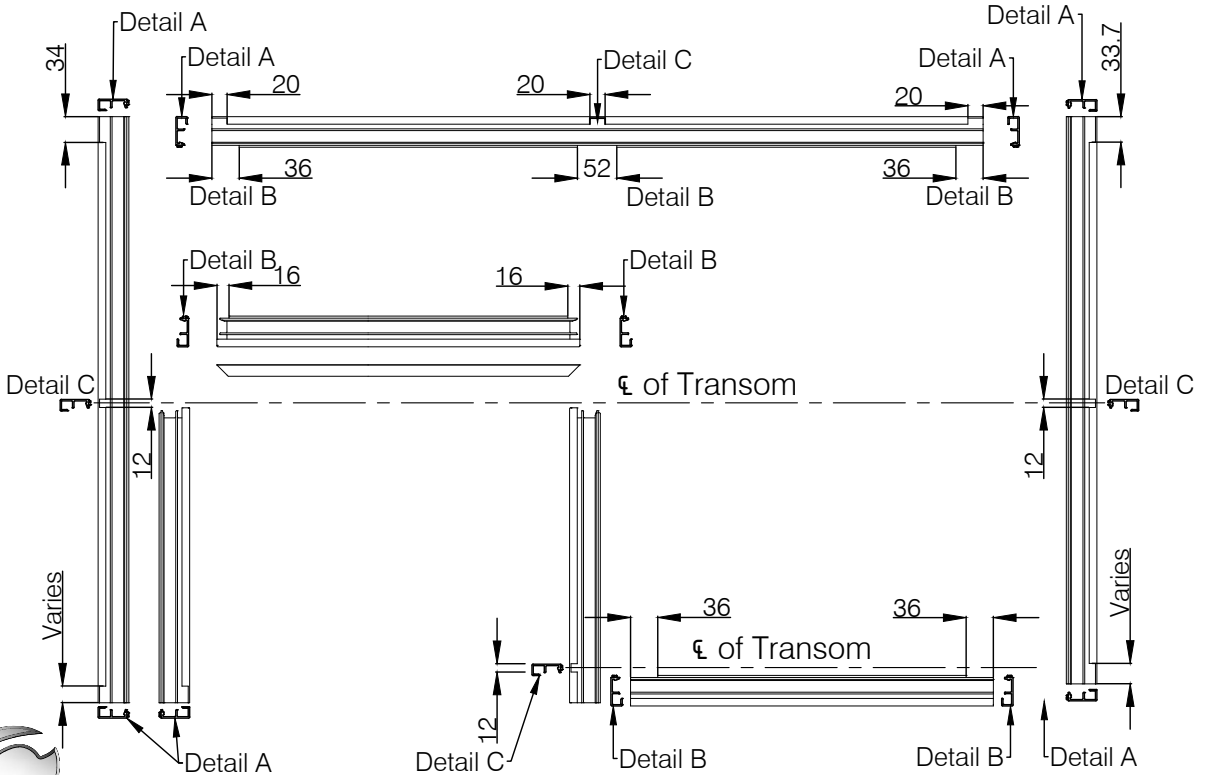

## Mullion sleeve plate 1087- 225mm & 1090- 275mm

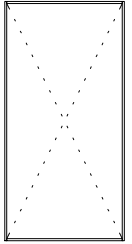

Mullion number	Dim A
1087	48
1090	98

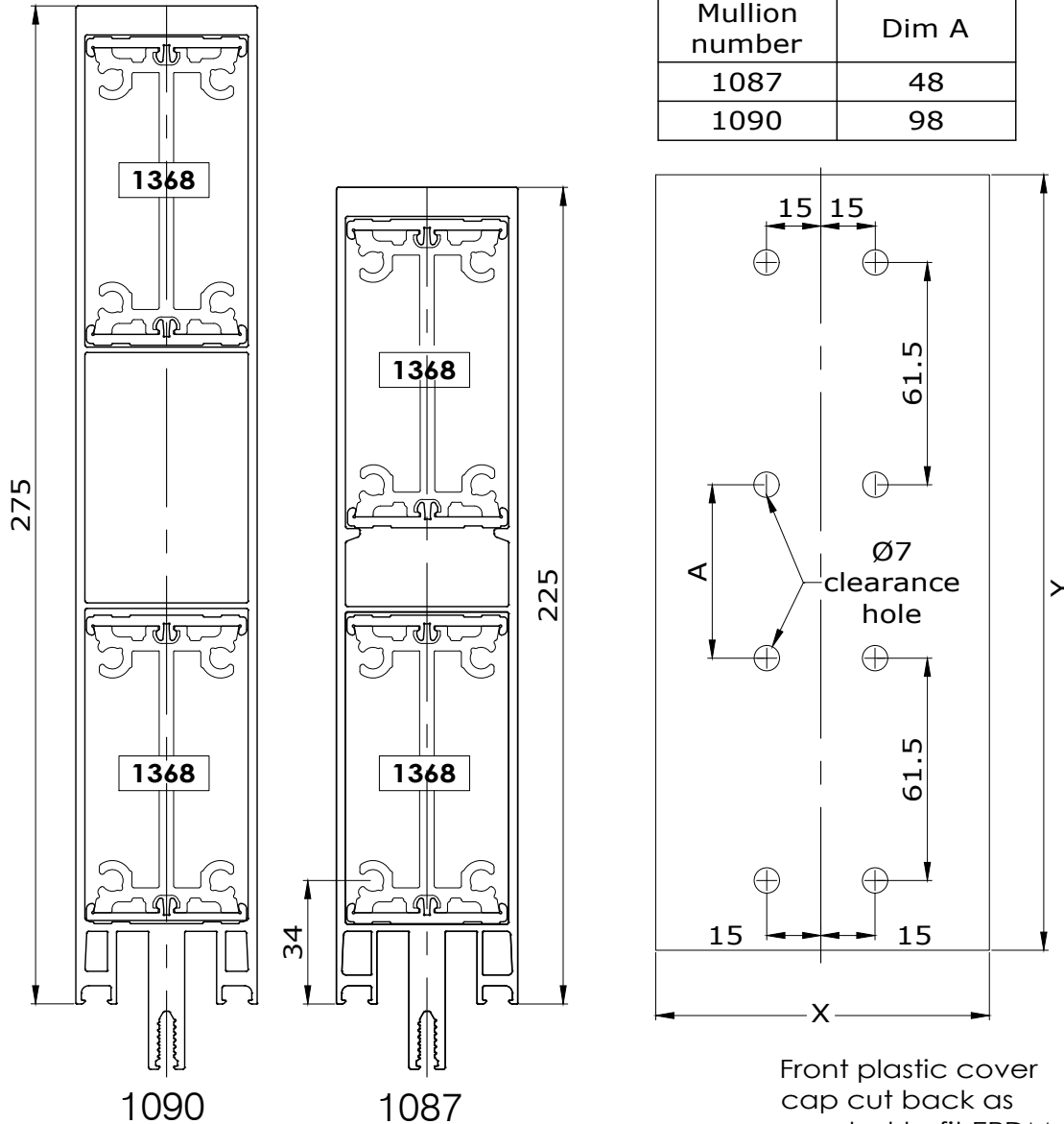

6.41

Fabricators Guide

Front plastic cover cap cut back as needed to fit EPDM

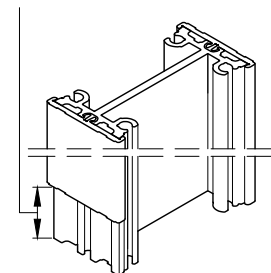

Plate supplied by others

Use Ø6.3mm number 14 x 25mm self tapping screw, countersunk (supplied by others) or plate can be welded.

Length & width of plate and anchor bolts to be determined by site conditions and to structural engineers specification.

Changes reserved  
Sous reserve de modifications  
Änderungen vorbehalten

Issue: 05  
Date: 04-17

# Fabrication

# 6

## Comar 6EFT

## Mullion shoe bracket

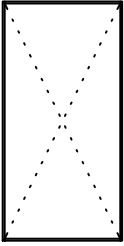

6.42

Mullion number	Size "Y" of Bracket	
	Bottom	Top
1070, 1072	36mm	39mm
1069, 1073 1074, 1075 1076	82mm	85mm
1077, 1080 1082, 1085	36mm 82mm	39mm 85mm
1087, 1090	2x 82mm	2x 85mm

Copyright and ownership of this drawing is vested in EFT, Euro Facade Systems Ltd, whose prior written consent is required for its use, reproduction or for publication to any third party. All other rights reserved. Subject to modifications.

Fabricators Guide

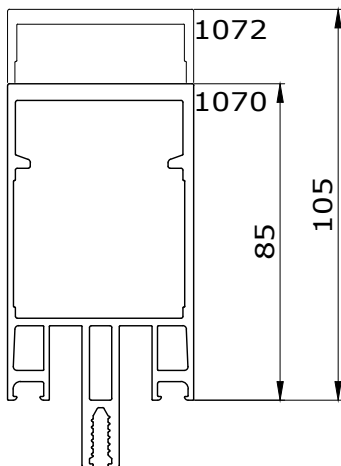
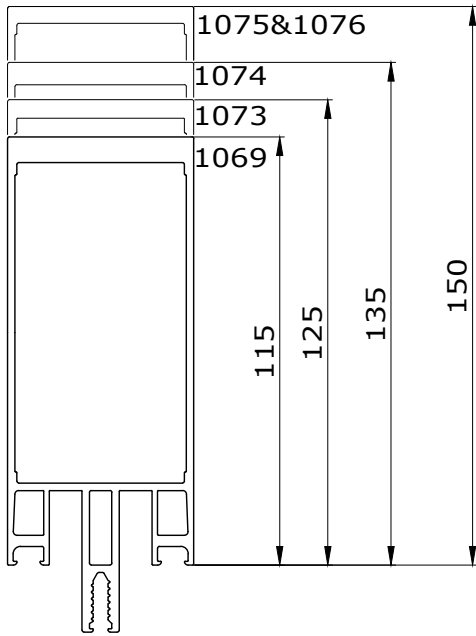

\*Size of anchor bolts to be determined by site conditions and to structural engineers specification.

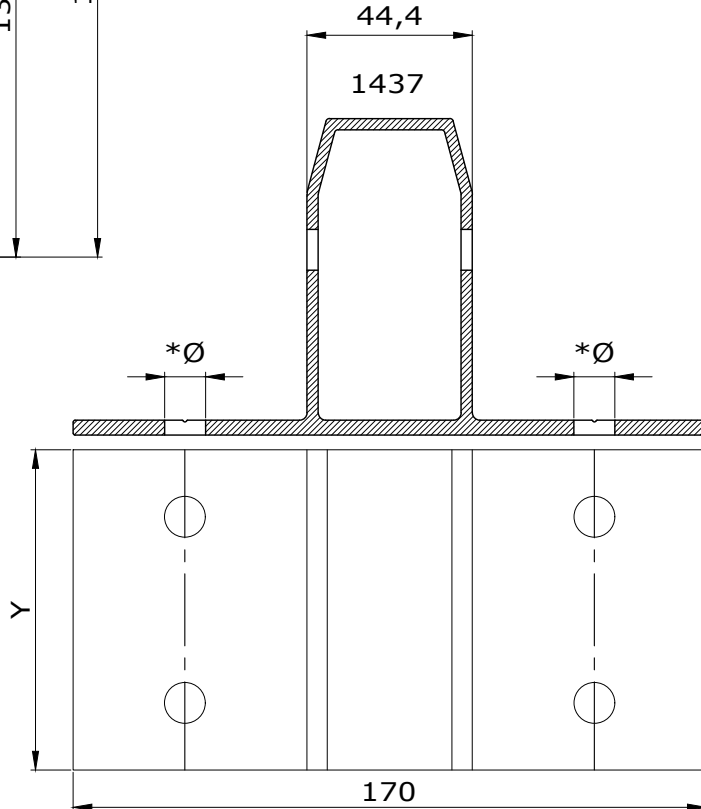

# Mullion 1087 & 1090 Preparation

Copyright and ownership of this drawing is vested in EFT, Euro Facade Systems Ltd, whose prior written consent is required for its use, reproduction or for publication to any third party. All other rights reserved. Subject to modifications.

**NOTE:**  
For transoms larger than 225mm, mullion preps must be CNC cut.

Transoms installed in between ladders

Ladder / unit

**EFT 2310**

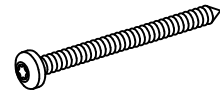
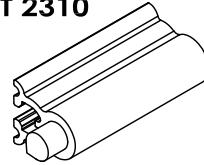

**3022 (4.8 x 65)**

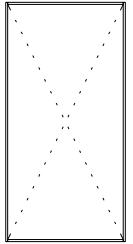

6.43

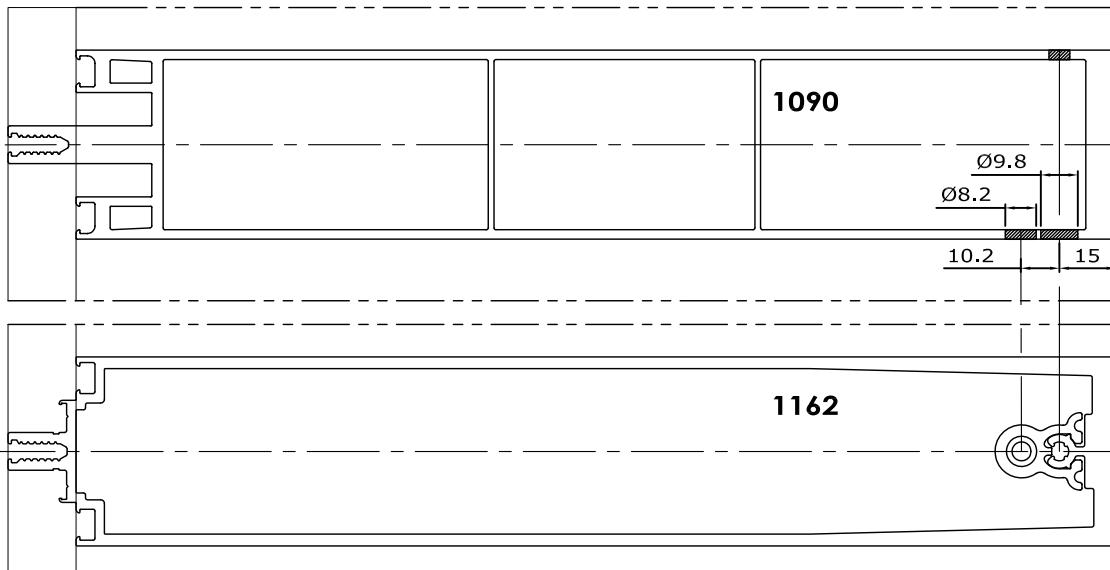
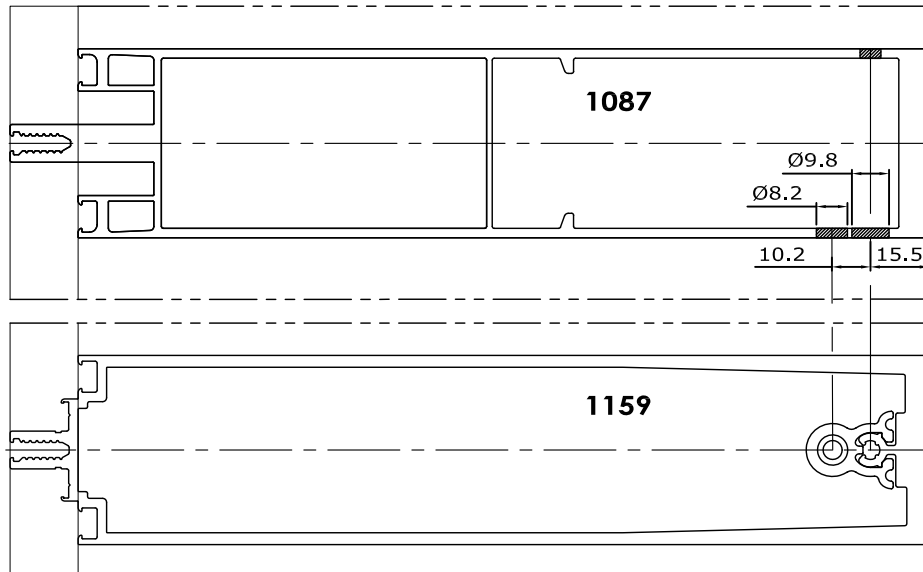

Fabricators Guide

Changes reserved  
Sous reserve de modifications  
Änderungen vorbehalten

Issue: 05  
Date: 02-18

# Installation

# 6

## Comar 6EFT

## Mullion - Transom Connection

**Option: 5 Glass weight max 450 kg**

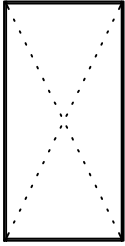

6.44

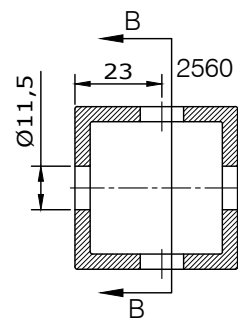
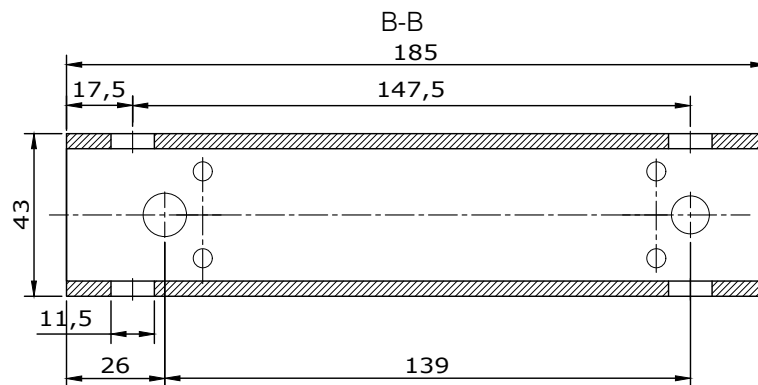
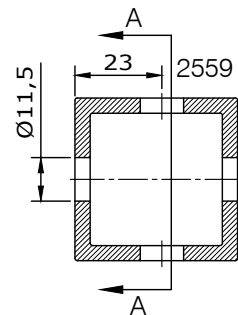
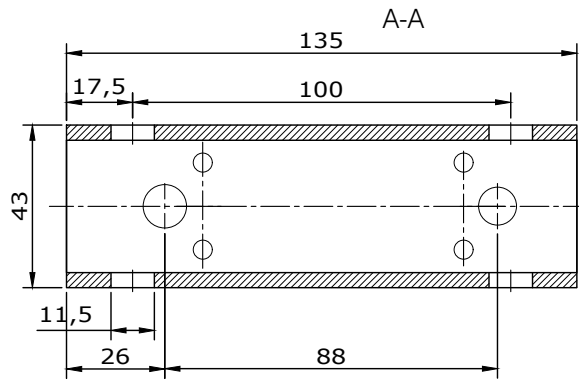
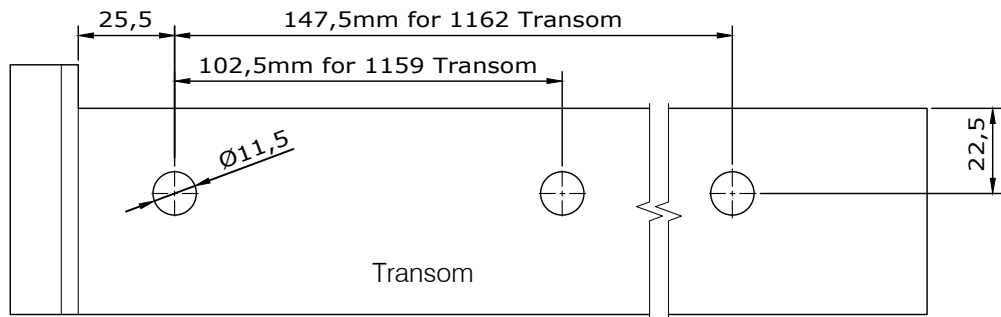
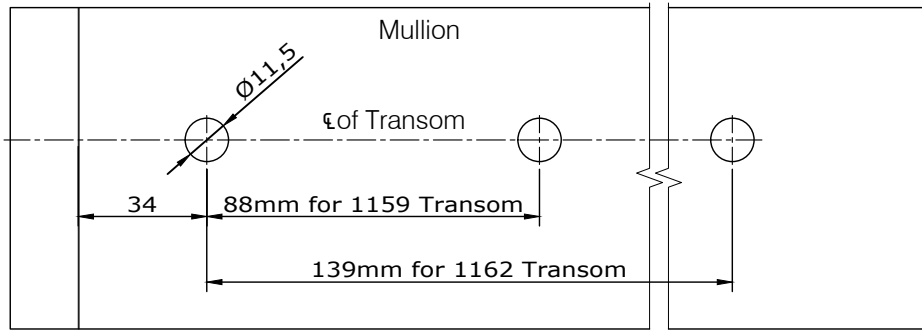

Fabricators Guide

Copyright and ownership of this drawing is vested in EFT, Euro Facade Systems Ltd, whose prior written consent is required for its use, reproduction or for publication to any third party. All other rights reserved. Subject to modifications.



**comar**  
ARCHITECTURAL ALUMINIUM SYSTEMS

Changes reserved  
Sous reserve de modifications  
Änderungen vorbehalten

Issue: 05  
Date : 04-17