

CAPTIVE GASKET ref.	GASKET VALUE M/M	MAX M/M			WEDGE VALUE M/M	WEDGE INSERT ref.
GK425	5	14	13		5 - 7	GK906
GK425	5	13	12	11	7 - 9	GK908
GK425	5	11	10	9	9 - 11	GK910
		MIN M/M				

OUTSIDE

INSIDE

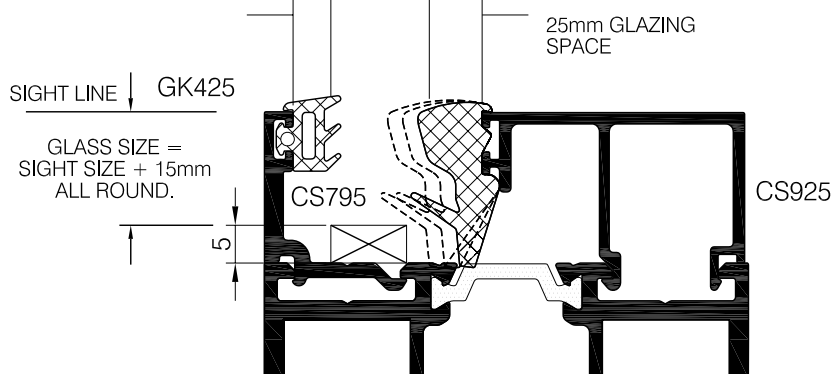

DOUBLE GLAZED DOOR SYSTEM
WITH SQUARE BEAD.

ORDER OF ASSEMBLY:-

1. BEAD CS795.
2. CAPTIVE GASKET.
3. GLASS OR PANEL.
4. CS925-926 SQUARE BEAD.
5. INSERT WEDGE GASKET.

CAPTIVE GASKET ref.	GASKET VALUE M/M	MAX M/M			WEDGE VALUE M/M	WEDGE INSERT ref.
GK425	5	20	19		5 - 7	GK906
GK425	5	19	18	17	7 - 9	GK908
GK425	5	17	16	15	9 - 11	GK910
		MIN M/M				

OUTSIDE

INSIDE

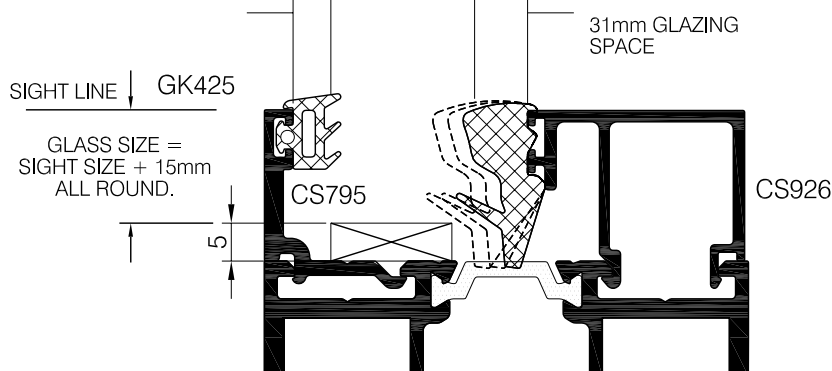

TO ENSURE SATISFACTORY
PRODUCT PERFORMANCE,
BOTTOM CORNERS AND
INTERNAL GASKET CORNER
JOINTS SHOULD BE
SILICONE SEALED.

IMPORTANT NOTE

DUE TO PRODUCTION TOLERANCES IN
ALUMINIUM, PAINTING/ANODISING,
GLASS AND GASKETS, CHECK AND
TRIAL ABOVE FORMULAE BEFORE
PROCEEDING WITH BULK PRODUCTION.



CAPTIVE GASKET ref.	GASKET VALUE M/M	MAX M/M			WEDGE VALUE M/M	WEDGE INSERT ref.
GK425	5	26	25		5 - 7	GK906
GK425	5	25	24	23	7 - 9	GK908
GK425	5	23	22	21	9 - 11	GK910
		MIN M/M				

OUTSIDE

INSIDE

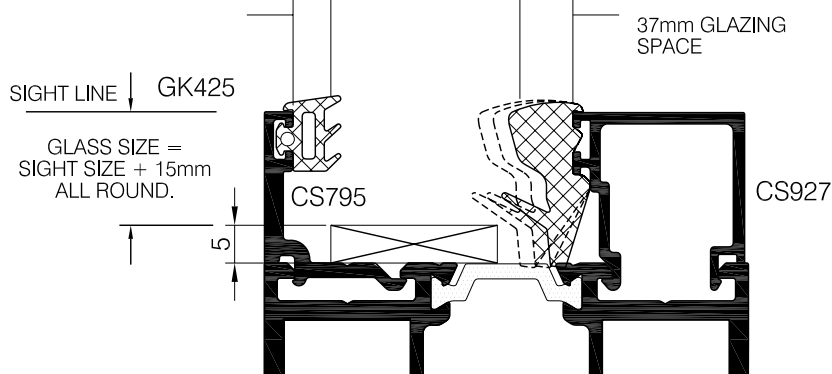

DOUBLE GLAZED DOOR SYSTEM
WITH SQUARE BEAD.

ORDER OF ASSEMBLY:-

1. BEAD CS795.
2. CAPTIVE GASKET.
3. GLASS OR PANEL.
4. CS927-928 SQUARE BEAD.
5. INSERT WEDGE GASKET.

CAPTIVE GASKET ref.	GASKET VALUE M/M	MAX M/M			WEDGE VALUE M/M	WEDGE INSERT ref.
GK425	5	32	31		5 - 7	GK906
GK425	5	31	30	29	7 - 9	GK908
GK425	5	29	28	27	9 - 11	GK910
		MIN M/M				

OUTSIDE

INSIDE

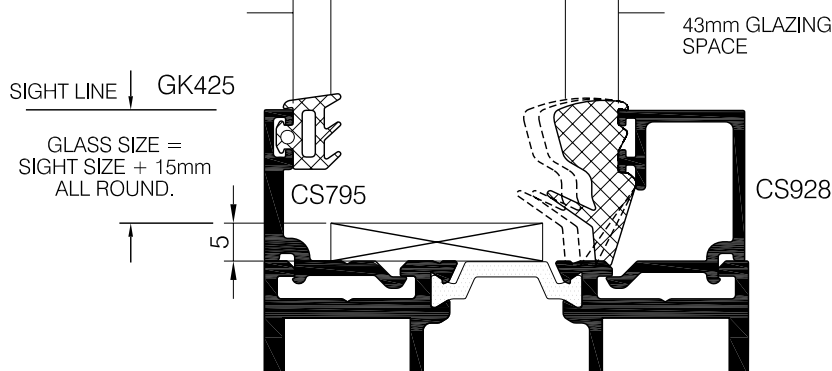

TO ENSURE SATISFACTORY
PRODUCT PERFORMANCE,
BOTTOM CORNERS AND
INTERNAL GASKET CORNER
JOINTS SHOULD BE
SILICONE SEALED.

IMPORTANT NOTE

DUE TO PRODUCTION TOLERANCES IN
ALUMINIUM, PAINTING/ANODISING,
GLASS AND GASKETS, CHECK AND
TRIAL ABOVE FORMULAE BEFORE
PROCEEDING WITH BULK PRODUCTION.



CAPTIVE GASKET ref.	GASKET VALUE M/M	MAX M/M			WEDGE VALUE M/M	WEDGE INSERT ref.
GK425	5	45	44	43	5 - 7	GK906
GK425	5	43	42	41	7 - 9	GK908
GK425	5	41	40	39	9 - 11	GK910
		MIN M/M				

OUTSIDE

INSIDE

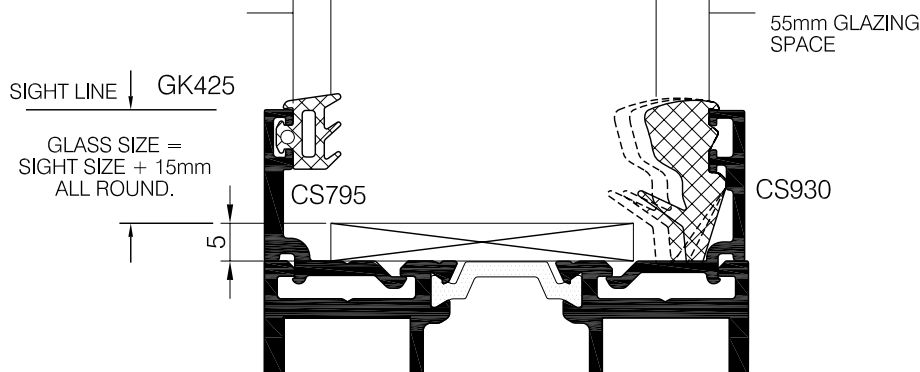

DOUBLE GLAZED DOOR SYSTEM
WITH SQUARE BEAD.

ORDER OF ASSEMBLY:-

1. BEAD CS795.
2. CAPTIVE GASKET.
3. GLASS OR PANEL.
4. CS929-930 SQUARE BEAD.
5. INSERT WEDGE GASKET.

CAPTIVE GASKET ref.	GASKET VALUE M/M	MAX M/M			WEDGE VALUE M/M	WEDGE INSERT ref.
GK425	5	38	37		5 - 7	GK906
GK425	5	37	36	35	7 - 9	GK908
GK425	5	35	34	33	9 - 11	GK910
		MIN M/M				

OUTSIDE

INSIDE

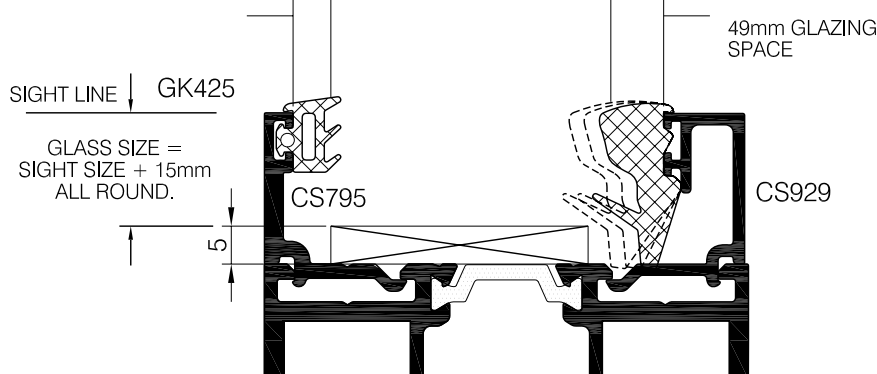

TO ENSURE SATISFACTORY
PRODUCT PERFORMANCE,
BOTTOM CORNERS AND
INTERNAL GASKET CORNER
JOINTS SHOULD BE
SILICONE SEALED.

IMPORTANT NOTE

DUE TO PRODUCTION TOLERANCES IN
ALUMINIUM, PAINTING/ANODISING,
GLASS AND GASKETS, CHECK AND
TRIAL ABOVE FORMULAE BEFORE
PROCEEDING WITH BULK PRODUCTION.



SECURELY GLAZED DOOR SYSTEM
WITH SQUARE BEAD.

ORDER OF ASSEMBLY:-

1. FIX & SECURE CS796 OUTSIDE BEAD USING PRESCRIBED SCREW.
2. FIT SECURITY TAPE SE003 TO CS796.
3. FIT GLASS & PRESS AGAINST PROFILE.
4. FIT CS797 & PRESS HARD & SECURE USING PRESCRIBED SCREWS.
5. INSERT CAPTIVE GASKET.
6. FIT CS798 SECURITY BEAD COVER IN PLACE.

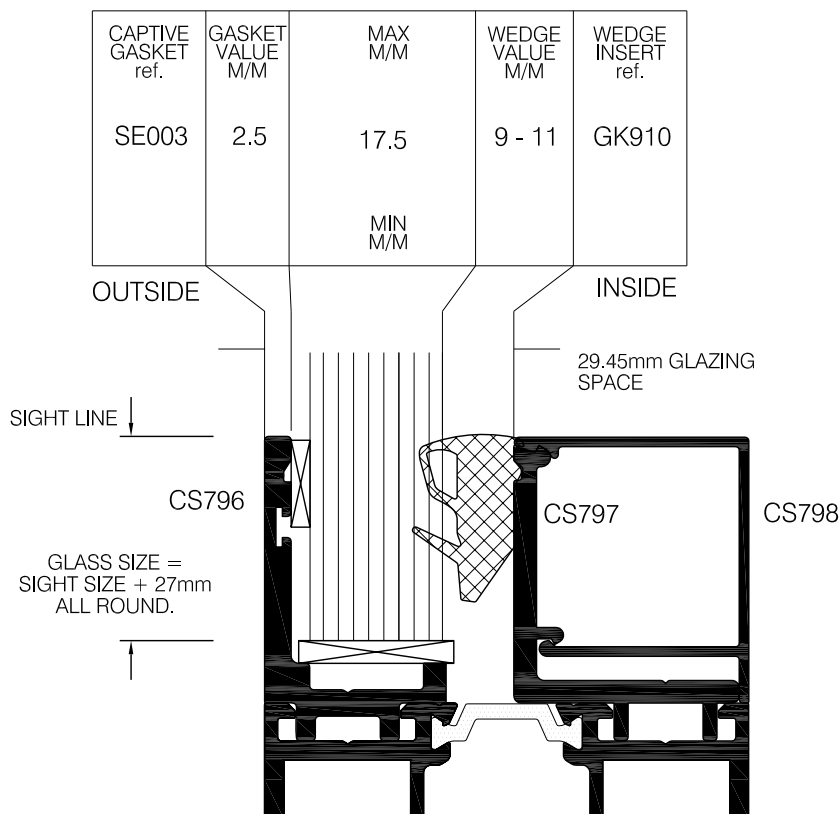

TO ENSURE SATISFACTORY
PRODUCT PERFORMANCE,
BOTTOM CORNERS AND
INTERNAL GASKET CORNER
JOINTS SHOULD BE
SILICONE SEALED.

IMPORTANT NOTE

DUE TO PRODUCTION TOLERANCES IN
ALUMINIUM, PAINTING/ANODISING,
GLASS AND GASKETS, CHECK AND
TRIAL ABOVE FORMULAE BEFORE
PROCEEDING WITH BULK PRODUCTION.

