



## CONTENTS

### COMAR 7P./ COMMERCIAL DOOR

#### PART 1 INTRODUCTION / SPECIFICATION / BROADSHEETS

Introduction . . . . .	Page No. 1.01
System Specification . . . . .	1.02
Broadsheet Profiles . . . . .	1.03-1.04
Broadsheet Ancillaries . . . . .	1.05-1.06
Size Limitations . . . . .	1.07
Lock and Mid Rail Position . . . . .	1.08
Bead Screw Positions . . . . .	1.09
Working Drawing . . . . .	1.10-1.11
Fixing Details to Structure . . . . .	1.12

#### PART 2 FULL SIZE SECTIONS

Threshold Details . . . . .	2.01 - 2.02
Head Details . . . . .	2.03 - 2.04
Auto Door Head Details . . . . .	2.05
Jamb Details . . . . .	2.06 - 2.09
Meeting Stile Details. . . . .	2.10 - 2.11
Midrail Details . . . . .	2.12 - 2.13

#### PART 3 FABRICATION

Cutting Lists . . . . .	3.01 - 3.08
Assembly Details . . . . .	3.09 - 3.12
Header Bar/Plate Preparation Details. . . . .	3.13
Top & Bottom Preparation Details . . . . .	3.14
Concealed Closer Preparation Details . . . . .	3.15 - 3.17
Threshold Preparation . . . . .	3.18
Lock Preparation . . . . .	3.19 - 3.23
Flush Bolt Preparation . . . . .	3.24 - 3.25
Cleat Assembly & Preparation . . . . .	3.26 - 3.27
MidRail Preparation . . . . .	3.28
Keep Details . . . . .	3.29
Bead Preparation . . . . .	3.30

#### PART 4 GLAZING

Standard Option . . . . .	4.01 - 4.03
Security Option . . . . .	4.04



## INTRODUCTION

### COMAR 7P./ COMMERCIAL DOOR

Exhibits the highest standards of design appeal, high strength and durability for today's more security conscious market and demonstrates a continuation of Comar's innovative approach to the design of Architectural Aluminium products.

The specific choice door profiles and ancillary equipment is designed for fabricators to meet the requirements of the latest Building Regulations, the Disability Discrimination Act and is tested to PAS24 BS/EN 1627-RC3 with two security locks (both engaged)

Profiles are thermally broken with 'rolled in' polyamide profiles, to deliver an improved thermal performance.

This allows specifiers to deliver a high performance door to the security conscious discerning customer.

The door can integrate with all Comar systems and allows for flexibility of design on projects in the commercial market.

A minimum door leaf size of width 600mm x height 1800mm per door  
A maximum door leaf size of width 1096mm x height 2272mm per door

All technical aspects of the range are covered in the product manual and further information is available from Comar's Technical Department for specific contract requirements.

This manual is copyright and ownership is vested in Comar Architectural Aluminium Systems whose prior written consent is required for its use.

The manual reproduction or publication to any third party that is not authorised in writing by Comar Architectural Aluminium Systems is strictly forbidden.

Telephone : 020 8685 9685  
Fax No: 020 8646 5096  
e-mail: [technical@parksidegroup.co.uk](mailto:technical@parksidegroup.co.uk)  
Web Site: <http://www.comar-alu.co.uk>

Registered number: 921619.

Registered office: The Parkside Group Ltd  
Unit 5, The Willow Centre.  
17 Willow Lane. MITCHAM.  
Surrey. CR4 4NX UK



## **SPECIFICATION**

### **COMAR 7P./ COMMERCIAL DOOR**

Exhibits the highest standards of design appeal, strength and durability for today's security conscious commercial market.

#### **MATERIALS**

Aluminium alloy extruded profiles of 6063 T5 or T6 to BS EN 755 and BS EN 12020.

#### **FINISHES**

Aluminium profiles are finished to the following specifications:  
Silver, Bronze and Black anodising to BS EN 12373-1:2001 or BS 3987  
Liquid organic coating to BS 4842 or Polyester powder coating to BS 6496

#### **CONSTRUCTION**

Rails are square cut and design of stiles makes an almost invisible joint.  
Stiles incorporate twin woolpile grooves to by-pass the lock.  
A secure profile concealed under the door houses twin brush seals providing double weathering and draught proofing around the perimeter of the door. Low ramp drained or thermally broken thresholds are available.

#### **GLAZING**

The standard option uses a wide range of glazing beads and gaskets allow for a choice of glazing thickness from 9mm to 45mm.  
The security option Glass to be used is Intruder Resistant Glass that conforms to LPS 1270 (Loss Prevention Standard) and is set dry against the glazing tape and retained by mechanically fixed beads.

#### **SPECIFICATION**

The door conforms to the aluminium industry standards of the trade association i.e. The Council for Aluminium in Building (CAB). The door also conforms to many of the requirements for aluminium windows specification BS4873.  
A single door using this manual design has been security tested to PAS 24 BS/EN 1627-RC3 fitted with two locks (both engaged).

All technical aspects for this product are covered in the product manual and further information is available from Comar's Technical Department for specific contract requirements.

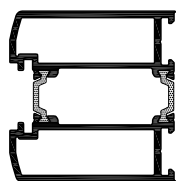

**CS772**  
DOOR STILE, PLAIN  
(T.B)

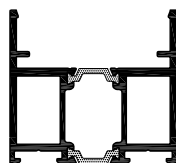

**CS777**  
DOOR TOP  
RAIL (T.B)



**CS992**  
HEADER BAR PLATE  
(T.B)



**CS997**  
MULLION ADAPTOR  
(T.B)

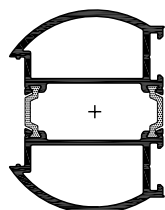

**CS773**  
FINGER GUARD DOOR  
STILE (T.B)

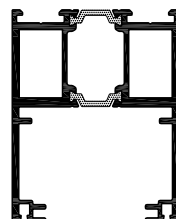

**CS778**  
DOOR BOTTOM  
RAIL (T.B)

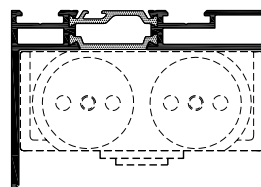

**CS993**  
HEADER BAR  
(T.B)



**CS015**  
DOUBLE RAMP  
THRESHOLD



**CS915**  
DOUBLE RAMP  
THRESHOLD (T.B)

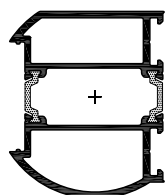

**CS774**  
FINGER GUARD DOOR  
STILE, PANIC EXIT  
(T.B)

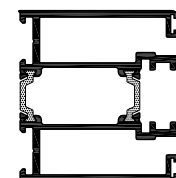

**CS779**  
DOOR STILE  
WOOLPILE (T.B)

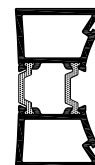

**CS994**  
DOOR FINGER GUARD,  
70MM PIVOT POINT  
(T.B)

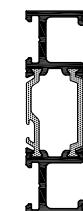

**CS962**  
78mm MULLION  
INFILL PLATE  
NO LEG

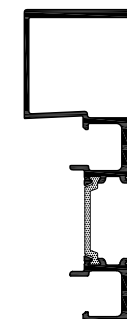

**CS965**  
MULLION INTERNAL  
BOX



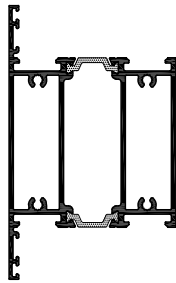

**CS780**  
105mm  
TRANSOM/MIDRAIL  
(T.B)

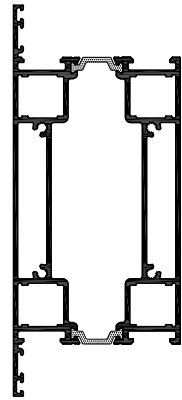

**CS781**  
150mm TRANSOM/MIDRAIL  
(T.B)

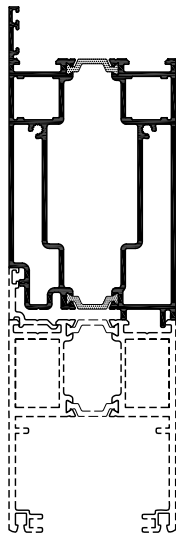

**CS784**  
100mm BOTTOM RAIL  
EXTENSION (T.B)

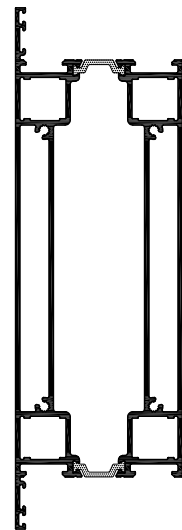

**CS782**  
200mm TRANSOM/MIDRAIL  
(T.B)



**CS795**  
STANDARD BEAD



**CS796**  
SECURITY BEAD  
EXTERNAL



**CS797**  
SECURITY BEAD  
INTERNAL



**CS798**  
SECURITY BEAD  
COVER



**CS925**  
GLAZING BEAD



**CS926**  
GLAZING BEAD



**CS927**  
GLAZING BEAD



**CS928**  
GLAZING BEAD



**CS929**  
GLAZING BEAD



**CS930**  
GLAZING BEAD



**CS422**  
GLAZING BEAD



**CS100**  
RAIL BRUSH  
WOOLPILE CARRIER

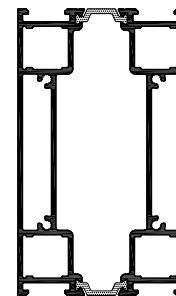

**CS783**  
110mm SECURITY OPTION  
DOOR MIDRAIL  
(T.B)



**CS734**  
BOTTOM RAIL PLATE  
47.8 x 3 mm

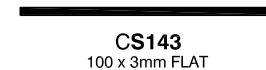

**CS143**  
100 x 3mm FLAT

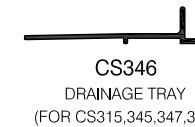

**CS346**  
DRAINAGE TRAY  
(FOR CS315,345,347,348)



**CS072**  
DRAINAGE TRAY  
(THERMALLY BROKEN OR PLAIN)



**CS045**  
SINGLE RAMP THRESHOLD

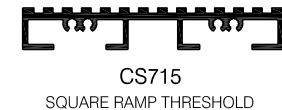

**CS715**  
SQUARE RAMP THRESHOLD

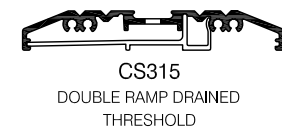

**CS315**  
DOUBLE RAMP DRAINED  
THRESHOLD



**CS345**  
SINGLE RAMP DRAINED  
THRESHOLD



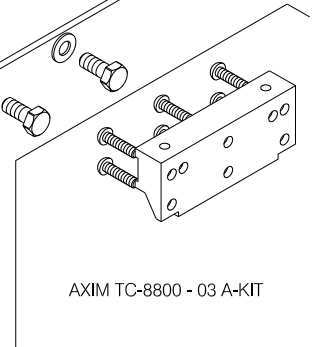
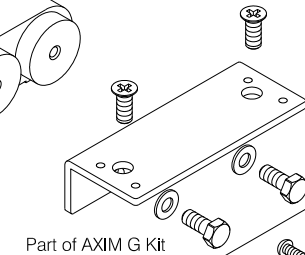
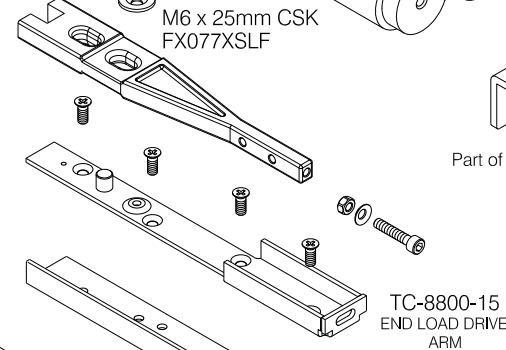
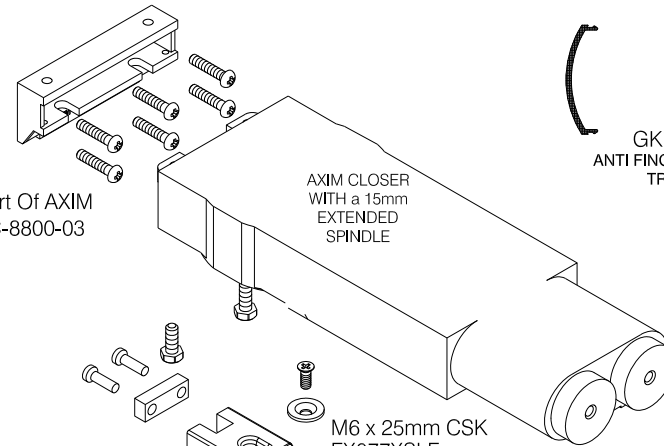
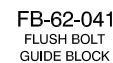
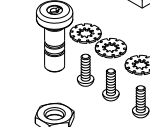
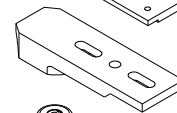
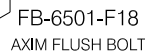
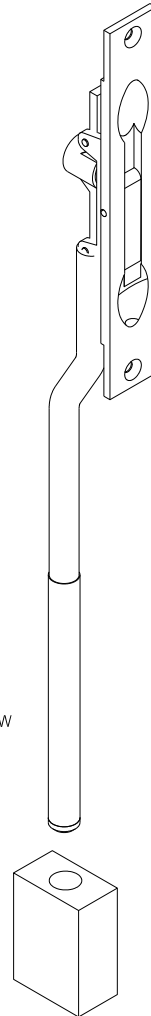
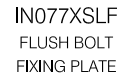
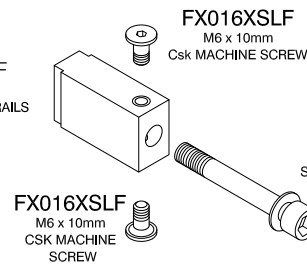

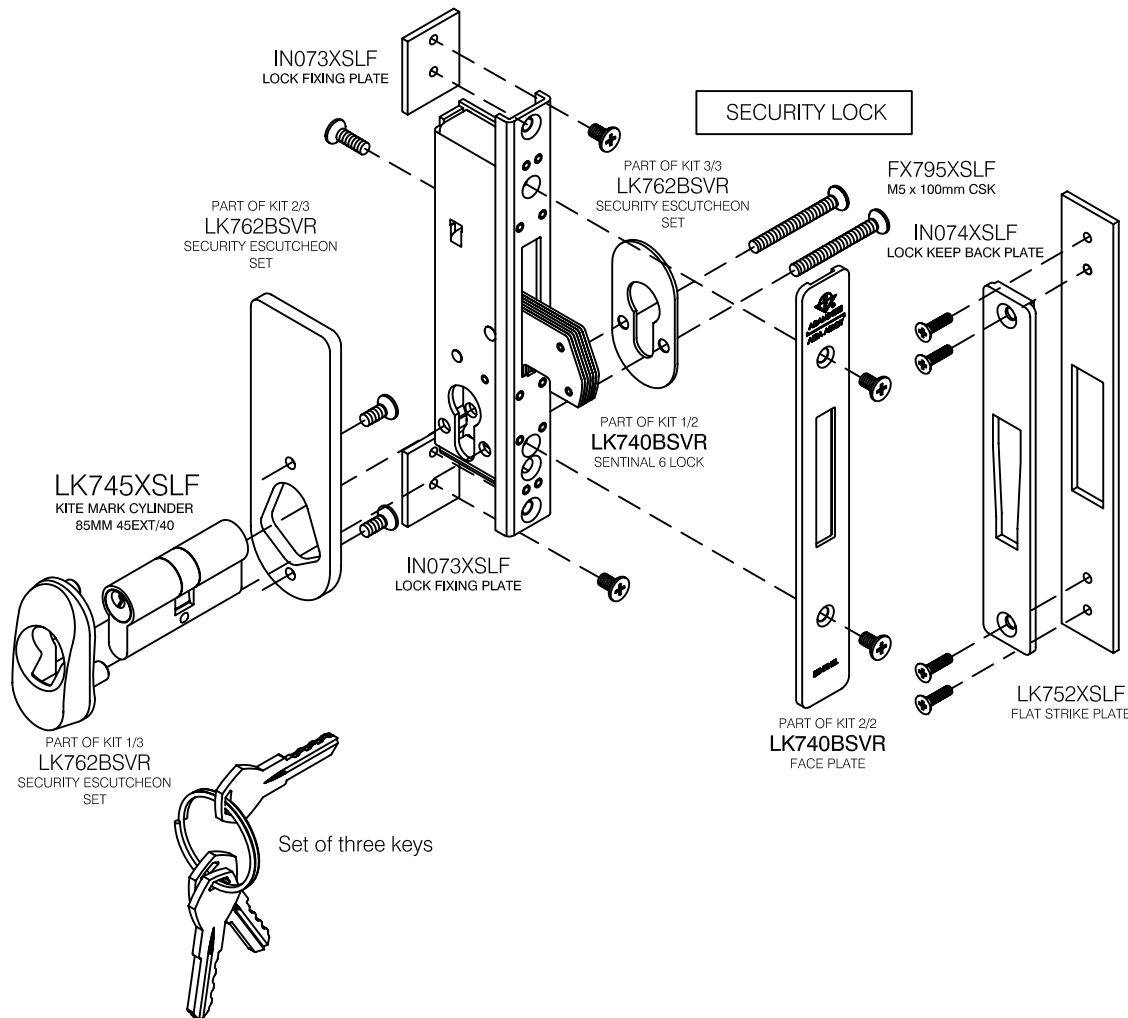

## STANDARD LOCK

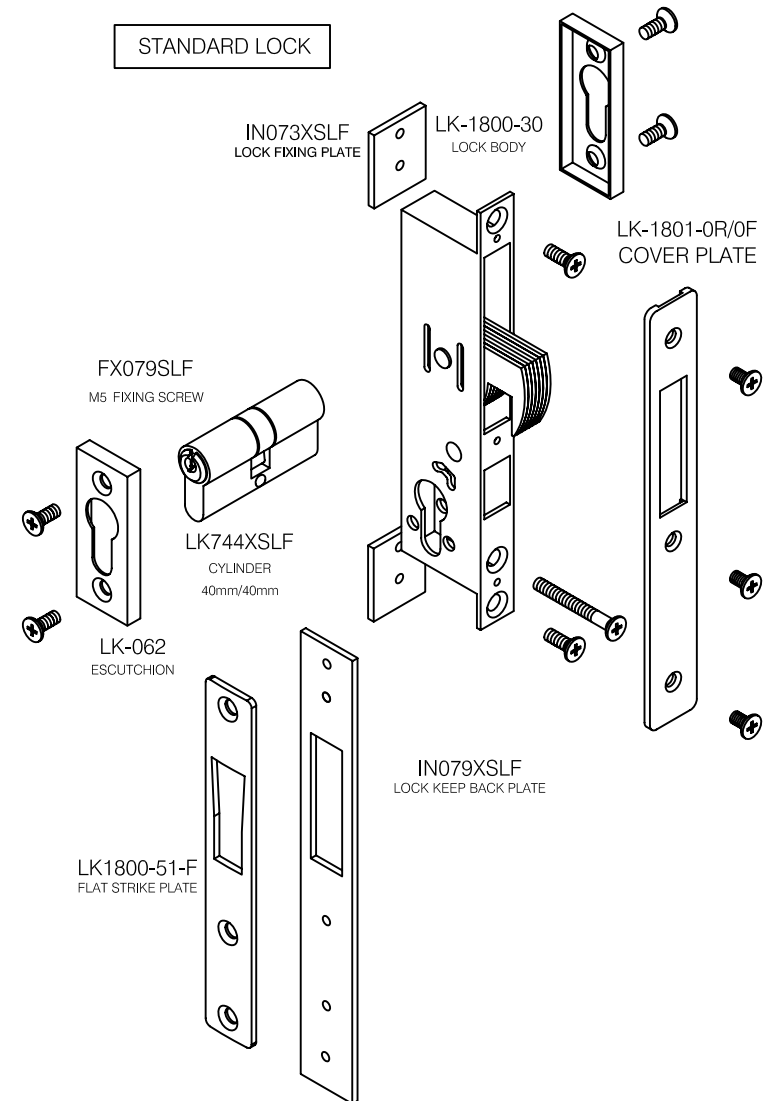

Copyright & ownership of this drawing is vested in COMAR Architectural Aluminium Systems, whose prior written consent is required for its use, reproduction or publication to any third party. All other rights reserved. Subject to modifications without prior notification.

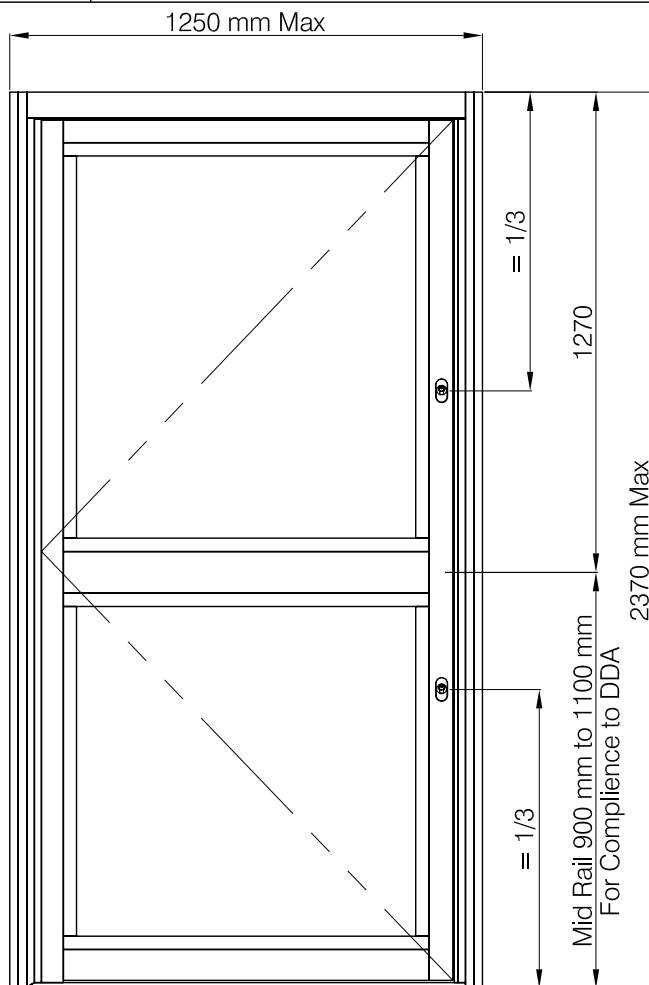

UNIVERSAL CONCEALED TRANSOM CLOSER  
STANDARD OPTION  
180° SWING AND DELAYED ACTION  
HOLD OPEN OPTIONS AVAILABLE  
THREE CLOSING STRENGTHS AVAILABLE

AXIM TC8801-0015	8801-9015	SIZE 1
AXIM TC8802-0015	8802-9015	SIZE 2
AXIM TC8803-0015	8803-9015	SIZE 3

MIN DOOR LEAF WIDTH 600mm MIN DOOR LEAF HEIGHT 1800mm  
MAX DOOR LEAF WIDTH 1095mm MAX DOOR LEAF HEIGHT 2272mm  
MAX DOOR WEIGHT 90Kgs

#### APPLICATIONS

LPS 1175 - SR2 & EN 1627 - RC3 CERTIFIED SECURITY RATED SINGLE ANTI FINGER TRAP SWING DOOR  
FOR BUILDINGS WITH PUBLIC ACCESS REQUIRING A FAR HIGHER THAN NORMAL DEGREE OF SECURITY



**comar**  
ARCHITECTURAL ALUMINIUM SYSTEMS



Copyright & ownership of this drawing is vested in COMAR Architectural Aluminium Systems, whose prior written consent is required for its use, reproduction or publication to any third party. All other rights reserved. Subject to modifications without prior notification

THE PARKSIDE GROUP LTD  
UNIT 5 ° THE WILLOW CENTRE  
17 WILLOW LANE ° MITCHAM  
SURREY ° CR4 4NX  
Tel: 020-8685 9685 Fax: 020-8687 1142  
Email: [technical@parksidegrp.co.uk](mailto:technical@parksidegrp.co.uk)  
Web Site: <http://www.comar-alu.co.uk>

SCALE	1: 20	© A4
DATE	01/06/11	
DRAWN	VM / CAD	
DRG. No.	C7Pi-CD-1.07	R0



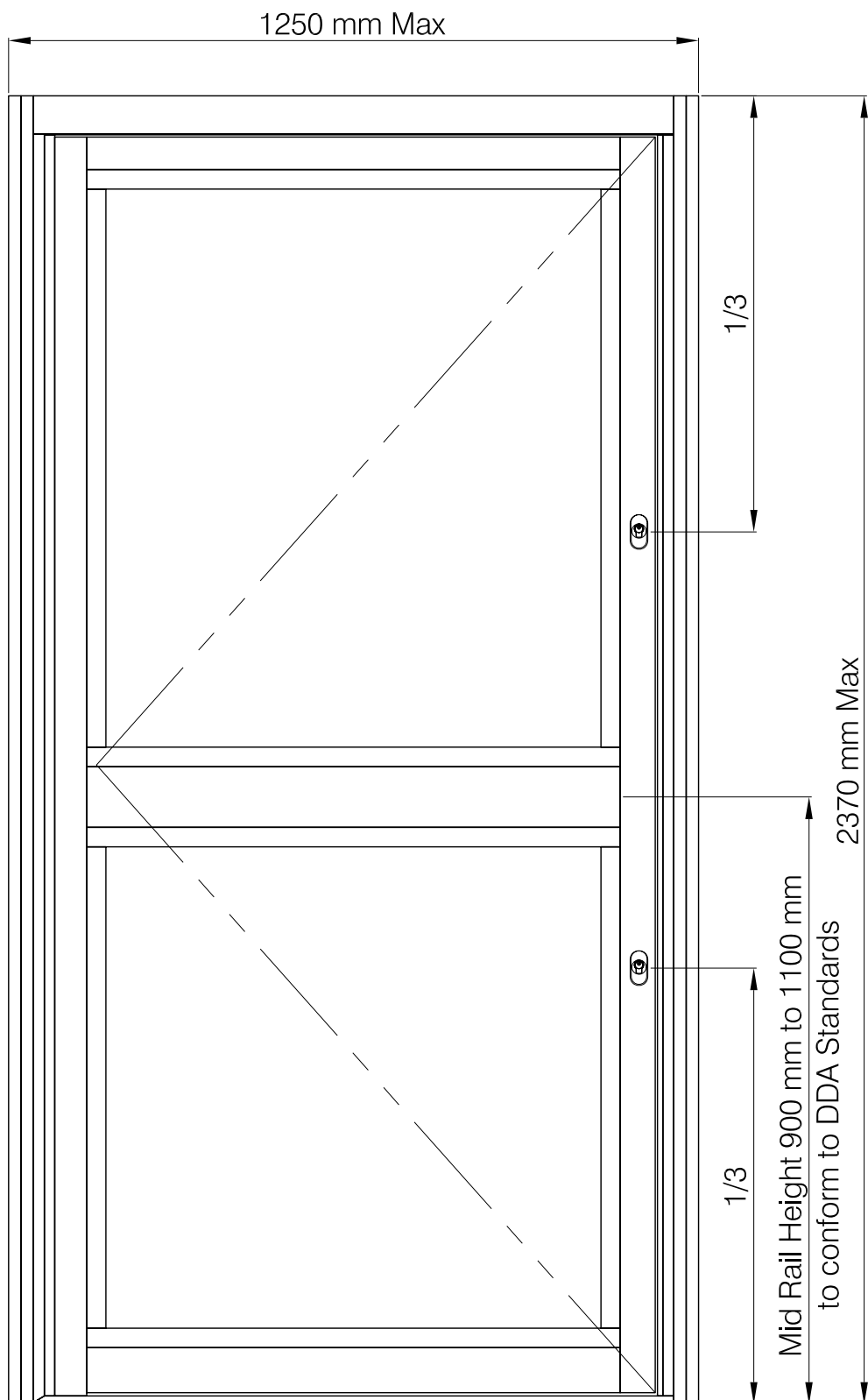

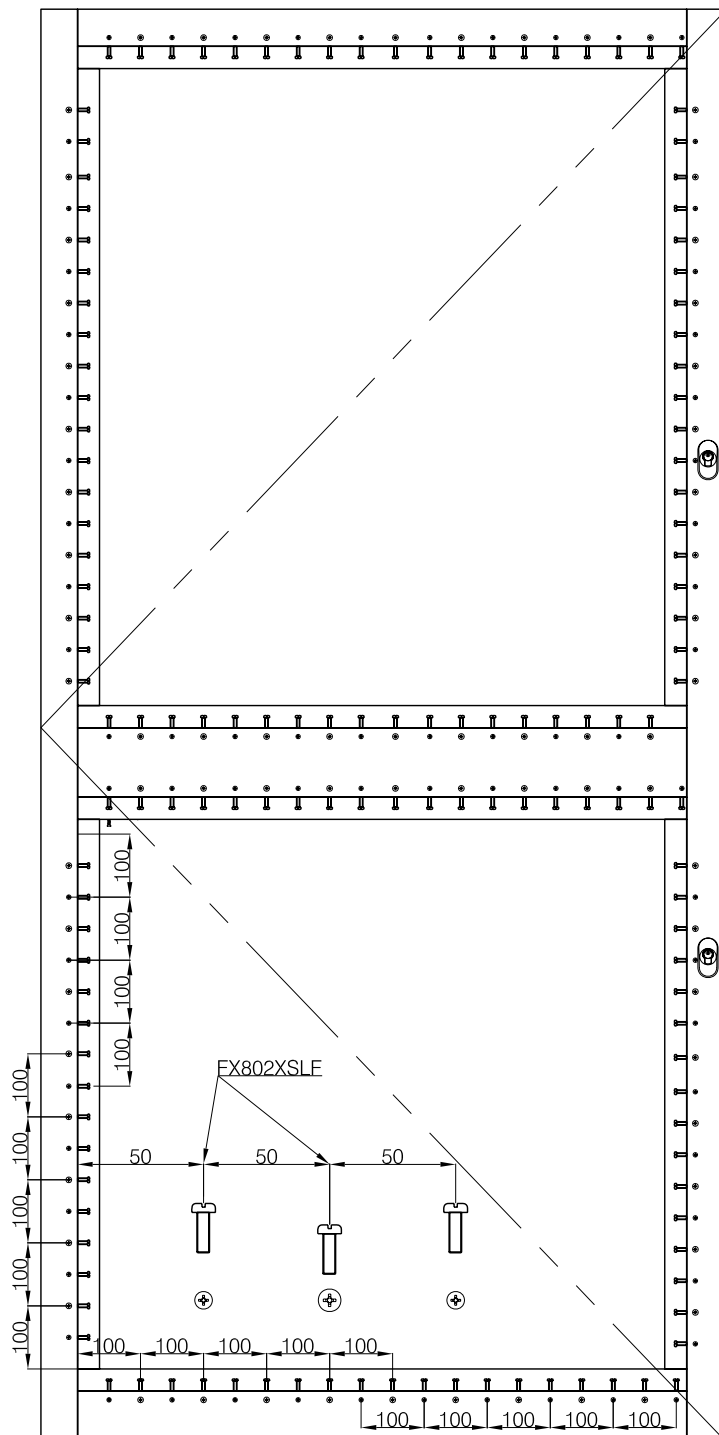

NOTE:  
FOR A SECURITY RATED DOOR  
THE SCREWS ARE TO BE  
INSTALLED AS PER THE MANUAL

SEE PAGE 3.31 FOR FURTHER  
DETAILS



**comar**  
ARCHITECTURAL ALUMINIUM SYSTEMS



Copyright & ownership of this drawing is vested in COMAR Architectural Aluminium Systems, whose prior written consent is required for its use, reproduction or publication to any third party. All other rights reserved. Subject to modifications without prior notification

THE PARKSIDE GROUP LTD  
UNIT 5 ° THE WILLOW CENTRE  
17 WILLOW LANE ° MITCHAM  
SURREY ° CR4 4NX  
Tel: 020-8685 9685 Fax: 020-8687 1142  
Email: [technical@parksidegrp.co.uk](mailto:technical@parksidegrp.co.uk)  
Web Site: <http://www.comar-alu.co.uk>

SCALE	1:12	@ A4
DATE	01/06/11	
DRAWN	VM / CAD	
DRG. No.	C7Pi-CD-1.09	R0

# comar 7P.i CD

TITLE	<b>POLYAMIDE INSULATED DOORS THERMALLY EFFICIENT DOOR SYSTEM</b>	SHEET No. <b>1.10</b>
SUB TITLE	<b>STANDARD OPTION OUTER FRAME AND DOOR FRAME WORKING DRAWING / DIAGRAM</b>	

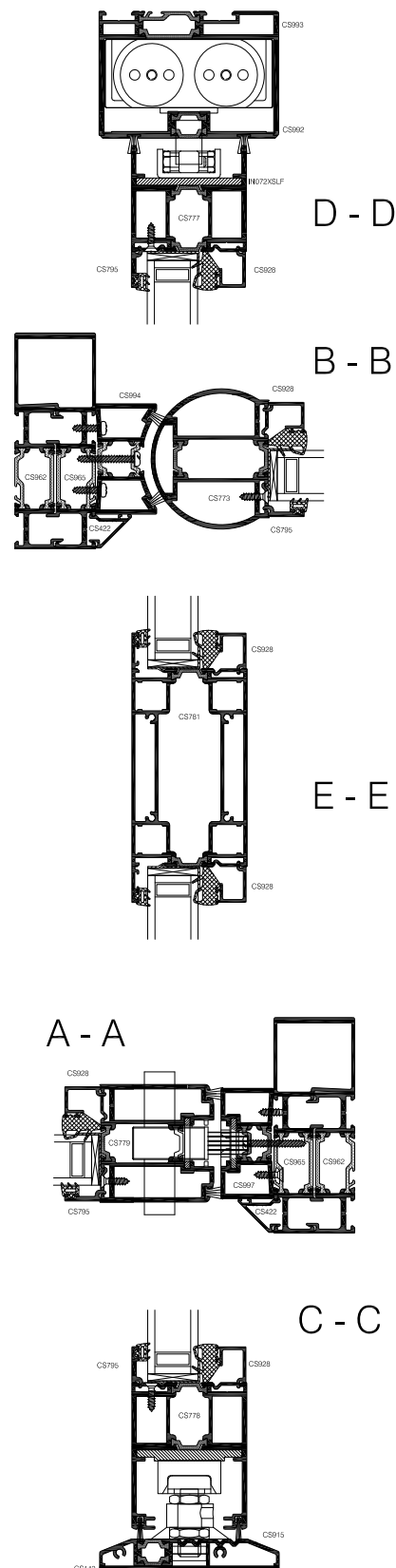
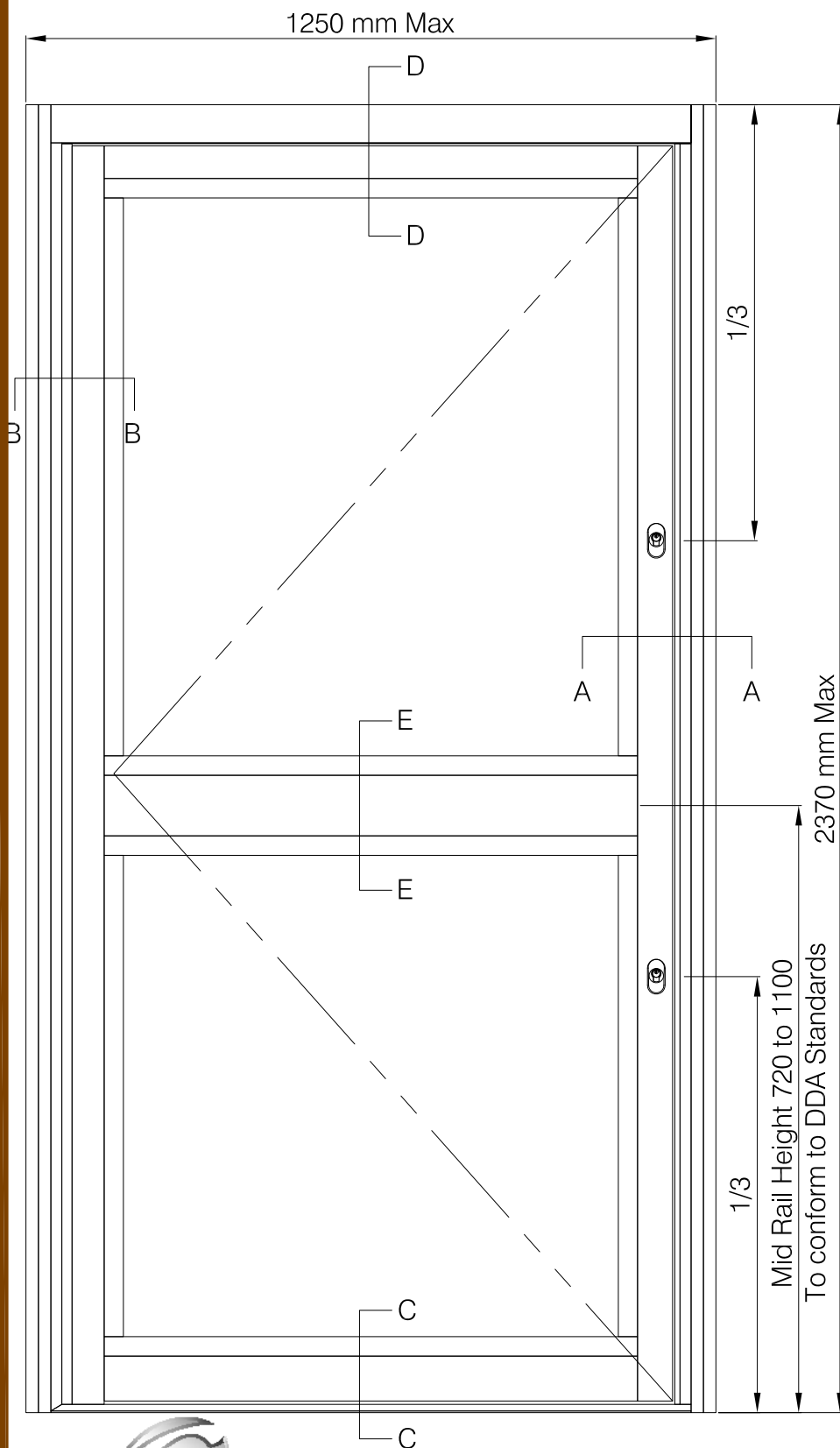

**comar**  
ARCHITECTURAL ALUMINIUM SYSTEMS



THE PARKSIDE GROUP LTD  
UNIT 5 ° THE WILLOW CENTRE  
17 WILLOW LANE ° MITCHAM  
SURREY ° CR4 4NX  
Tel: 020-8685 9685 Fax: 020-8687 1142  
Email: [technical@parksidegrp.co.uk](mailto:technical@parksidegrp.co.uk)  
Web Site: <http://www.comar-alu.co.uk>

Copyright & ownership of this drawing is vested in COMAR Architectural Aluminium Systems, whose prior written consent is required for its use, reproduction or publication to any third party. All other rights reserved. Subject to modifications without prior notification

SCALE	NTS	@ A4
DATE	08/10/13	
DRAWN	VM / IS	
DRG. No.	C7Pi-CD-1.10	R1

# comar 7P.i CD

TITLE	<b>POLYAMIDE INSULATED DOORS THERMALLY EFFICIENT DOOR SYSTEM</b>	SHEET No. <b>1.11</b>
SUB TITLE	<b>SECURITY OPTION OUTER FRAME AND DOOR FRAME WORKING DRAWING / DIAGRAM</b>	

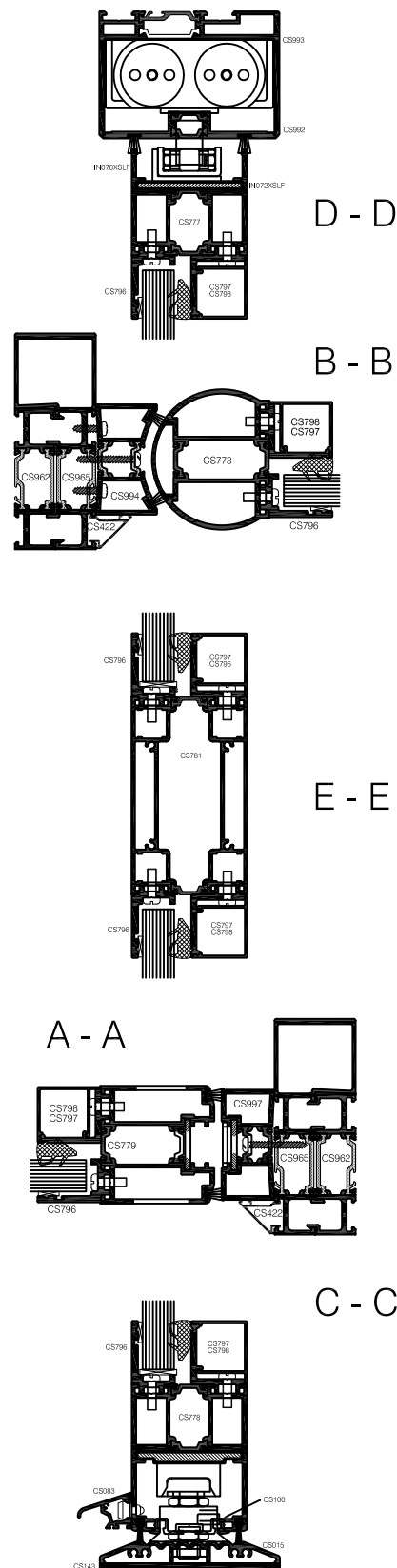
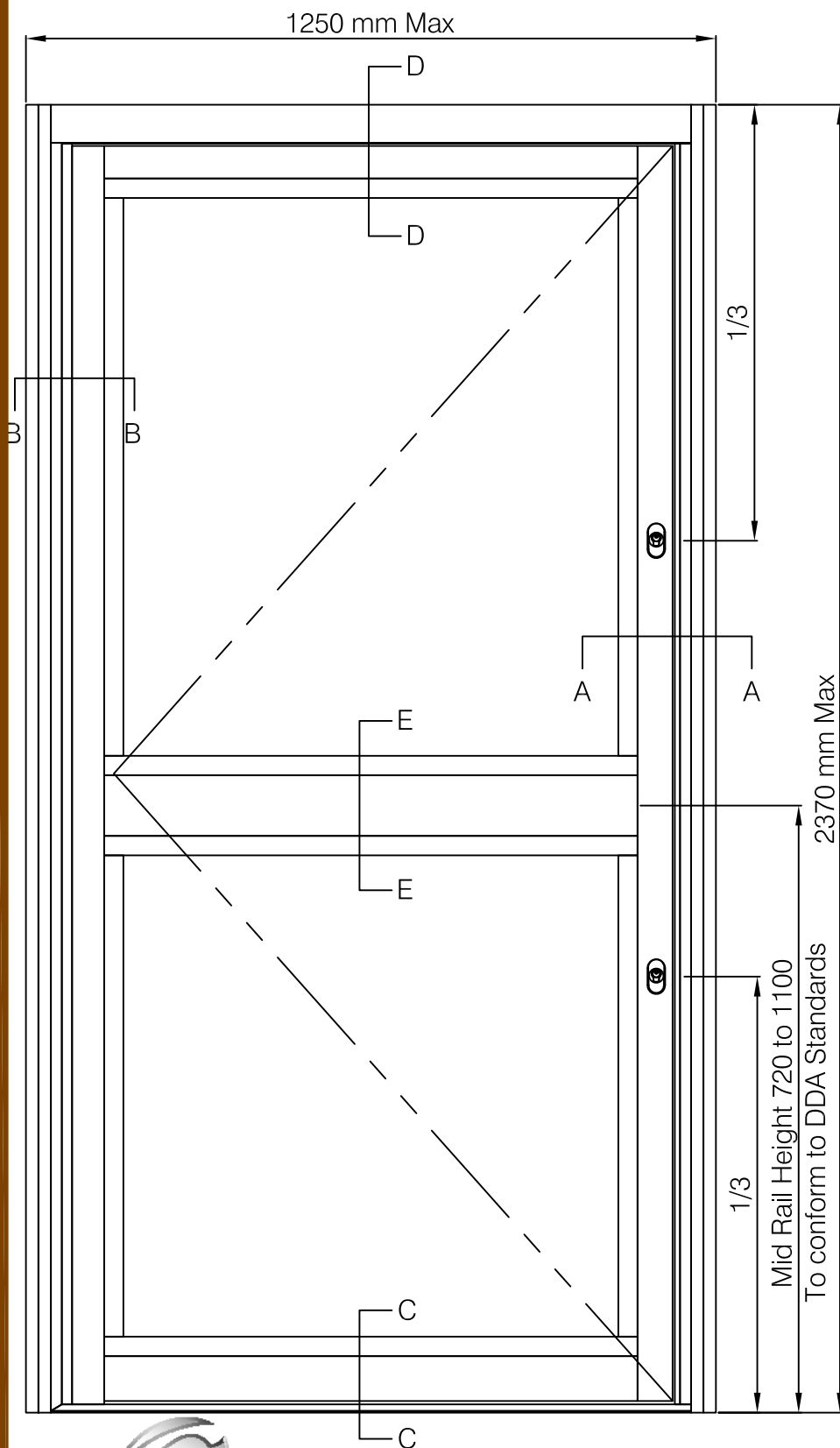

**comar**  
ARCHITECTURAL ALUMINIUM SYSTEMS



THE PARKSIDE GROUP LTD  
UNIT 5 ° THE WILLOW CENTRE  
17 WILLOW LANE ° MITCHAM  
SURREY ° CR4 4NX  
Tel: 020-8685 9685 Fax: 020-8687 1142  
Email: [technical@parksidegrp.co.uk](mailto:technical@parksidegrp.co.uk)  
Web Site: <http://www.comar-alu.co.uk>

Copyright & ownership of this drawing is vested in COMAR Architectural Aluminium Systems, whose prior written consent is required for its use, reproduction or publication to any third party. All other rights reserved. Subject to modifications without prior notification

SCALE	NTS	@ A4
DATE	01/10/12	
DRAWN	VM / CAD	
DRG. No.	C7Pi-CD-1.11	R0

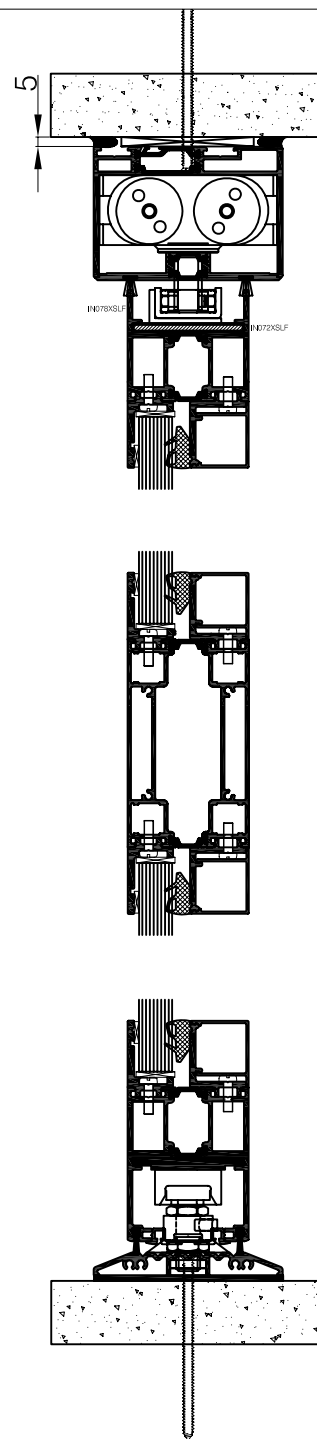
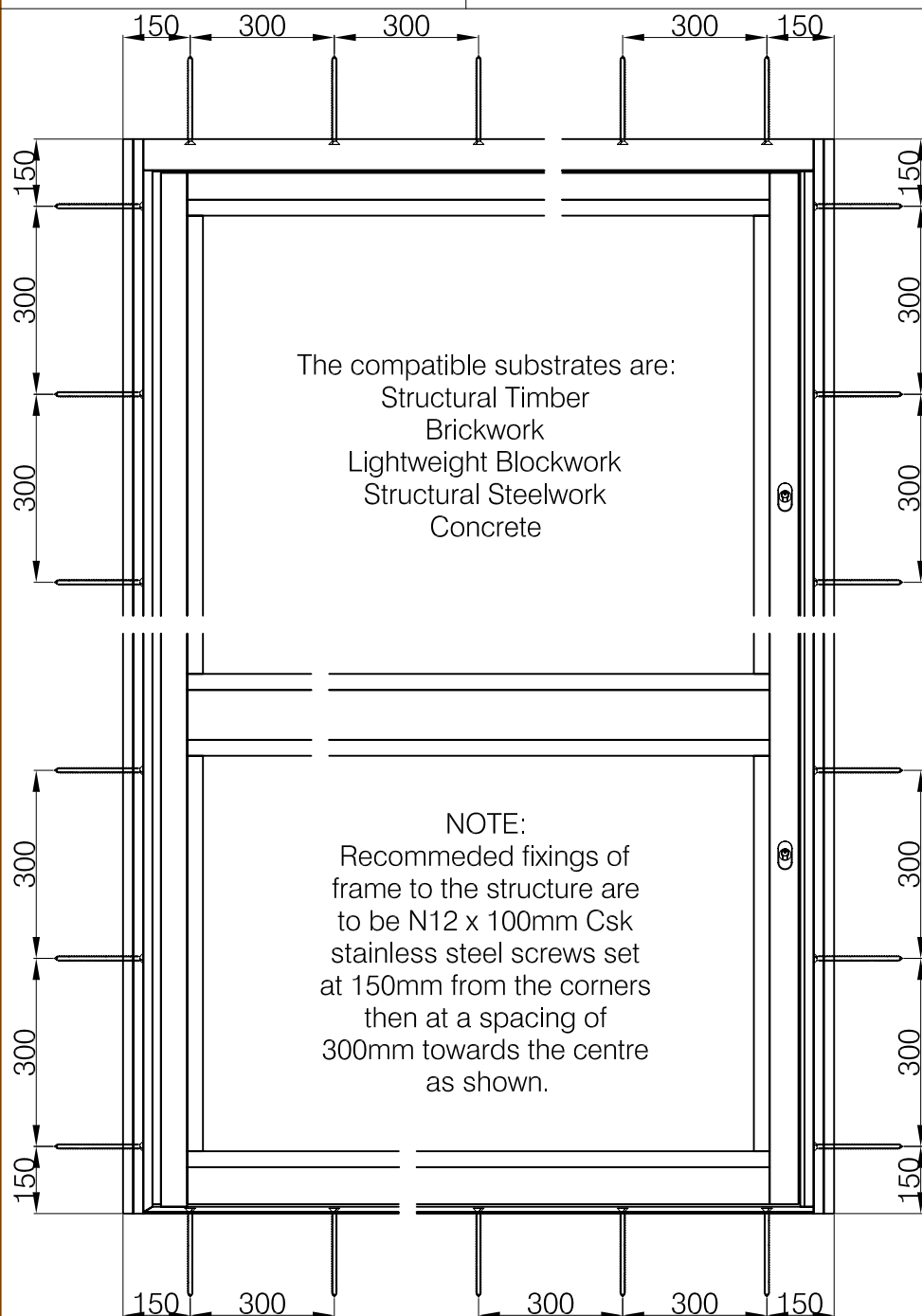

**NOTE:**  
The maximum permissible gap between the frame and substrate is 8mm. Suitable plastic packers to be used.

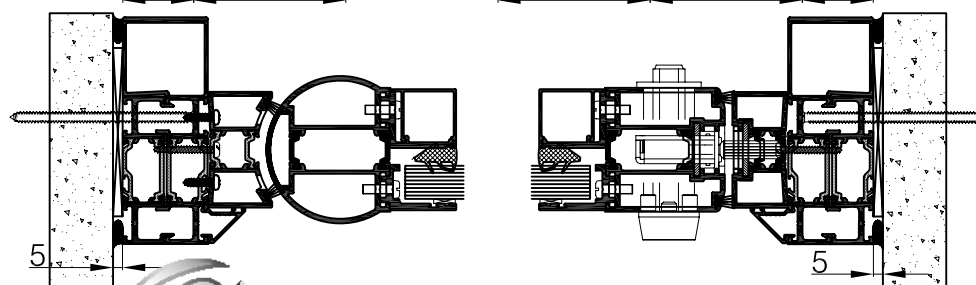

Copyright & ownership of this drawing is vested in COMAR Architectural Aluminium Systems, whose prior written consent is required for its use, reproduction or publication to any third party. All other rights reserved. Subject to modifications without prior notification