

comar7Pi

TITLE **POLYAMIDE INSULATED ECO DOORS**
THERMALLY EFFICIENT ECO DOOR SYSTEM

SHEET No.
ECO 2.33

SUB TITLE **REBATED DOOR OPEN IN**
MULLION WITH FIXED LIGHT

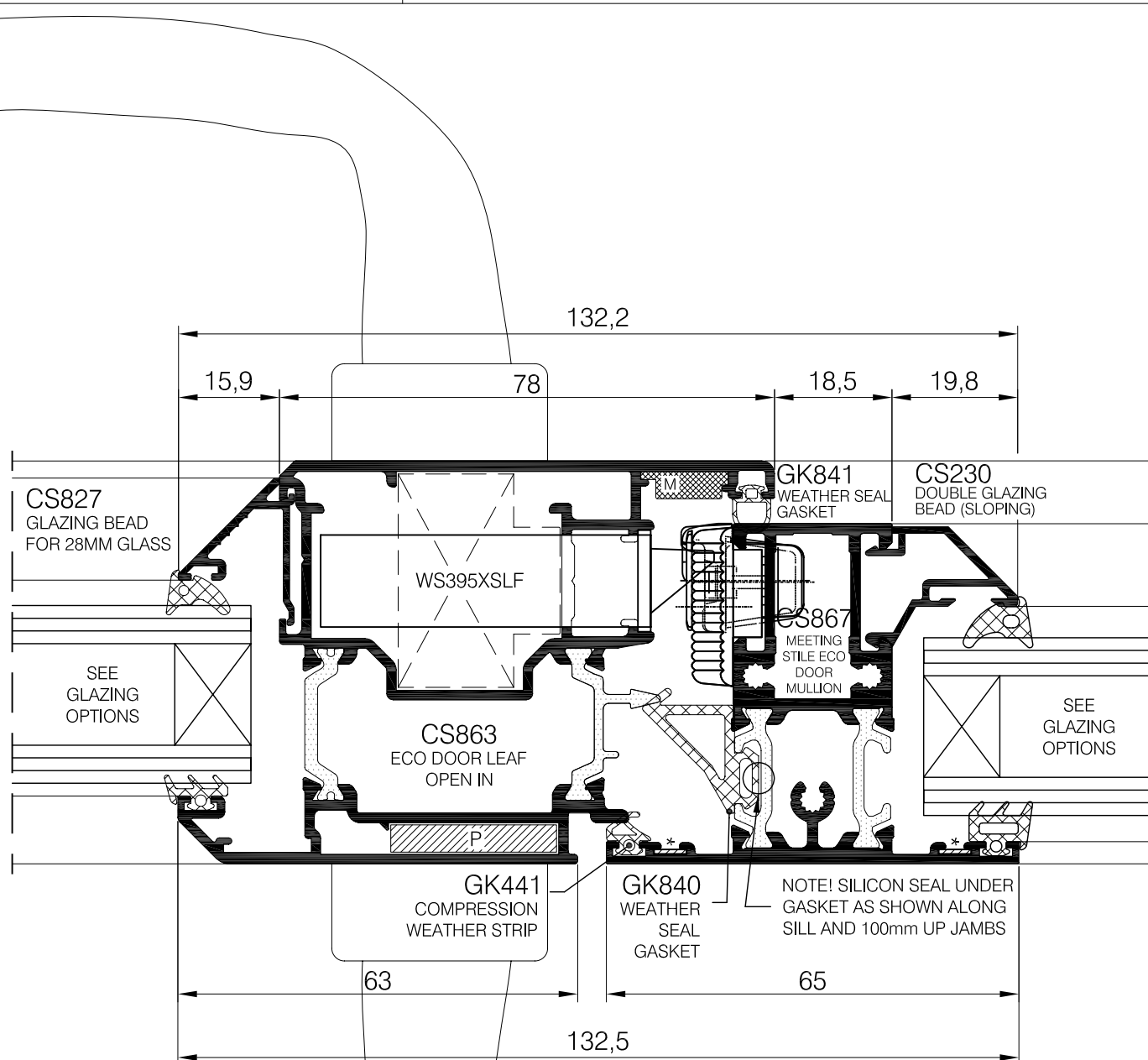

M DENOTES WS416XSLF ALIGNMENT SQUARE
P DENOTES WS172XSLF CORNER CLEAT
* DENOTES WS515 CHEVRON



comar
ARCHITECTURAL ALUMINIUM SYSTEMS



Copyright & ownership of this drawing is vested in COMAR Architectural Aluminium Systems, whose prior written consent is required for its use, reproduction or publication to any third party. All other rights reserved. Subject to modifications without prior notification

THE PARKSIDE GROUP LTD
UNIT 5 ° THE WILLOW CENTRE
17 WILLOW LANE ° MITCHAM
SURREY ° CR4 4NX
Tel: 020-8685 9685 Fax: 020-8687 1142
Email: technical@parksidegrp.co.uk
Web Site: <http://www.comar-alu.co.uk>

SCALE	1:1	@ A4
DATE	29/01/2010	
DRAWN	OP/CAD	
DRG. No.	C7-Pi-RB-EC 2.33	