

Parallel Hinge System

Comar 6EFT

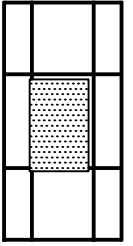

Copyright and ownership of this drawing is vested in EFT, Euro Facade Systems Ltd, whose prior written consent is required for its use, reproduction or for publication to any third party. All other rights reserved. Subject to modifications.

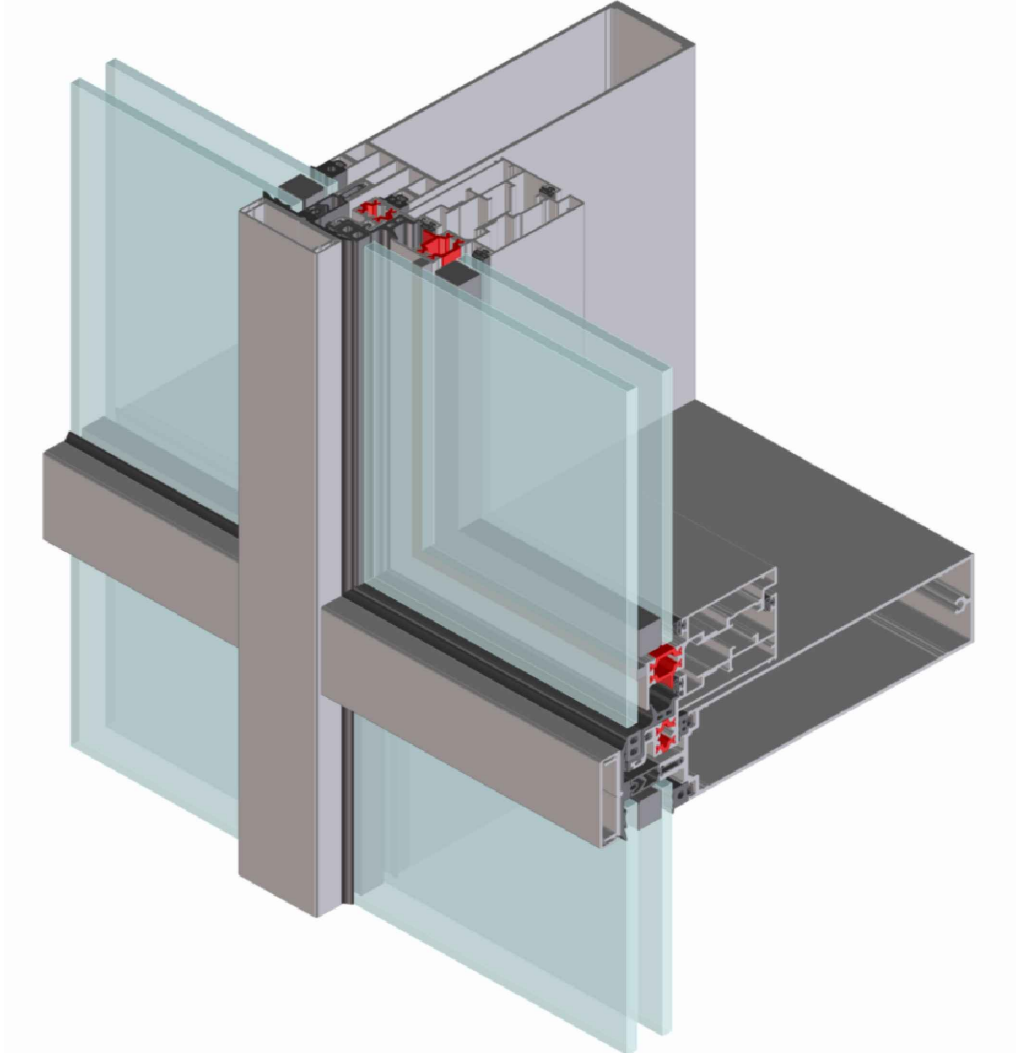

Concealed Vent into Capped CW

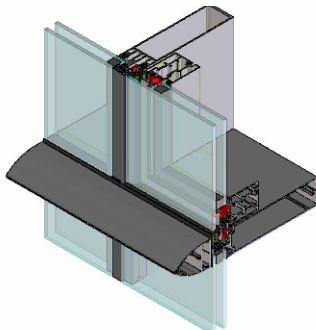

2side SGH

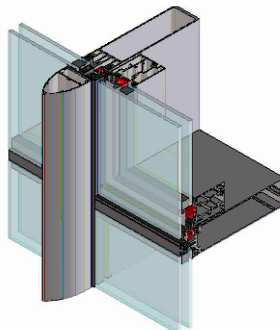

2side SGV

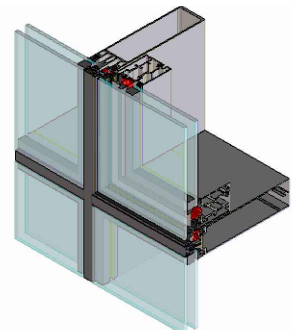

4side SG

Fabricators Guide

Changes reserved  
 Sous reserve de modifications  
 Änderungen vorbehalten

Issue:05  
 Date: 10 -16

## Introduction

### Comar 6 EFT Concealed Vent

**Comar 6 EFT Concealed Vent - Parallel Hinge System** is a window fitted with scissor action friction hinges that allows the window to be pushed out horizontally and is available in single or double glazed units.

## Specification Summary

### Glazing

The system is glazed from the outside, structurally bonded to the moving frame (window vent)  
Glass should conform to the requirements of BS 6262 for thickness and type, in terms of wind resistance, safety and security.

### Drainage

The system is drained and achieved by meeting the requirements of "ventilated and drained glazing system" as specified in BS 6262

### Thermal Insulation

Classification in accordance with DIN 4108 or EN ISO 10077 - 1

### Thermally Concealed Vent:

The thermal transmittance ( $U_f$ )  $W/m^2 K$ , is dependant on the insulator strip, calculated as per EN ISO 10077 - 1.

Comparable with class 1.0 or 2.1 DIN 4108 - 4 Table 3

### Sound Insulation

Depending largely upon the glass specification, generally the curtain wall framing reduces the figure by 2dB (A).

### Materials

The system is constructed from extruded aluminium profiles, using alloy 6063 complying to the requirements of BS EN 755 & BS EN 12020  
The thermal barrier system is achieved by means of PVC/PP extrusion. with the requirements of BS 3734.

## Construction

Any instructions regarding the manufacture and installation of the system must be strictly adhered to.

## Weathering

Glazing vision strips are made of EPDM conforming to BS 4255 Part 1

## Performance / exposure category

The system will achieve the following criteria when manufactured, installed and glazed to EFT recommended procedures.

## Classification

Air permeability: BS EN 12207 - Class 4

Water tightness: BS EN 12208 - Class E 750

Wind resistance: BS EN 13116 - 2400 Pa design  
- 3600 Pa safety

2400Pa (Pascal's) depends upon correct mullion and transom selection to suit span and spacing on a project-by-project basis.

## Size limitations

The size limitations of the system depends mainly on the hardware used. Please refer to Comar's Technical Office for advise.



## Parallel Hinge System Overview

Comar 6EFT

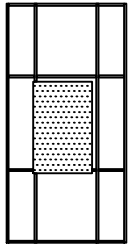

9.00

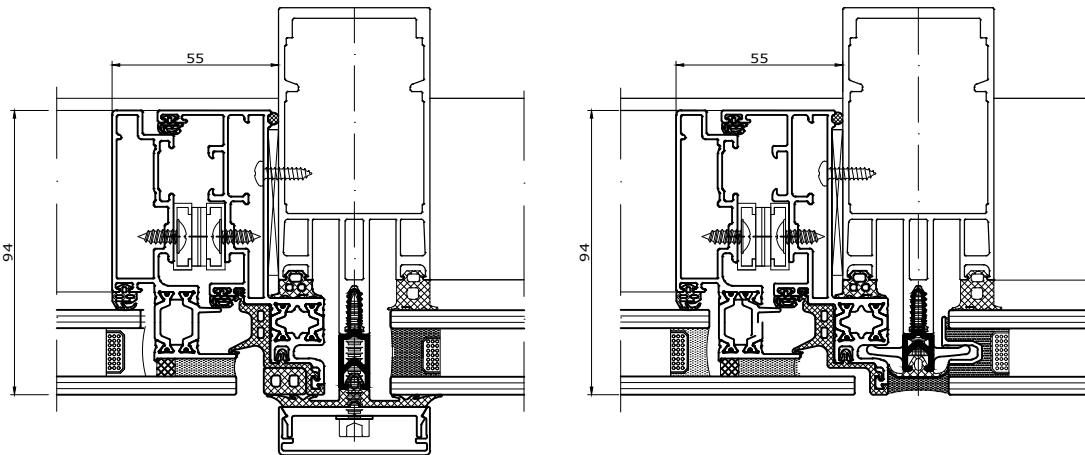

Copyright and ownership of this drawing is vested in EFT,  
Euro Facade Systems Ltd, whose prior written consent is required  
for its use, reproduction or for publication to any third party.  
All other rights reserved. Subject to modifications.

### Notes:

1. For manual operation up to 1500mm wide 2 handles central at the sides.  
Can also be mechanically or electrically operated.
2. For vents 1500mm to 2000mm wide electric operation should be used.
2. Vents either side of a faceted mullion may be possible depending on the angle, contact Comar's technical department for advice.
3. A minimum of a 60mm transom (1150) must be used above and below where a concealed vent is to be positioned.
4. For width / height / weight combination options, please contact Comar's technical department.

### Integrates into:

Fully capped Curtain Walling  
2 sided with vertical capping  
(2sided SGV)

### Integrates into:

2 sided with horizontal capping  
(2sided SGH)  
4 sided structural glazing  
(4sided SG)

### Limitations

	Max. width	Max. height	Max. weight
<b>Parallel Hinge System</b>	2000mm depends on height	2000mm depends on width	100 / 200kg depends on sizing

Changes reserved  
Sous reserve de modifications  
Änderungen vorbehalten

Issue:05  
Date: 02 -17



**comar**  
ARCHITECTURAL ALUMINIUM SYSTEMS

Typical details

9

Comar 6EFT

Parallel Hinge System  
Typical window

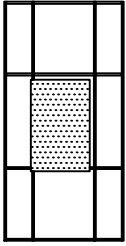

9.01

Fabricators Guide

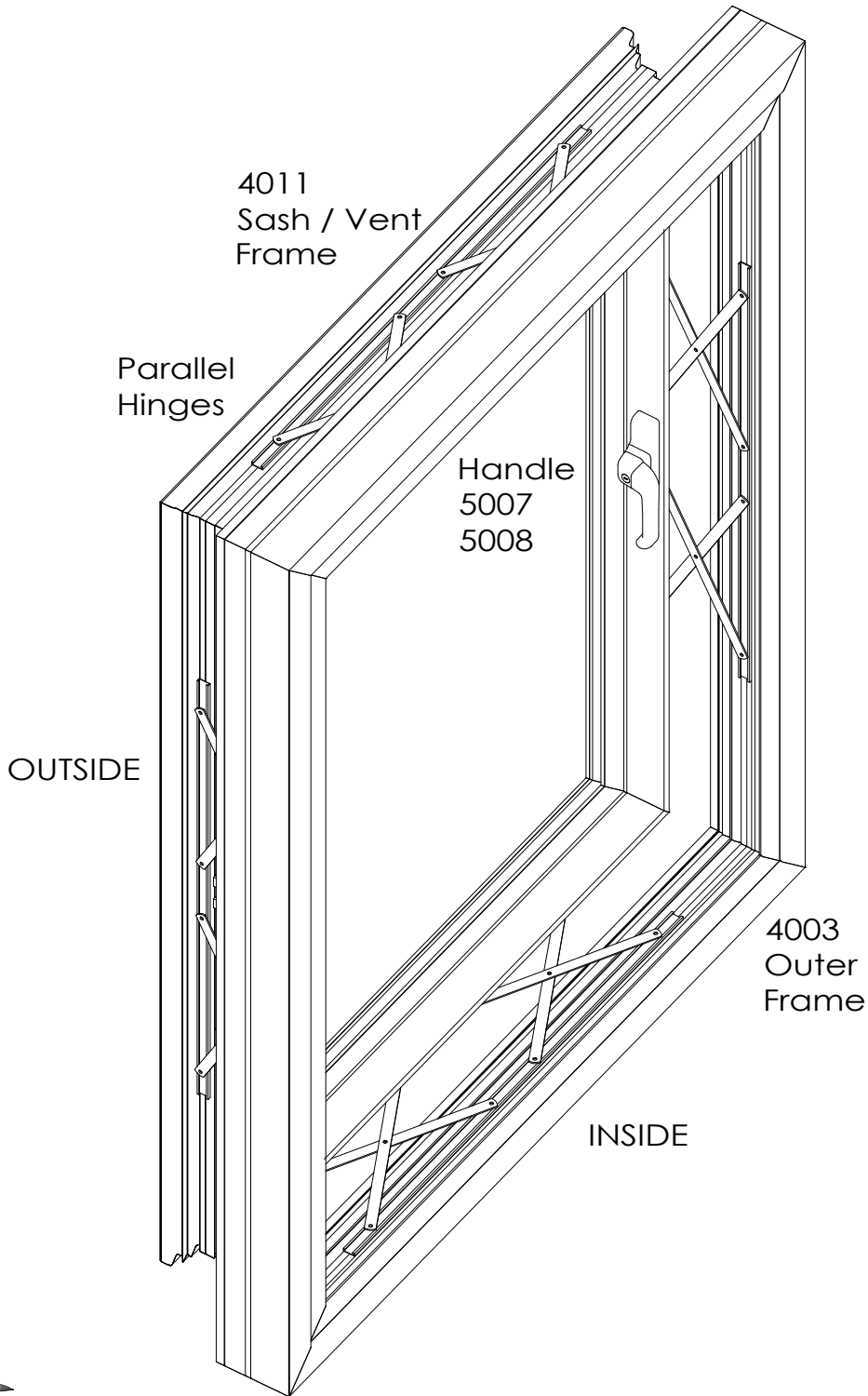

Copyright and ownership of this drawing is vested in EFT, Euro Facade Systems Ltd, whose prior written consent is required for its use, reproduction or for publication to any third party. All other rights reserved. Subject to modifications.



**comar**  
ARCHITECTURAL ALUMINIUM SYSTEMS

Changes reserved  
Sous reserve de modifications  
Änderungen vorbehalten

Issue: 05  
Date: 02 -17

Parallel Hinge System  
Hinges charts

Copyright and ownership of this drawing is vested in EFT, Euro Facade Systems Ltd, whose prior written consent is required for its use, reproduction or for publication to any third party. All other rights reserved. Subject to modifications.

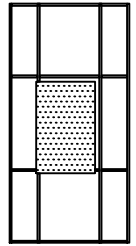
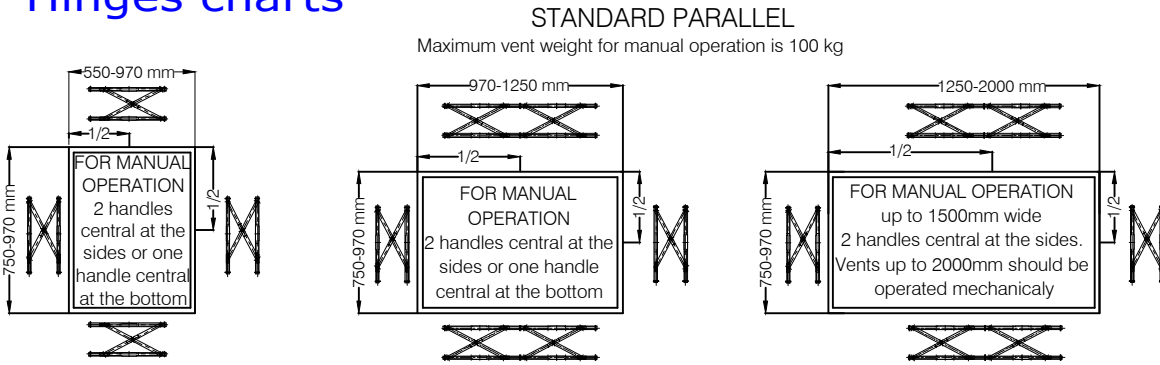

9.02

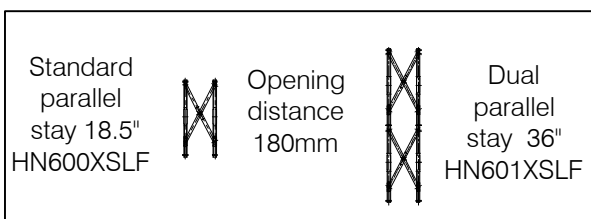
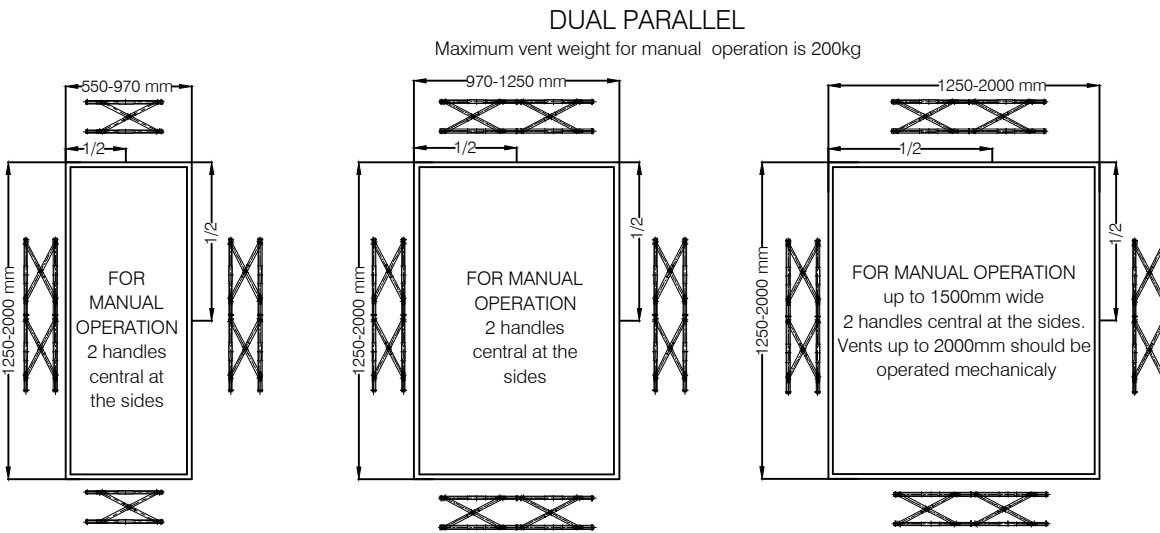
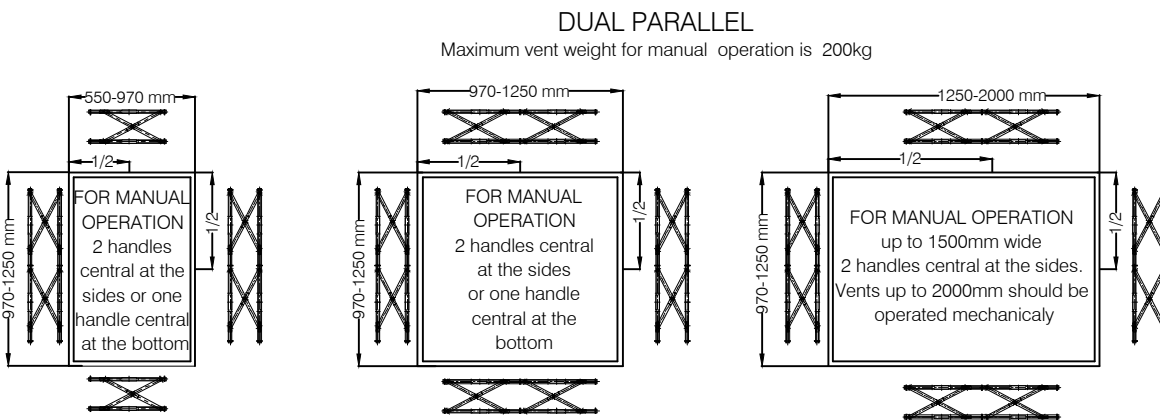

Changes reserved  
Sous reserve de modifications  
Änderungen vorbehalten

Issue:05  
Date: 02 -17

Comar 6EFT

Parallel Hinge System  
Dual hinges

Hinges are universal and will open & close for left & right hand sides also, top & bottom frame / sash fitting.

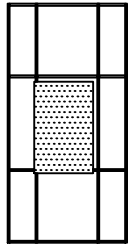

9.03

Fabricators Guide

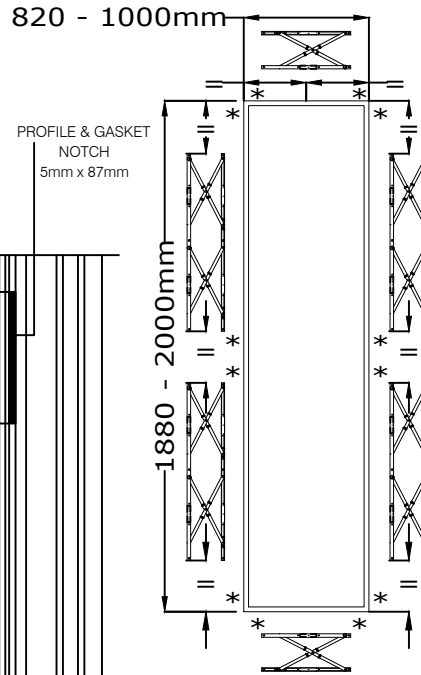
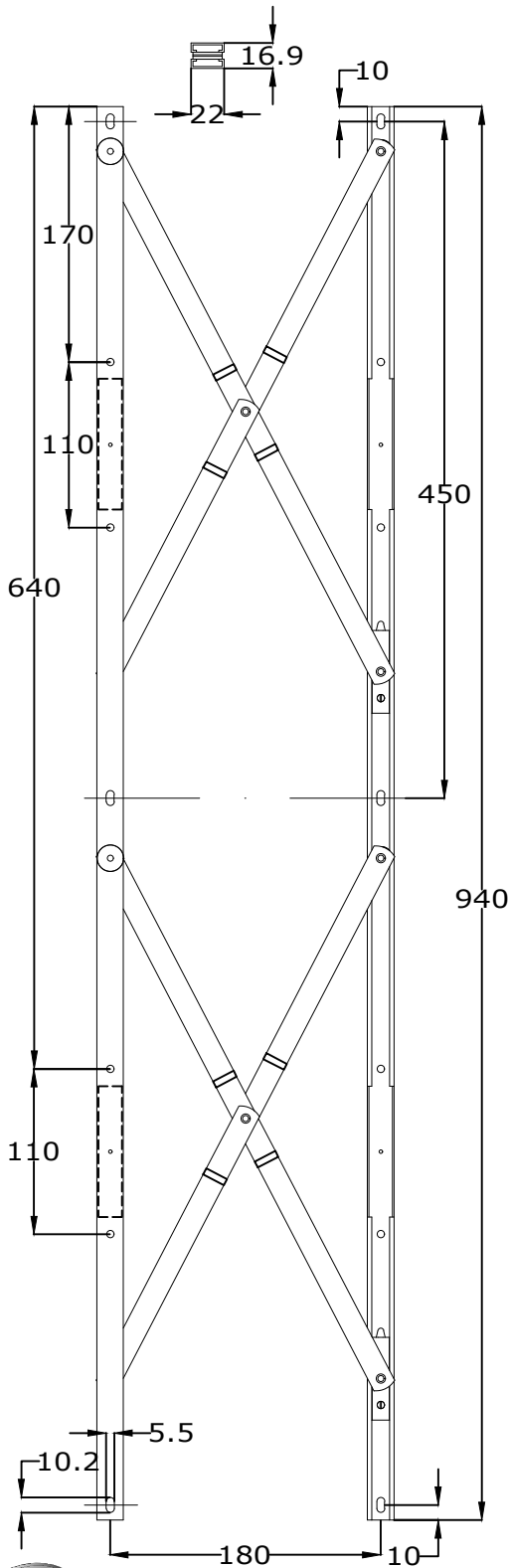

\* Indicates locking points  
FOR MANUAL OPERATION  
2 handles central at the sides

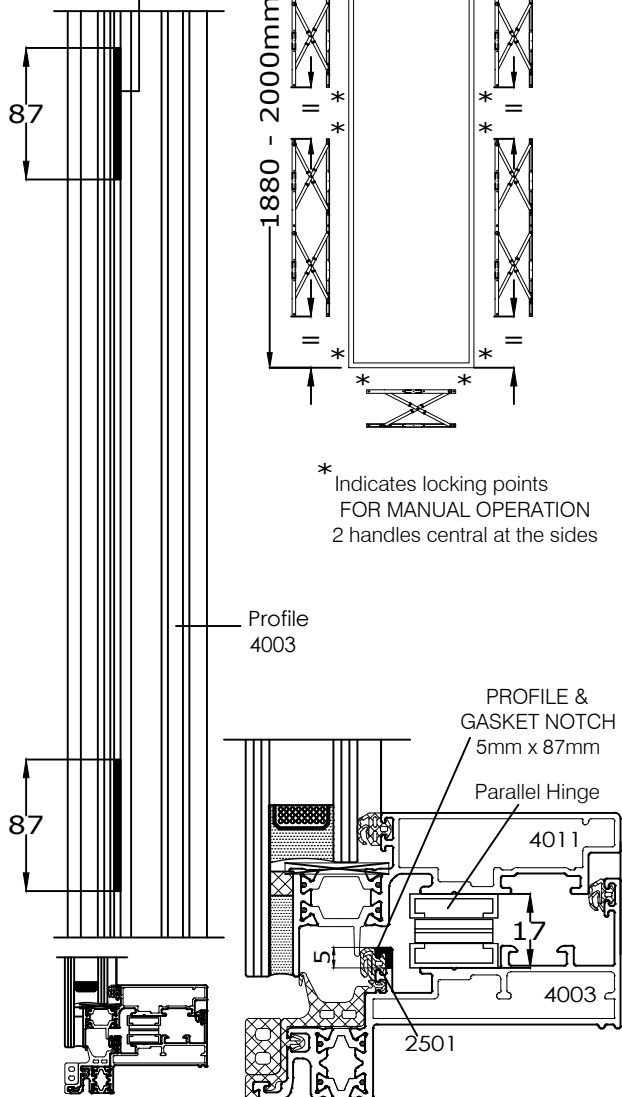

Handing is achieved by opening the hinge either to the left or to the right as required.

Copyright and ownership of this drawing is vested in EFT, Euro Facade Systems Ltd, whose prior written consent is required for its use, reproduction or for publication to any third party. All other rights reserved. Subject to modifications.



Parallel Hinge System  
Single hinges

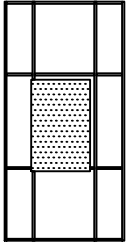

NOTE:

Hinges are universal and will open & close for left & right hand sides also, top & bottom frame / sash fitting.

9.04

Copyright and ownership of this drawing is vested in EFT, Euro Facade Systems Ltd, whose prior written consent is required for its use, reproduction or for publication to any third party. All other rights reserved. Subject to modifications.

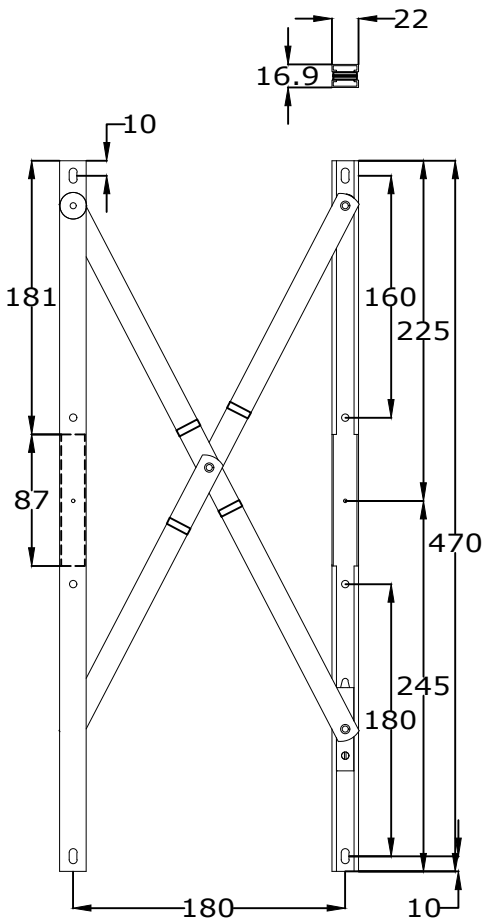

Single hinge

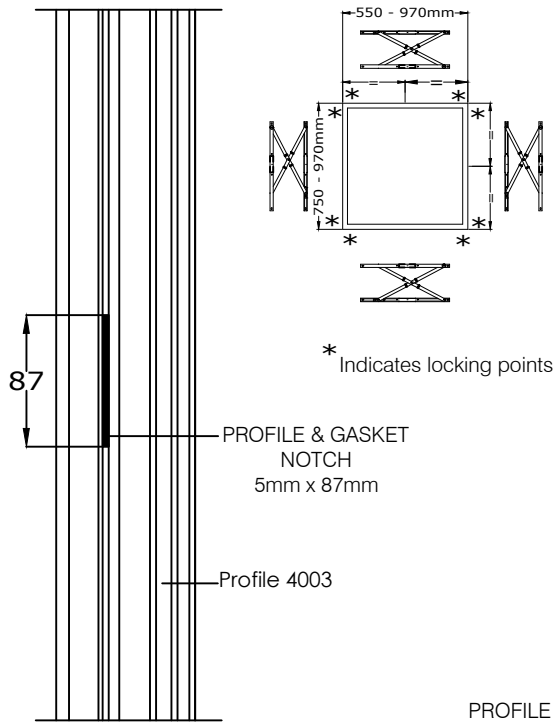

\* Indicates locking points

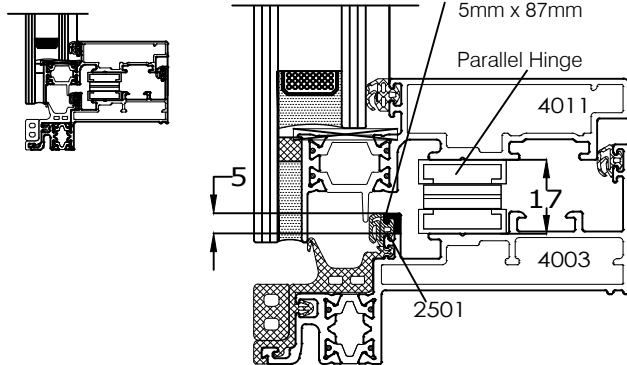

Hinges are universal and will open and operate for both left and right sides of the frame and sash and for the top and bottom.

Changes reserved  
Sous reserve de modifications  
Änderungen vorbehalten

Issue:05  
Date: 02 -17

# Typical details

9

## Comar 6EFT

## Parallel Hinge System Mullion section - Capped

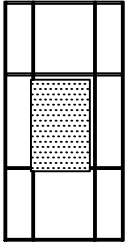

9.05

Fabricators Guide

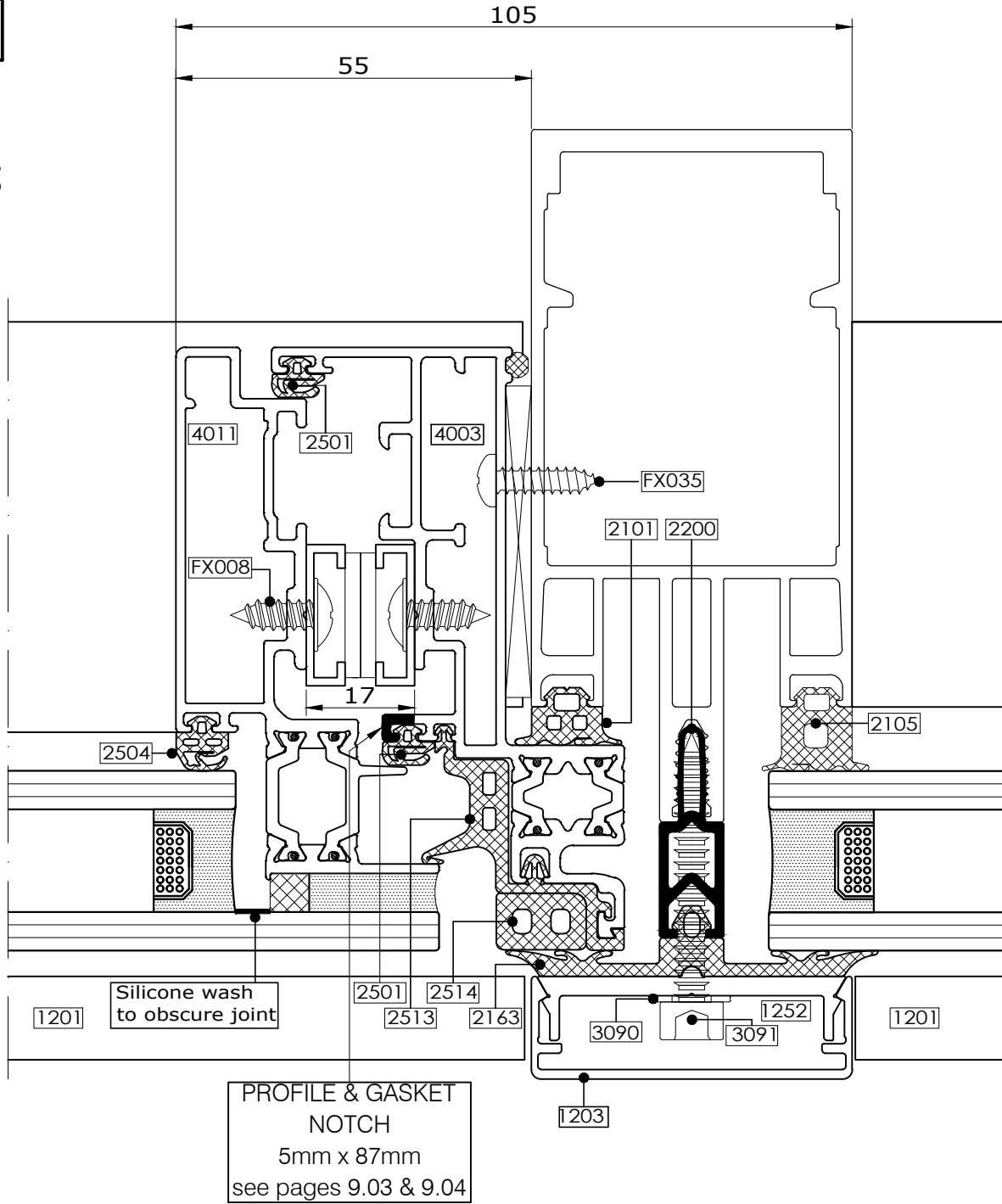

Copyright and ownership of this drawing is vested in EFT, Euro Facade Systems Ltd, whose prior written consent is required for its use, reproduction or for publication to any third party. All other rights reserved. Subject to modifications.



Parallel Hinge System  
Transom section - Capped

Comar 6EFT

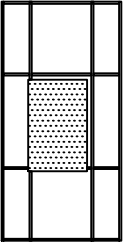

9.06

Fabricators Guide

Copyright and ownership of this drawing is vested in EFT, Euro Facade Systems Ltd, whose prior written consent is required for its use, reproduction or for publication to any third party. All other rights reserved. Subject to modifications.

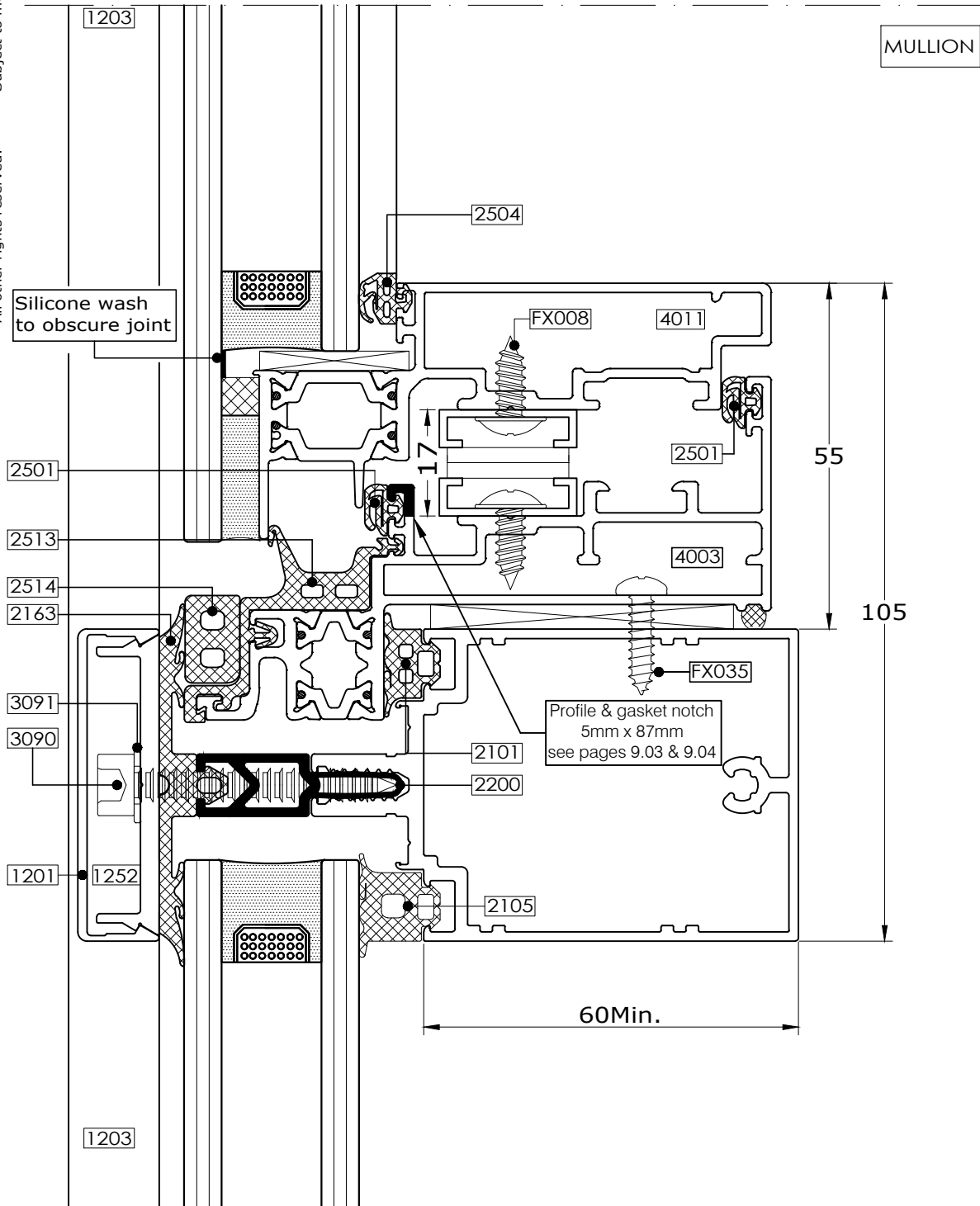

Changes reserved  
Sous reserve de modifications  
Änderungen vorbehalten

Issue:05  
Date: 02 -17



**comar**  
ARCHITECTURAL ALUMINIUM SYSTEMS

# Typical details

9

## Comar 6EFT

## Parallel Hinge System Mullion section - SG

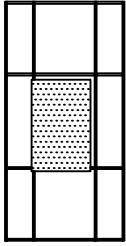

9.07

Fabricators Guide

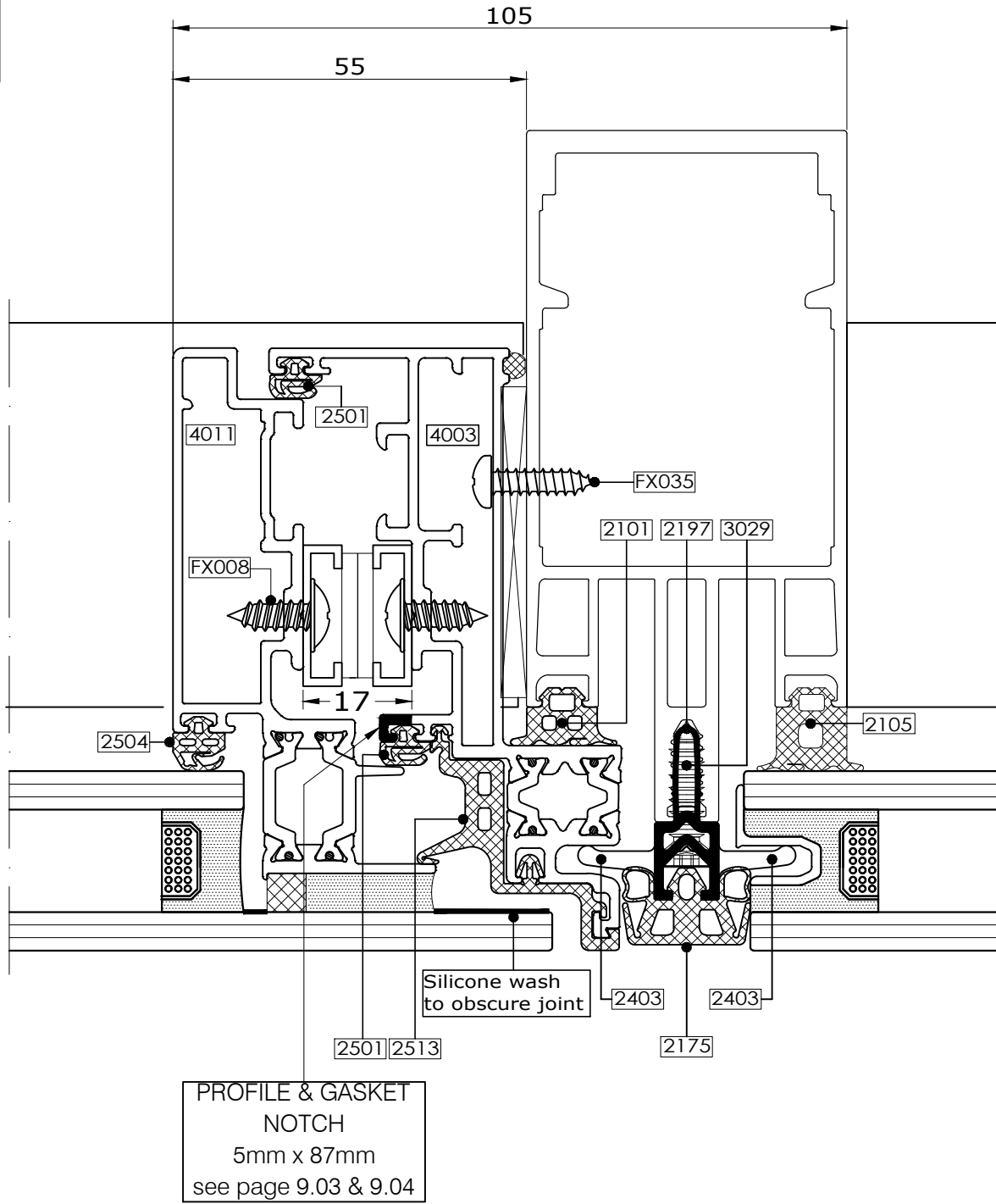

Copyright and ownership of this drawing is vested in EFT, Euro Facade Systems Ltd, whose prior written consent is required for its use, reproduction or for publication to any third party. All other rights reserved. Subject to modifications.

Parallel Hinge System  
Transom hinge - SG

Comar 6EFT

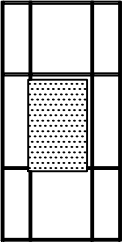

9.08

Fabricators Guide

Copyright and ownership of this drawing is vested in EFT, Euro Facade Systems Ltd, whose prior written consent is required for its use, reproduction or for publication to any third party. All other rights reserved. Subject to modifications.

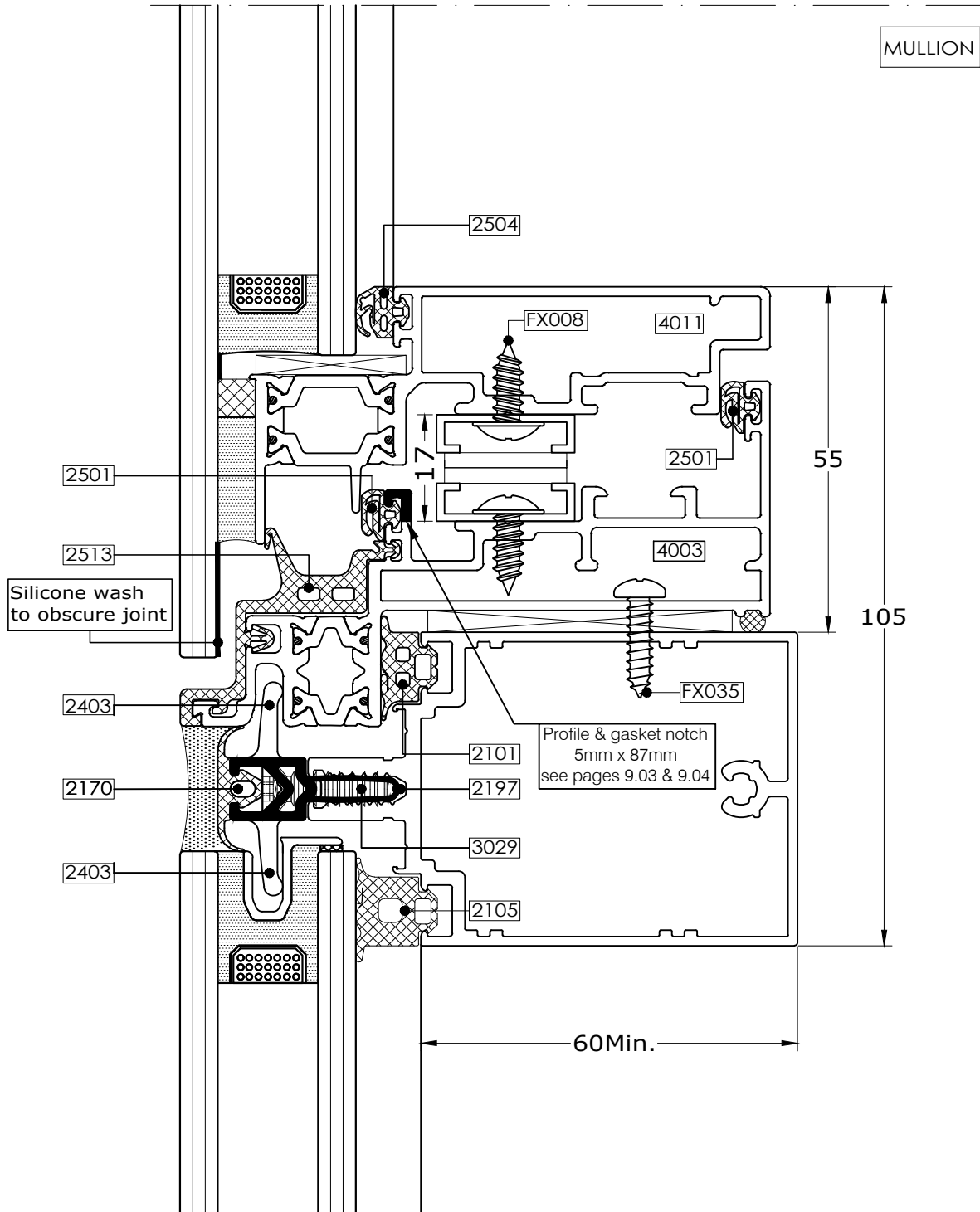

Changes reserved  
Sous reserve de modifications  
Änderungen vorbehalten

Issue:05  
Date: 02 -17



**comar**  
ARCHITECTURAL ALUMINIUM SYSTEMS

# Fabrication

# 9

## Comar 6EFT

## Parallel Hinge System Twin single hinge locking

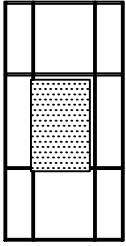

9.09

Fabricators Guide

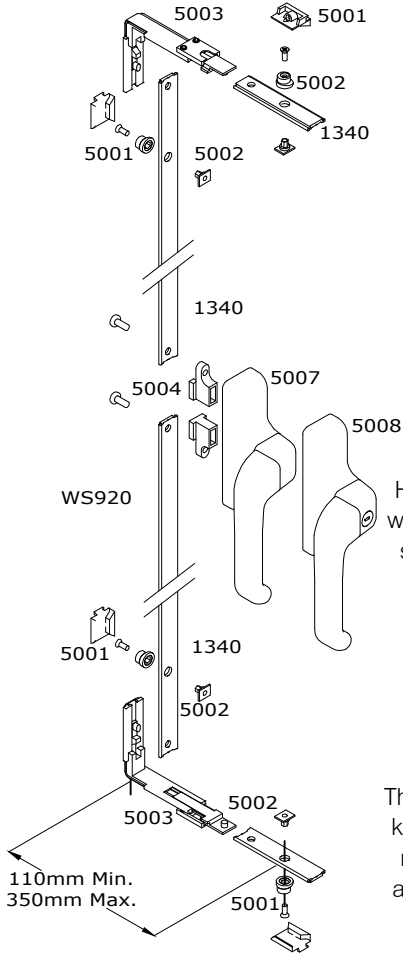

Handles can be fitted with the lock on the left side or the right side

The handles can be the key locked type or the non-key locked type and are supplied as a matched pair

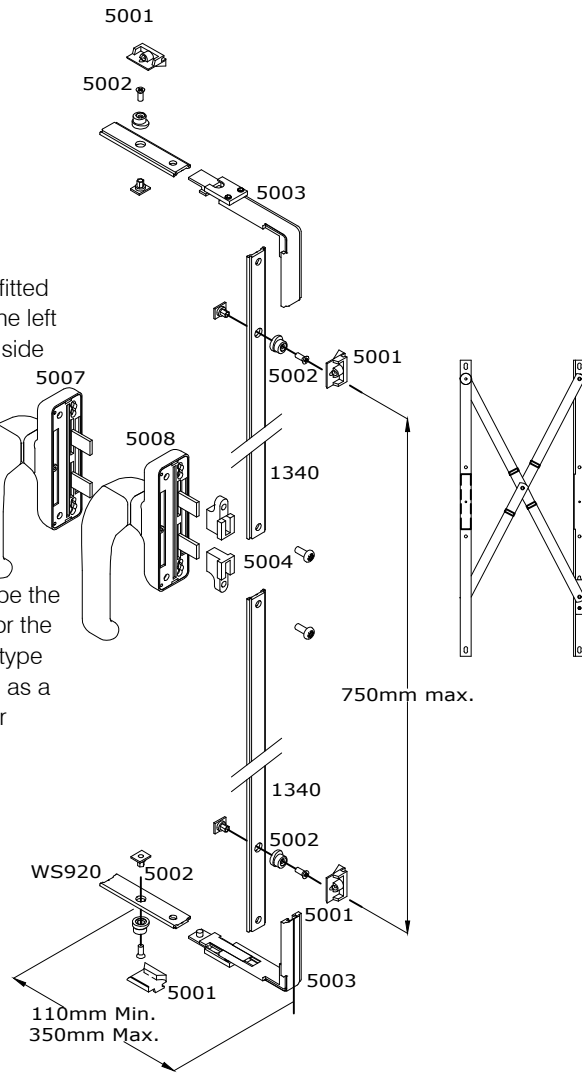
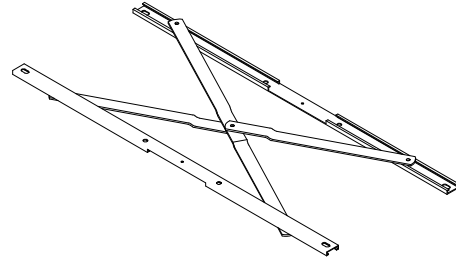

Copyright and ownership of this drawing is vested in EFT, Euro Facade Systems Ltd, whose prior written consent is required for its use, reproduction or for publication to any third party. All other rights reserved. Subject to modifications.

Parallel Hinge System  
Twin dual hinge locking

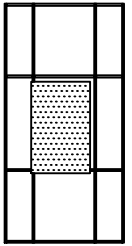

9.10

Copyright and ownership of this drawing is vested in EFT, Euro Facade Systems Ltd, whose prior written consent is required for its use, reproduction or for publication to any third party. All other rights reserved. Subject to modifications.

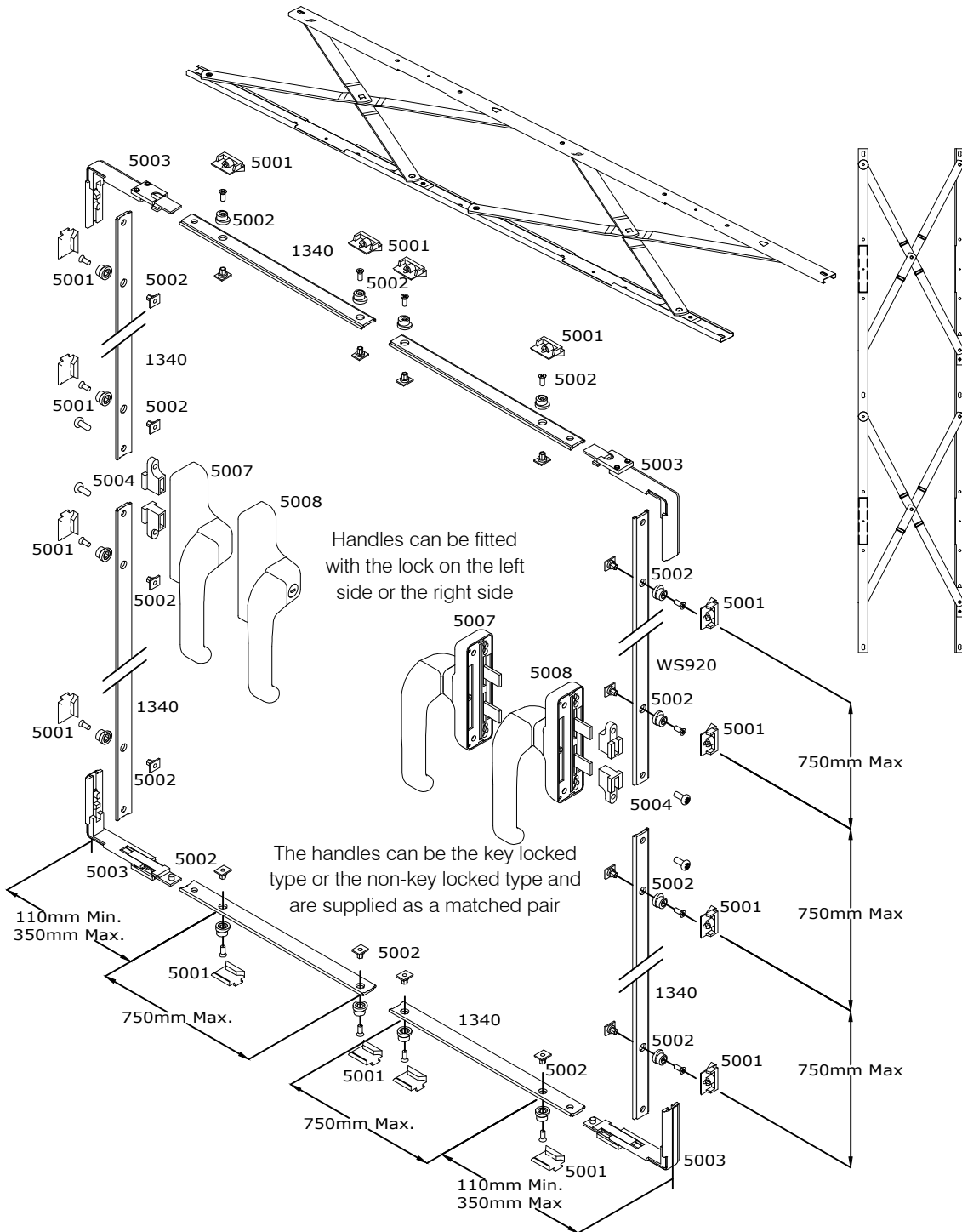

Changes reserved  
Sous reserve de modifications  
Änderungen vorbehalten

Issue:05  
Date: 02 -17

# Glazing charts

9

## Comar 6EFT

## Parallel Hinge System Glazing Chart - SG

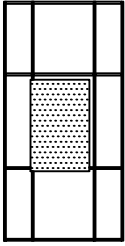

9.11

Fabricators Guide

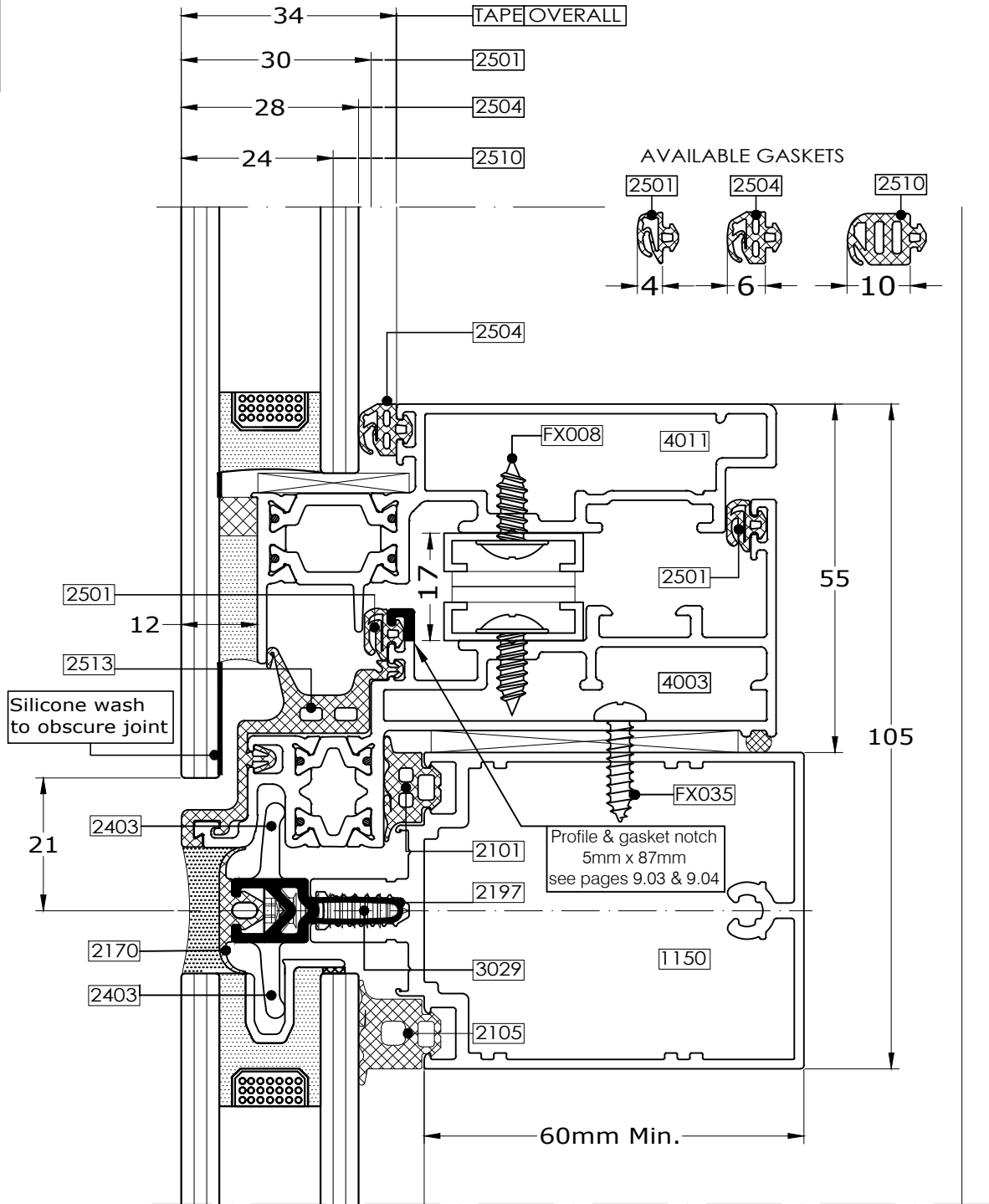

Copyright and ownership of this drawing is vested in EFT, Euro Facade Systems Ltd, whose prior written consent is required for its use, reproduction or for publication to any third party. All other rights reserved. Subject to modifications.

Parallel Hinge System  
Glazing chart - Capped

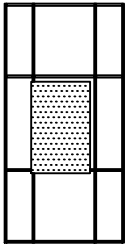

9.12

Copyright and ownership of this drawing is vested in EFT, Euro Facade Systems Ltd, whose prior written consent is required for its use, reproduction or for publication to any third party. All other rights reserved. Subject to modifications.

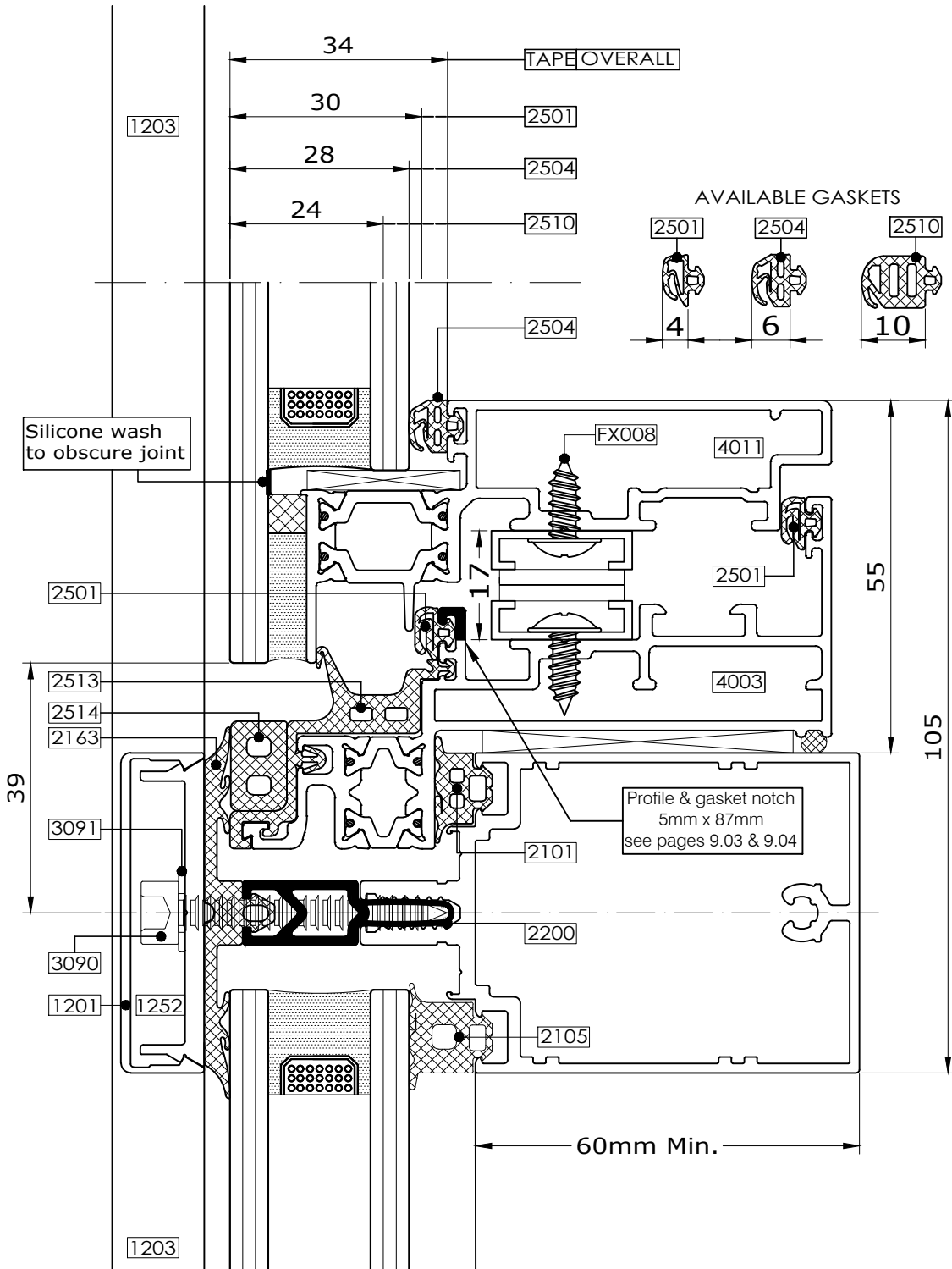

Changes reserved  
Sous reserve de modifications  
Änderungen vorbehalten

Issue:05  
Date: 02 -17

# Fabrication

# 9

## Comar 6EFT

## Parallel Hinge System Cutting sizes 4003 / 4011 - SG

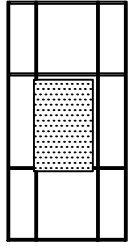

9.13

Fabricators Guide

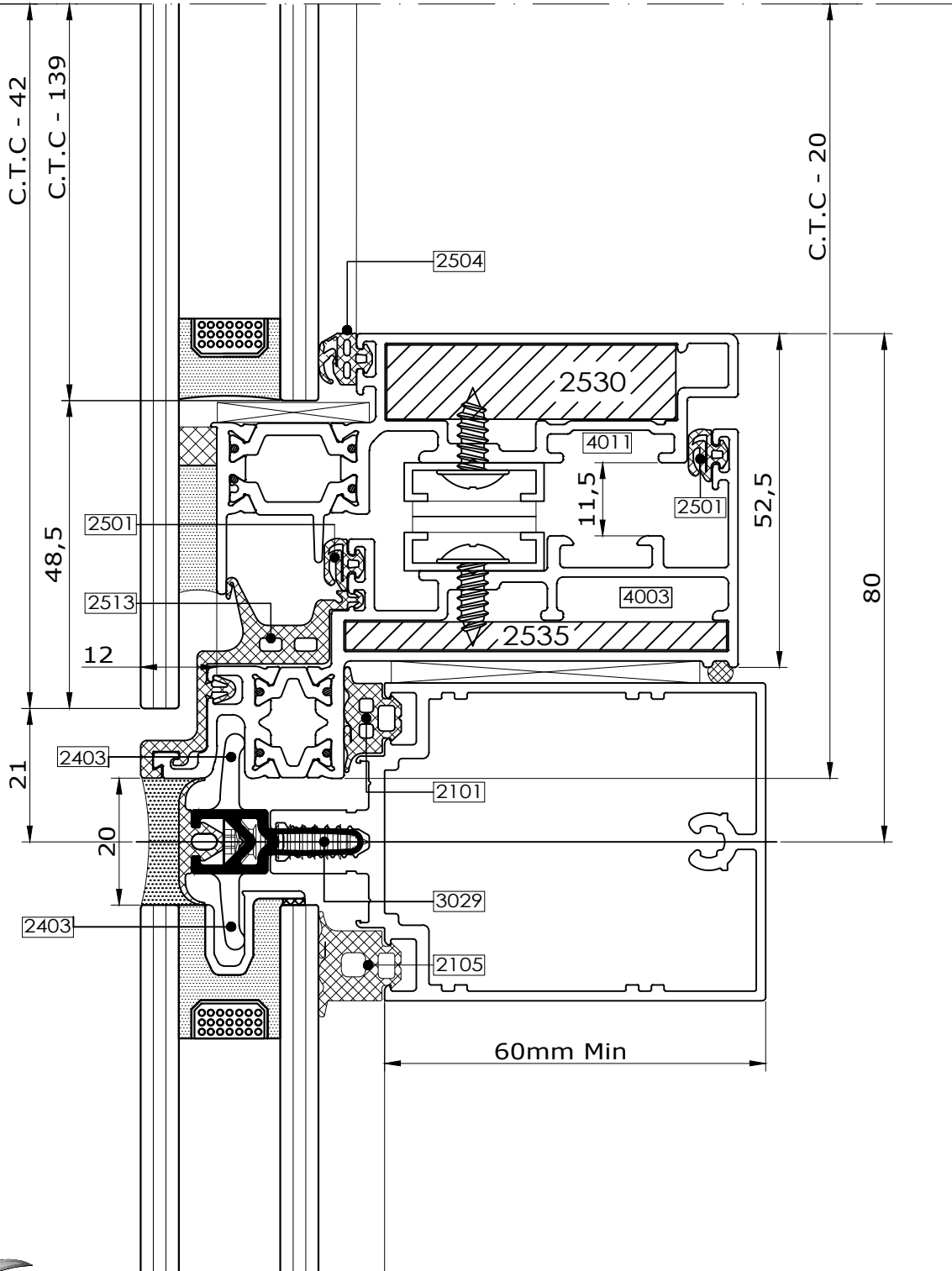

Copyright and ownership of this drawing is vested in EFT, Euro Facade Systems Ltd, whose prior written consent is required for its use, reproduction or for publication to any third party. All other rights reserved. Subject to modifications.



**comar**  
ARCHITECTURAL ALUMINIUM SYSTEMS

Changes reserved  
Sous reserve de modifications  
Änderungen vorbehalten

Issue: 05  
Date: 02 -17



# Parallel Hinge System

## Cutting sizes - 4003 / 4011 - Capped

Copyright and ownership of this drawing is vested in EFT, Euro Facade Systems Ltd, whose prior written consent is required for its use, reproduction or for publication to any third party. All other rights reserved. Subject to modifications.

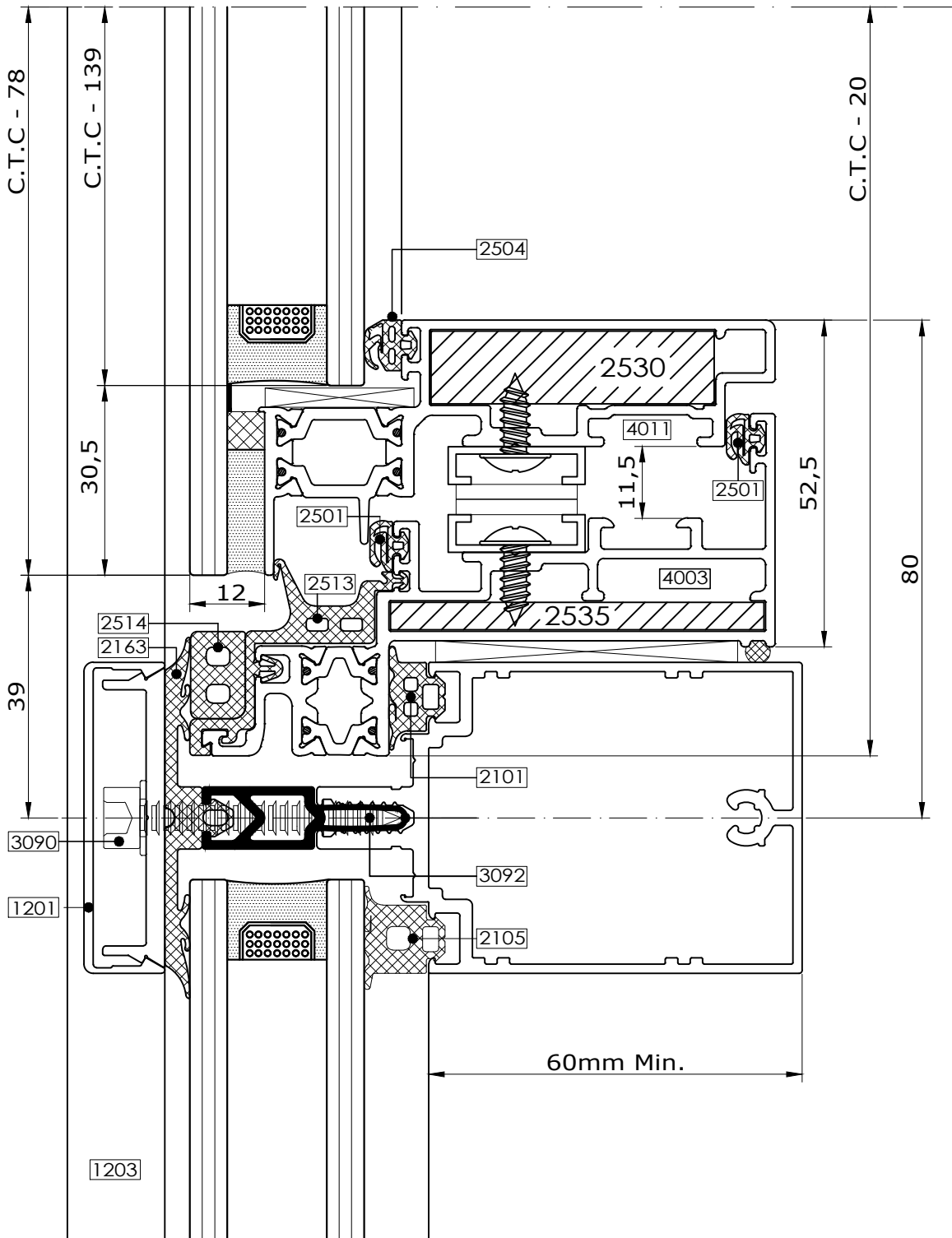

9.14

Fabricators Guide

Changes reserved  
Sous reserve de modifications  
Änderungen vorbehalten

Issue:05  
Date: 02 -17



**comar**  
ARCHITECTURAL ALUMINIUM SYSTEMS

Fabrication 9

Comar 6EFT

Parallel Hinge System  
Drainage & Ventilation

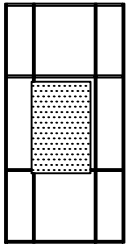

Drainage: Option 1

Drainage through frame chamber

- 1 - Drill 6mm hole
- 2 - Mill slot 5x15mm, cut gasket 15mm
- 3 - Mill upstands away 10mm
- 4 - Drill 8mm hole
- 5 - Drill 8mm hole

Ventilation

(pressure equalization)

- 6 - Cut gasket 2513- 20mm
- 7 - Cut gasket 2501- 20mm
- 8 - Drill 5mm hole
- 9 - Drill 5mm hole

9.15

Drainage: Option 2

Drainage flash at window sill

- 1 - Mill slot 5x15mm, cut gasket 2501- 15mm
- 2 - Cut gasket 2513- 15mm
- 3 - Mill upstands away 10mm
- 4 - Drill 8mm hole
- 5 - Drill 8mm hole

Note:

Drainage and ventilation preparation is the same for capped and non capped concealed vent

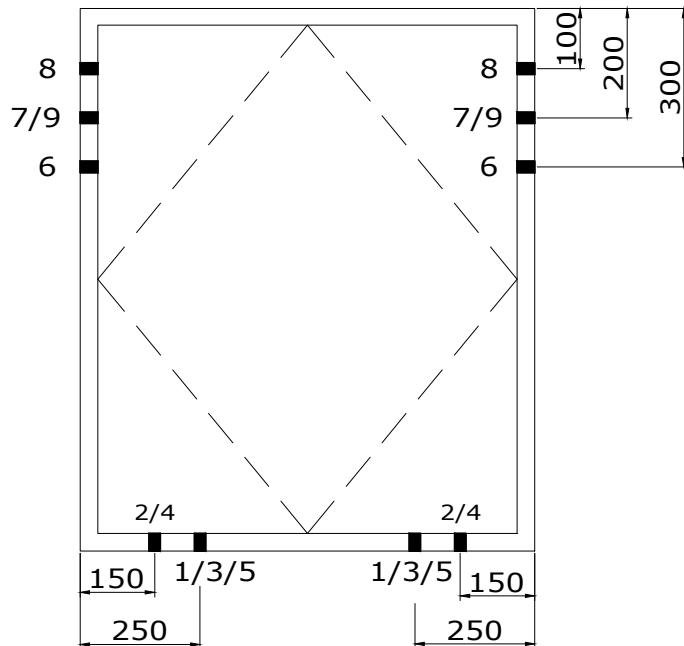

Copyright and ownership of this drawing is vested in EFT, Euro Facade Systems Ltd, whose prior written consent is required for its use, reproduction or for publication to any third party. All other rights reserved. Subject to modifications.

Copyright and ownership of this drawing is vested in EFT,  
Euro Facade Systems Ltd, whose prior written consent is required  
for its use, reproduction or for publication to any third party.  
All other rights reserved. Subject to modifications.

9

# Parallel Hinge System Drainage Option 1

Fabrication  
Comar 6EFT

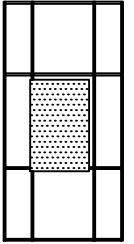

9.16

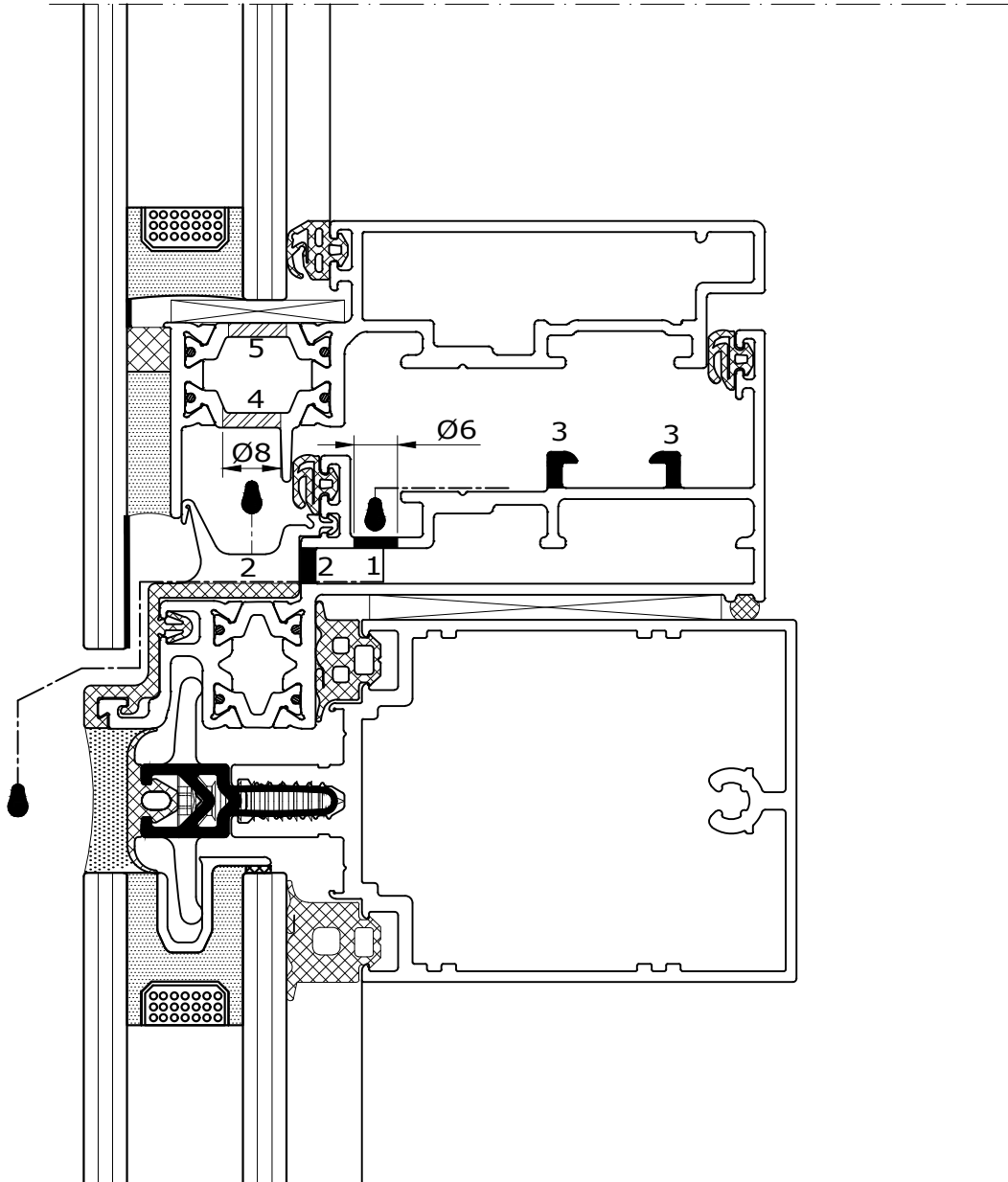

Fabricators Guide

Changes reserved  
Sous reserve de modifications  
Änderungen vorbehalten

Issue:05  
Date: 02 -17

Fabrication

9

Comar 6EFT

Parallel Hinge System  
Drainage Option 2

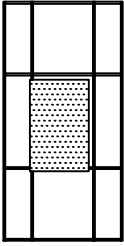

9.17

Fabricators Guide

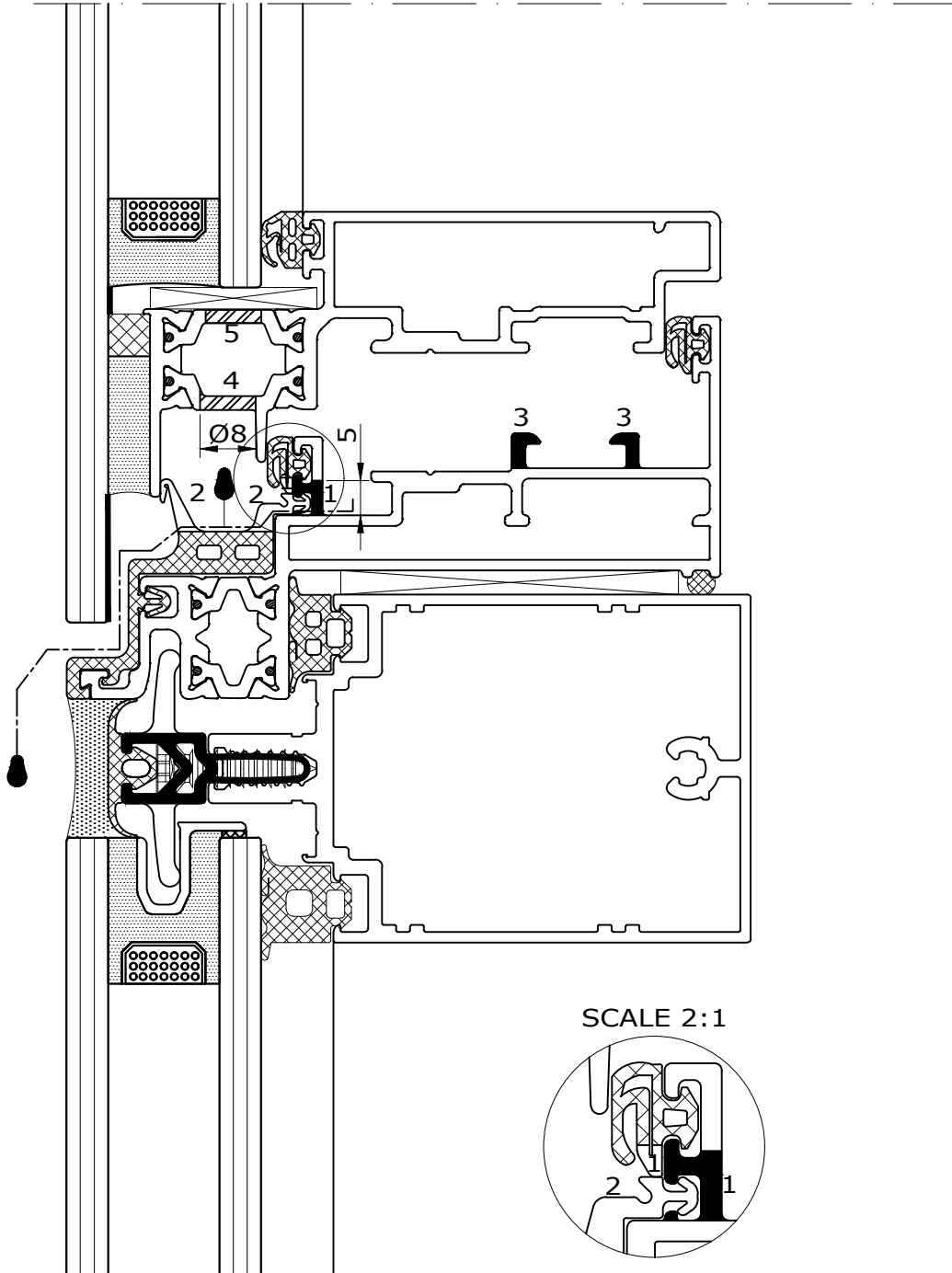

Copyright and ownership of this drawing is vested in EFT,  
Euro Facade Systems Ltd, whose prior written consent is required  
for its use, reproduction or for publication to any third party.  
All other rights reserved. Subject to modifications.

Copyright and ownership of this drawing is vested in EFT,  
Euro Facade Systems Ltd, whose prior written consent is required  
for its use, reproduction or for publication to any third party.  
All other rights reserved. Subject to modifications.

## Parallel Hinge System Ventilation

9

Fabrication  
Comar 6EFT

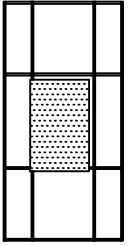

9.18

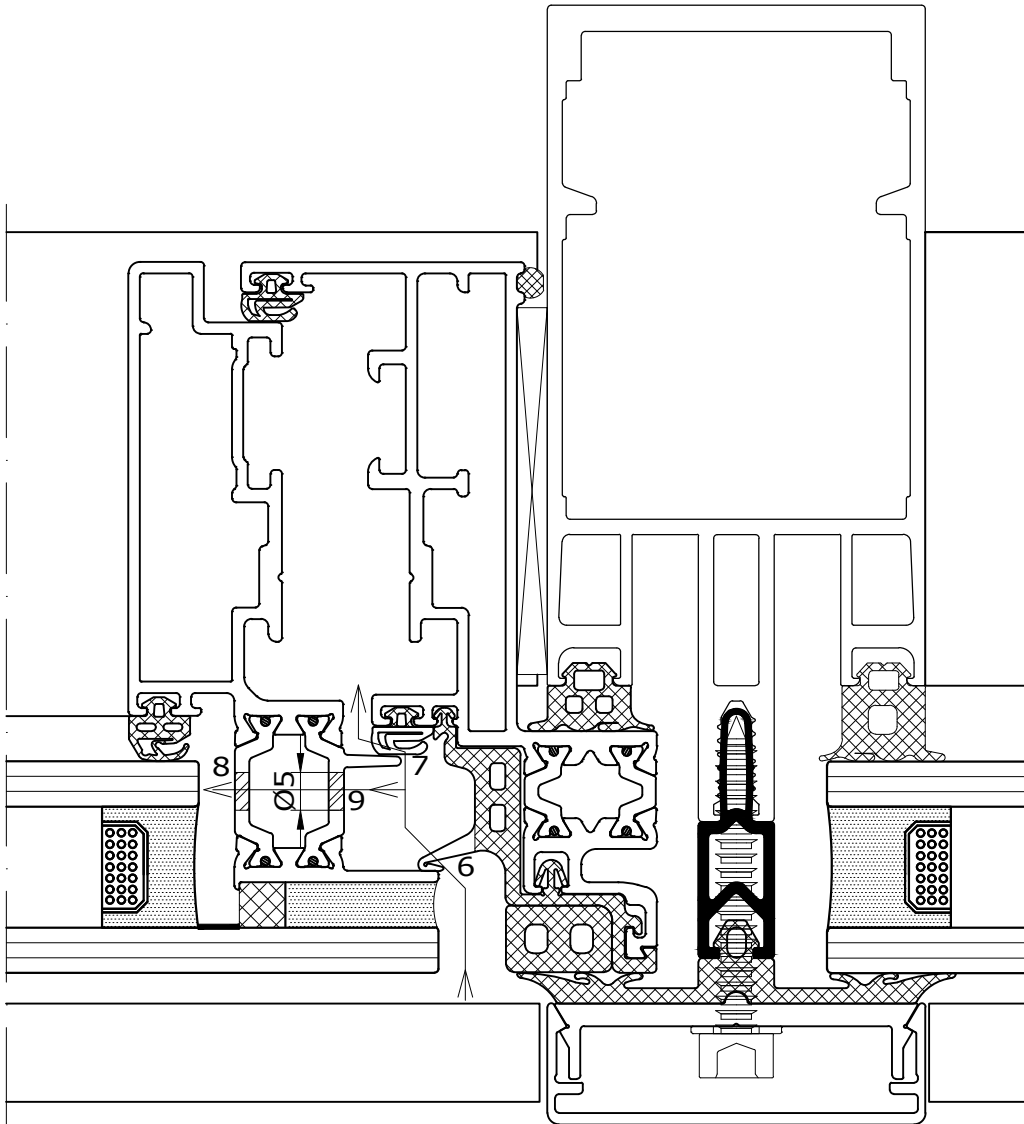

Fabricators Guide

Changes reserved  
Sous reserve de modifications  
Änderungen vorbehalten

Issue:05  
Date: 02 -17

Comar 6EFT

Parallel Hinge System  
Hardware Overview

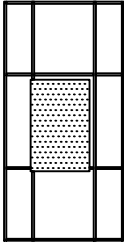

Part no.	Description	Locking	
		2 points	4 points
1340	Drive rods	see 8.81	see 8.81
5001	Curtain wall striker	2 of	4 of
5002	Adjustable pawl	2 of	4 of
5003	Corner cleat	0 of	2 of
5004	Connection block	1 of	1 of
5007	Handle - non locking	1 of	1 of
5008	Handle - locking	1 of	1 of

9.19

Fabricators Guide

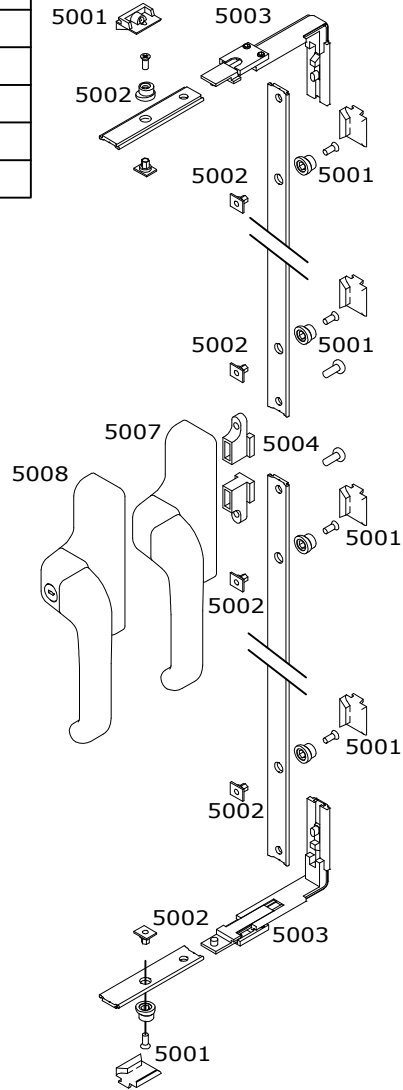
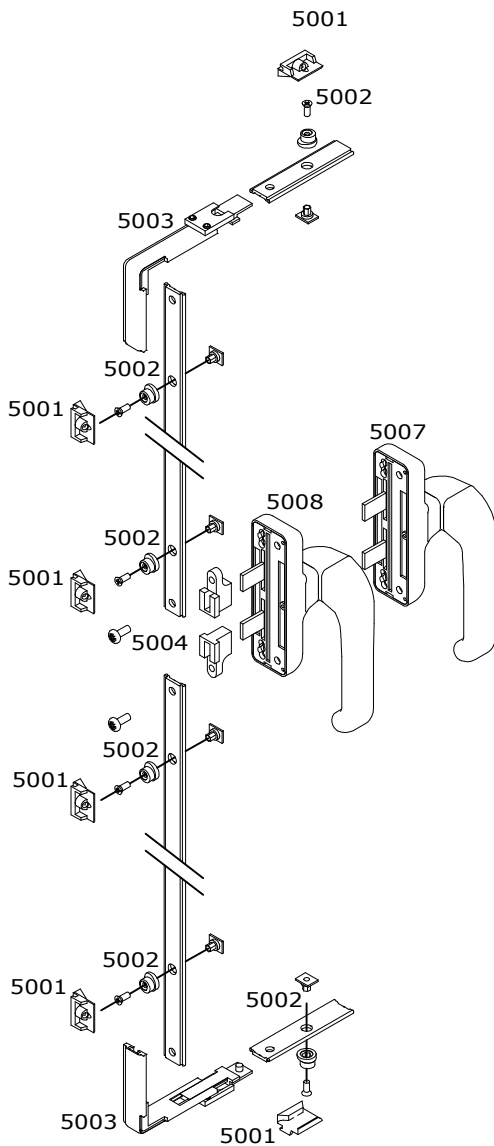

Copyright and ownership of this drawing is vested in EFT, Euro Facade Systems Ltd, whose prior written consent is required for its use, reproduction or for publication to any third party. All other rights reserved. Subject to modifications.

Parallel Hinge System  
Drive rod preparation

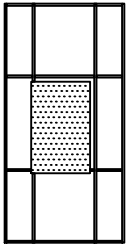

4 POINTS LOCKING: Rod lengths = window height - 124mm/2  
2 POINTS LOCKING: Rod lengths = window height - 79mm/2

Window width measured along bottom of channel

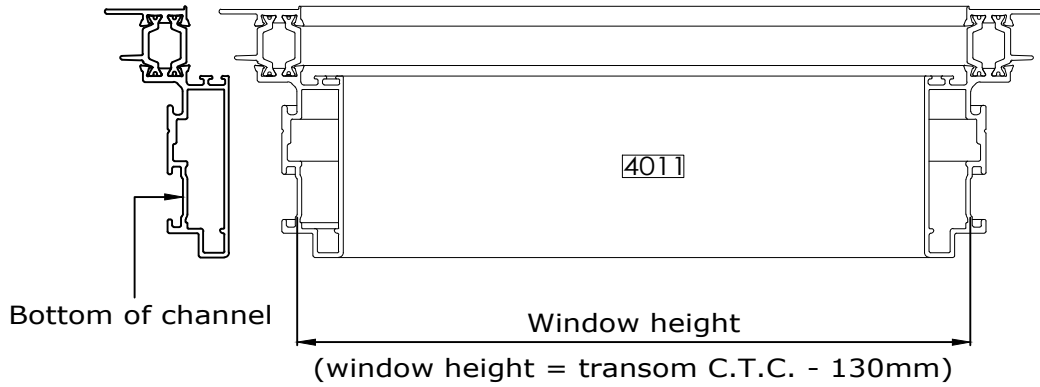

9.20

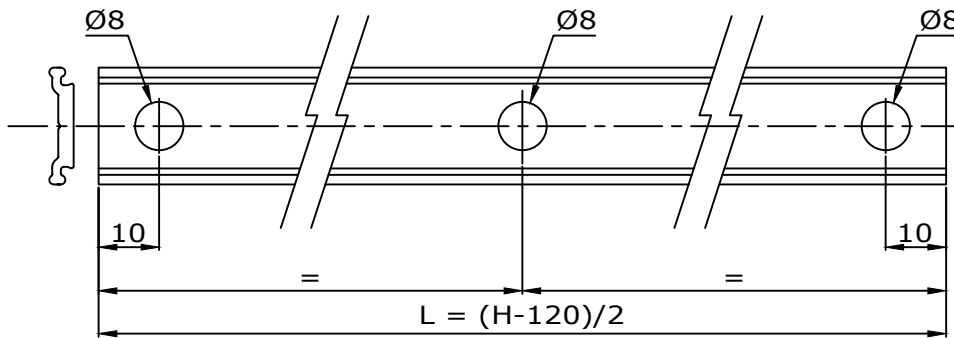

x2

"OR"

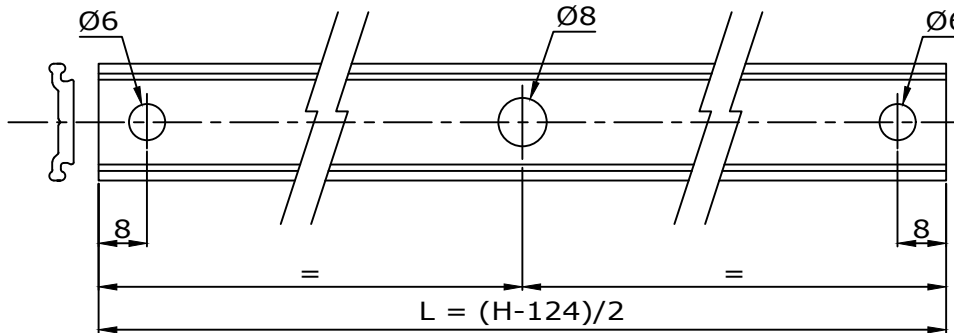

x2

Copyright and ownership of this drawing is vested in EFT, Euro Facade Systems Ltd, whose prior written consent is required for its use, reproduction or for publication to any third party. All other rights reserved.

Changes reserved  
Sous reserve de modifications  
Änderungen vorbehalten

Issue:05  
Date: 02 -17

Fabrication

9

Comar 6EFT

Parallel Hinge System  
Handle preparation

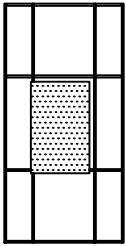

9.21

Fabricators Guide

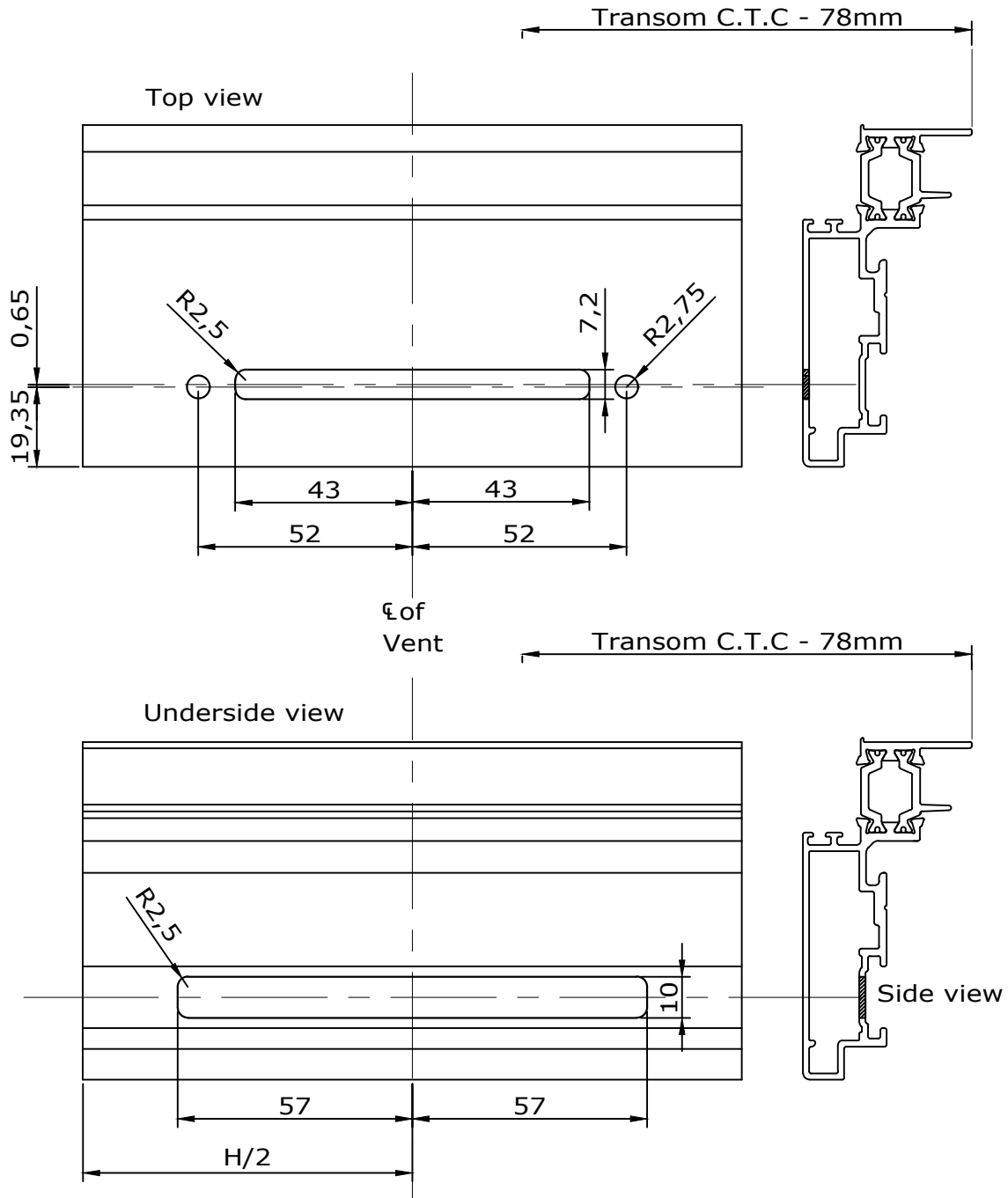

Copyright and ownership of this drawing is vested in EFT, Euro Facade Systems Ltd, whose prior written consent is required for its use, reproduction or for publication to any third party. All other rights reserved. Subject to modifications.





Copyright and ownership of this drawing is vested in EFT,  
Euro Facade Systems Ltd, whose prior written consent is required  
for its use, reproduction or for publication to any third party.  
All other rights reserved. Subject to modifications.

## Future Additions

9

Fabrication

Comar 6EFT

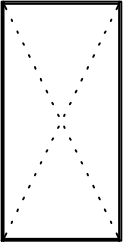

9.22-9.99

FUTURE  
ADDITION

Fabricators Guide

Changes reserved  
Sous reserve de modifications  
Änderungen vorbehalten

Issue: 05  
Date: 02 -17