

Technical Datasheet

NEW PROFILE CS776R 20MM DOUBLE GLAZING BEAD SUPERSEDES CS776

CS776R	
STOCK LENGTH mm	6450
QUANTITY PER CARTON	30
GROSS WEIGHT KGS.	39

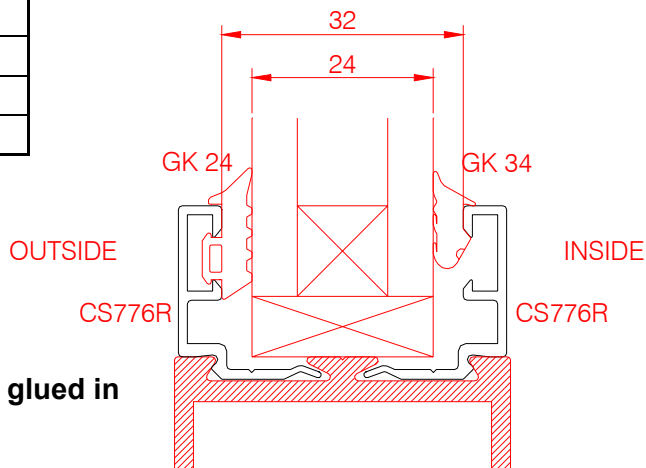

Outside bead can be screwed, riveted or glued in position for security purposes



Following reports from our customers that glazing 24mm units, using this profile, was sometimes difficult due to compounding tolerances, this profile has been changed to accept larger glass/panel sizes. When glazing 24mm units gaskets ref. GK24 (4mm) should be used to the outside and GK34 (4mm) should be used to the inside. Due to tolerances in aluminium, glass, gaskets and paint finishes the above gaskets should be tried in works and substituted with alternative sizes if necessary. For further details please contact the Comar Technical Department. Tel: 020 8685 9685 or email Technical@parksidegrp.co.uk

LIST PRICES PER UNIT LENGTH SHOWN IN £ .

PROFILE REF.	MILL FINISH	NAT. SILVER ANODISED	BRZ /BLACK ANODISED	HIPCA WHITE P.P.C	RAL COLOUR P.P.C
CS 776R	12.06	22.93	37.86	21.69	26.49

NOTE: PRICES SHOWN IN ITALICS DENOTE FINISHES NOT ALWAYS HELD IN STOCK AND MAY BE SUBJECT TO SPECIAL PRICE AND/OR DELIVERY. PRICES ARE CORRECT AT 1ST MARCH 2002



The Parkside Group Limited
Unit 5 The Willow Centre
17 Willow Lane
Mitcham Surrey CR4 4NX
Email
Technical@Parksidegrp.co.uk



SHEET	TD0013
CHECKED BY	SJJ
DATE	02.03.02